

MULTI-PURPOSE LID (W/DAMPER) AZ-GD With Lid / Key

SUS



- Soft-closes to prevent lid from slamming shut. Reduces noise and impact when lid closes.
- Integrated anti-pinching plates.
- For vertical use.
- Corrosion resistant.
- Possible to prohibit the use of lid by using key. Also suitable for transportation vehicles, etc. (Rattling may occur depending on vibration conditions.)
- With tamper-proof lock

[Specifications]

- Operating temperature: 0°C~40°C

[Remarks]

- Indoor use only.
- The closing speed varies depending on the operating temperature. For damper stored below the freezing point, leave it indoor above 0°C for several hours before use.
- Please contact a local representative when ordering additional keys.

[Sold Separately]

- Guide AZ-SLP 1

[Recommended Screws]

- Pan head tapping screw 3 x 4
- Pan head screw 3 x 4

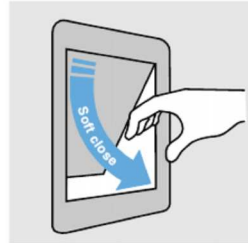

Video Link

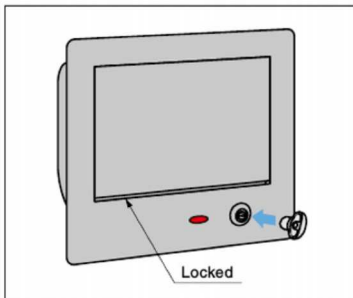

Can be locked which prevents flap from opening.

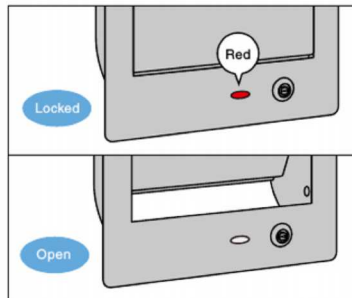

Indicator shows red when locked.



Recommended for use in public transportation like trains.

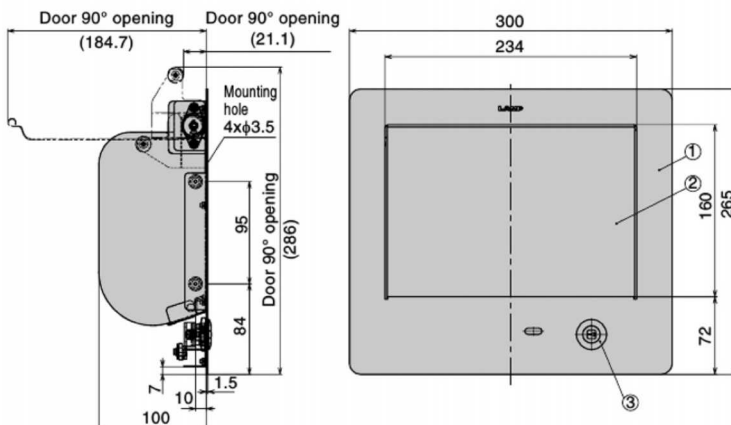

[Cut Out Dimensions]

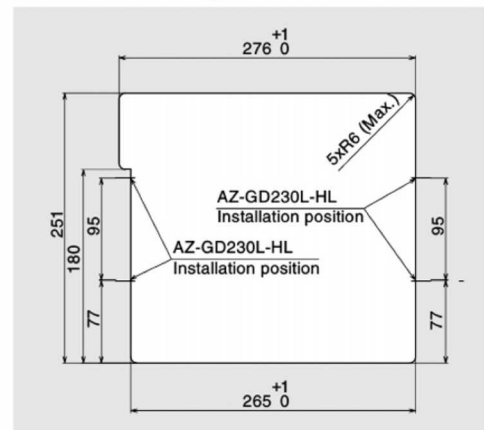

| RoHS | CAD | Item Code | Item Name | Material | Finish | Weight (g) | Box (pcs) | Carton (pcs) |
|------|-----|-------------|--------------|--------------------------|--------|------------|-----------|--------------|
| G | 30 | 210-037-892 | AZ-GD230L-HL | Stainless Steel (SUS304) | Satin | 1950 | 1 | 6 |

Refer to 1: P.988

MULTI-PURPOSE LID AZ-GD With Damper

INSTRUCTION

SUS

AZ-GD180-HL
(Slim Frame)

AZ-GD230-HL



AZ-GD310-HL

AZ-GD400-HL
(Slim Frame)

AZ-GD230-BL



AZ-GD310-BL

- With damper to keep lid from slamming shut.
- Integrated anti-pinching plates.
- For vertical use only.
- Corrosion resistant.
- Back mount type **1** and inclined mount type **2** of the same shape also available.
- Guide (sold separately) **3** for guiding rubbish into waste box inside also available.

[Specifications]

- Operating temperature: 0°C~40°C

[Remarks]

- Indoor use only.
- The closing speed varies depending on the operating temperature. For product stored below the freezing point, leave it indoor above 0°C for several hours before use.

[Sold Separately]

- Guide AZ-SLP **3**

Video Link

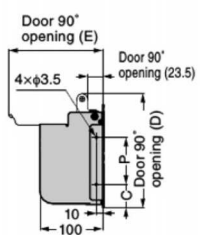
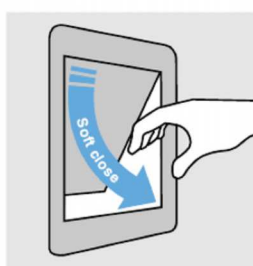

AZ-GD180-HL

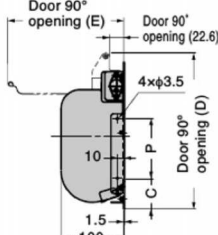
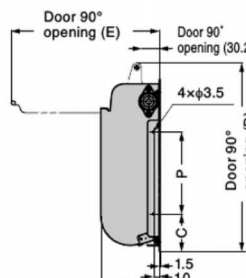
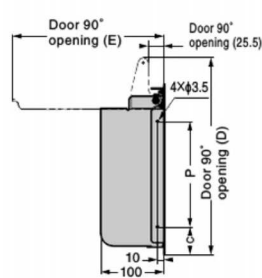
AZ-GD230-HL
AZ-GD230-BLAZ-GD310-HL
AZ-GD310-BL

AZ-GD400-HL

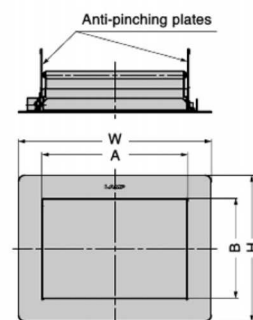

[Cut Out Dimensions]

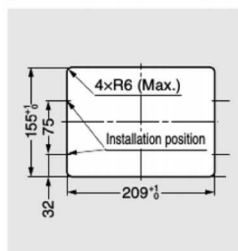

AZ-GD180-HL

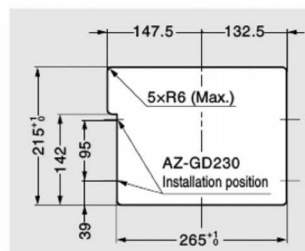
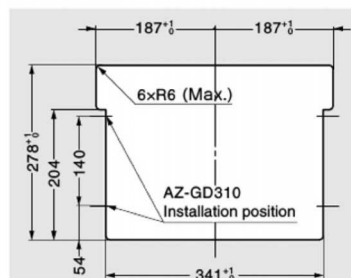
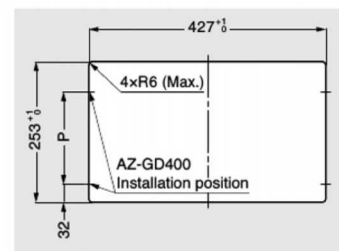
AZ-GD230-HL
AZ-GD230-BLAZ-GD310-HL
AZ-GD310-BL

AZ-GD400-HL

| RoHS | CAD | Item Code | Item Name | Material | Finish | A | B | W | H | C | D | E | P | Weight (g) |
|------|-----|-------------|-------------|-----------------------------|--------|-----|-----|-----|-----|----|-----|-------|-----|------------|
| | | 210-033-487 | AZ-GD180-HL | Stainless Steel (SUS304) | Satin | 182 | 128 | 218 | 164 | 37 | 182 | 149.5 | 75 | 1042 |
| | | 210-017-089 | AZ-GD230-HL | | Black | 234 | 160 | 308 | 234 | 49 | 249 | 184.7 | 95 | 1486 |
| | | 210-055-318 | AZ-GD230-BL | | | 310 | 220 | 384 | 294 | 64 | 322 | 253.4 | 140 | 2236 |
| | | 210-022-110 | AZ-GD310-HL | | Satin | 400 | | 450 | 270 | 44 | 312 | 240.5 | 167 | 2236 |
| | | 210-055-319 | AZ-GD310-BL | | Black | | | | | | | | | |
| | | 210-041-314 | AZ-GD400-HL | | Satin | | | | | | | | | |

Refer to **1** **2** : P.987, **3** : P.988

MULTI-PURPOSE LID (W/DAMPER) AZ-GD231-HL With Lid Back Mount Type

INSTRUCTION

SUS



Soft close
"Smooth and soft closing"

- Installed from inside the waste box for clean appearance.
- With damper to keep lid from slamming shut.
- Integrated anti-pinching plates.
- Corrosion resistant.
- Guide (sold separately) 1 for guiding rubbish into waste box inside also available.

[Specifications]

- Operating temperature: 0°C~40°C

[Remarks]

- Indoor use only.
- The closing speed varies depending on the operating temperature. For product stored below the freezing point, leave it indoor above 0°C for several hours before use.

[Sold Separately]

- Guide AZ-SLP 1

[Application Example]

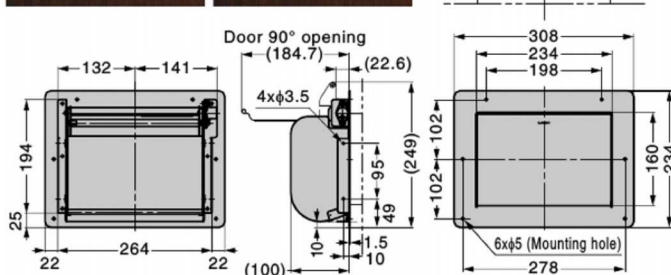

[Cut Out Dimensions]

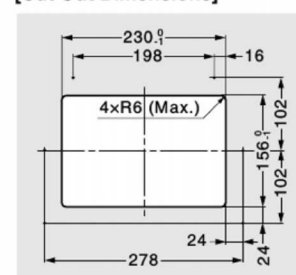

| RoHS | CAD | Item Code | Item Name | Material | Finish | Weight (g) | Box (pcs) | Carton (pcs) |
|------|-----|-------------|-------------|--------------------------|--------|------------|-----------|--------------|
| G | 3D | 210-027-508 | AZ-GD231-HL | Stainless Steel (SUS304) | Satin | 1486 | 1 | 10 |

Refer to 1 : P.988

BEARINGS

SWIVELS

MULTI-PURPOSE LIDS

VENTILATORS

MULTI-PURPOSE CAPS

GROMMETS

CABLE GROMMETS

GASKET

BELT REEL PARTITION

MULTI-PURPOSE LID (W/DAMPER) AZ-GD232-HL With Lid / Inclined Mount Type

INSTRUCTION

SUS



Soft close
"Smooth and soft closing"

Inclined mount

- Able to install the lid up to 45°.
- Inclined mount allows putting into rubbish easily.
- Easy to adjust angle just by changing weight position.
- With damper to keep lid from slamming shut.
- Integrated anti-pinching plates.
- Corrosion resistant.
- Guide (sold separately) 1 for guiding rubbish into waste box inside also available.

[Specifications]

- Operating temperature: 0°C~40°C

[Remarks]

- Indoor use only.
- The closing speed varies depending on the operating temperature. For product stored below the freezing point, leave it indoor above 0°C for several hours before use.

[Sold Separately]

- Guide AZ-SLP 1

[Installation]

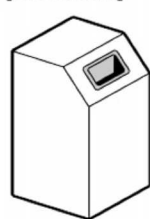

[How to Adjust Angle]

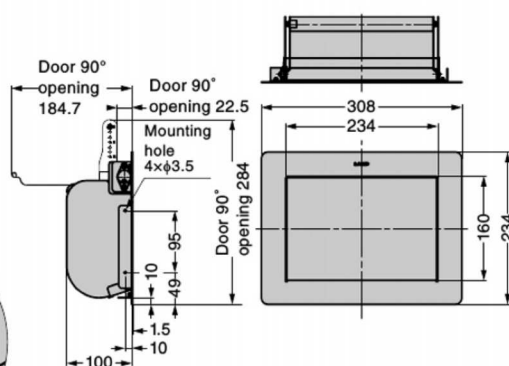
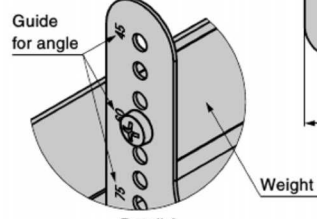
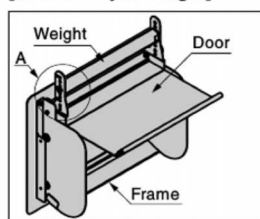

[Cut Out Dimensions]

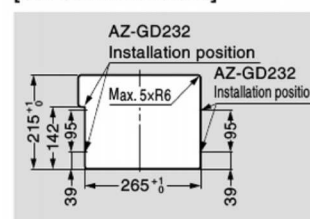

| RoHS | CAD | Item Code | Item Name | Material | Finish | Weight (g) | Box (pcs) | Carton (pcs) |
|------|-----|-------------|-------------|--------------------------|--------|------------|-----------|--------------|
| G | 3D | 210-032-975 | AZ-GD232-HL | Stainless Steel (SUS304) | Satin | 2200 | 1 | 10 |

Refer to 1 : P.988

GLASS POINT FIX

OTHERS

LED LIGHTS