



# P7 AdvancedMC<sup>®</sup> Inject / Eject Mechanism

## Module handle & light pipe bracket panel preparation

- Die-cast construction for robust performance
- Handle operation controls hot swap activation
- Handle retention feature prevents accidental operation
- For use with Carriers supporting 4 Full-size AMC Modules

### Material and Finish

Handle: Zinc alloy, black chrome  
 Lever: Zinc alloy, bright chromate  
 Pivot screw, Drag spring: Steel, zinc plated  
 Shoulder screw, U-bent washer: Stainless steel, passivated

### Performance Details

Flammability rating: UL94-V0

### Installation Notes

See page 492

Upper Handle Assembly

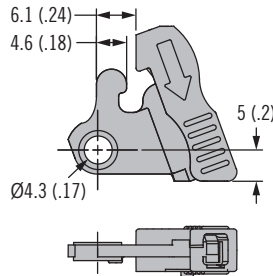

Lower Handle Assembly

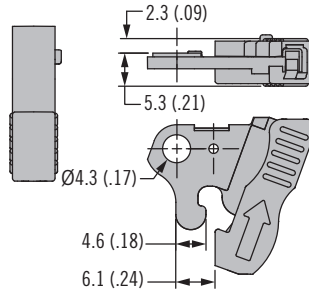

Switch Arm

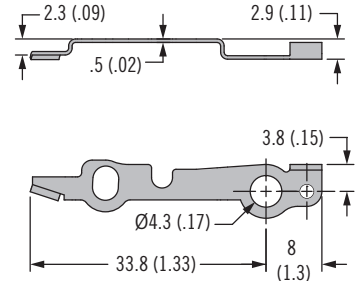

Pivot Screw (2 supplied)

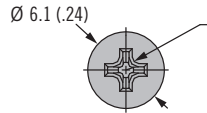

Shoulder Screw (supplied)

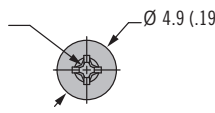

U-Bent Washer (2 supplied)

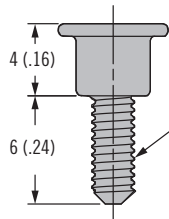
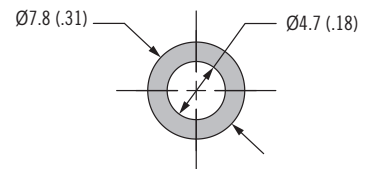

M 2.5 WITH TORQUE RESISTANT PATCH

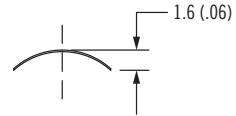
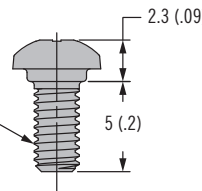

Part Number
P7-C-701
Part Number includes Upper and Lower Handle Assemblies, Switch Arm, Pivot Screws, Shoulder Screw and U-Bent Washers as shown

### Panel Preparation

#### Upper handle location

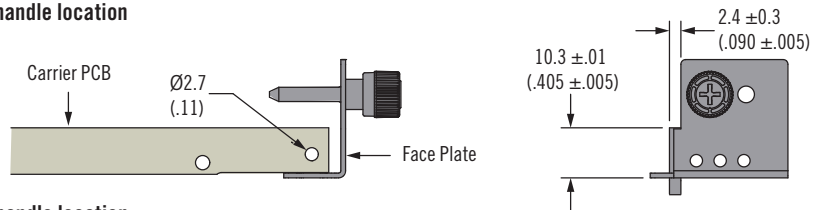

#### Lower handle location

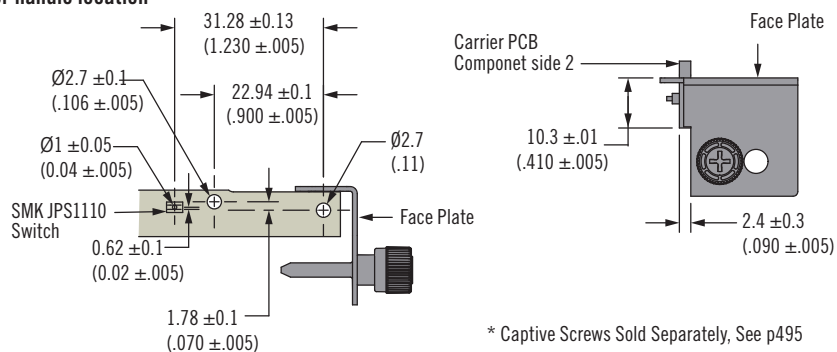

\* Captive Screws Sold Separately, See p495

AdvancedMC is a registered trademark of PICMG<sup>®</sup> - PCI Industrial Computer Manufacturers Group, Inc.

Other options available. For complete details on variety, part numbers, installation and specification, go to



[www.southco.com/P7](http://www.southco.com/P7)

Dimensions in millimeters (inch) unless otherwise stated



# P7 AdvancedMC<sup>®</sup> Inject / Eject Mechanism

## Installation and operation

501B

### Installation

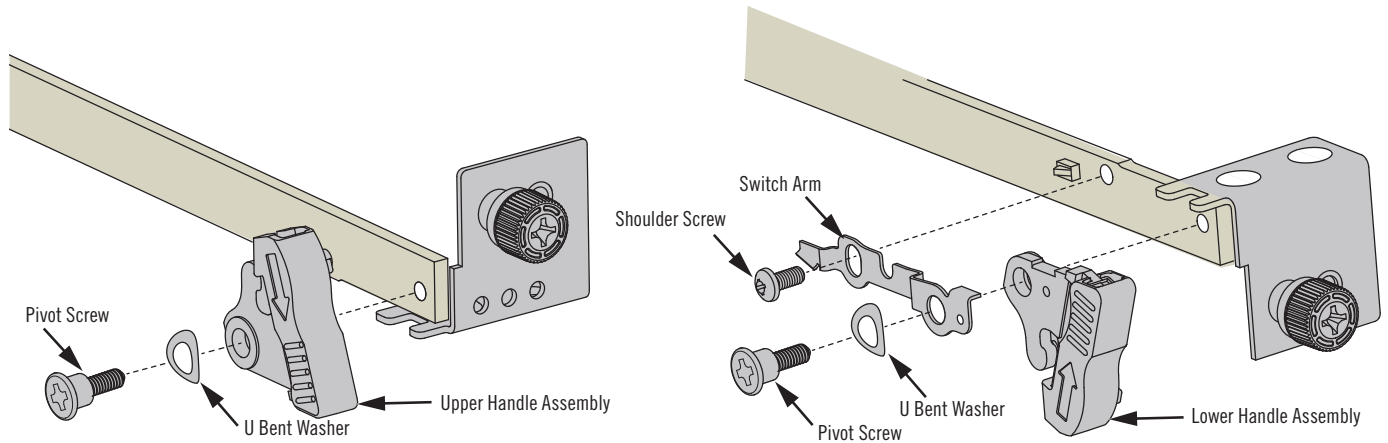

Tap M2.5 Threads into Carrier (not shown) to accept Pivot Screw and Shoulder Screw  
Tighten screws to 45-60N-cm

### Operation

Handle stowed, carrier inserted, Hot swap switch activated

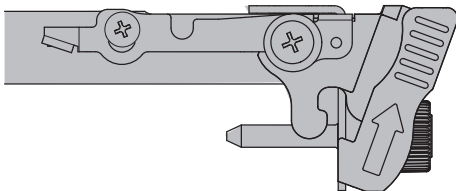

Handle extended, carrier inserted, Hot swap switch activated

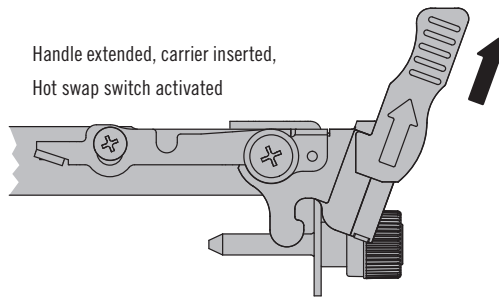

Handle extended, carrier inserted, Hot swap switch de-activated

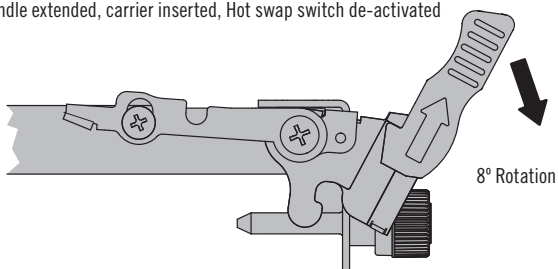

Handle extended, carrier extracted, Hot swap switch de-activated

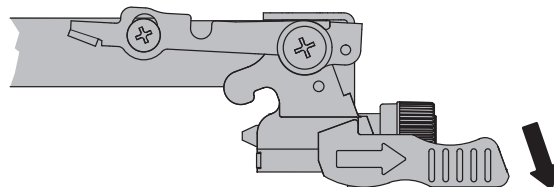

AdvancedMC is a registered trademark of PICMG<sup>®</sup> - PCI Industrial Computer Manufacturers Group, Inc.