

N2 Compression Latch

Lift & turn series · Folding T-handle · Flush cup style · Adjustable grip

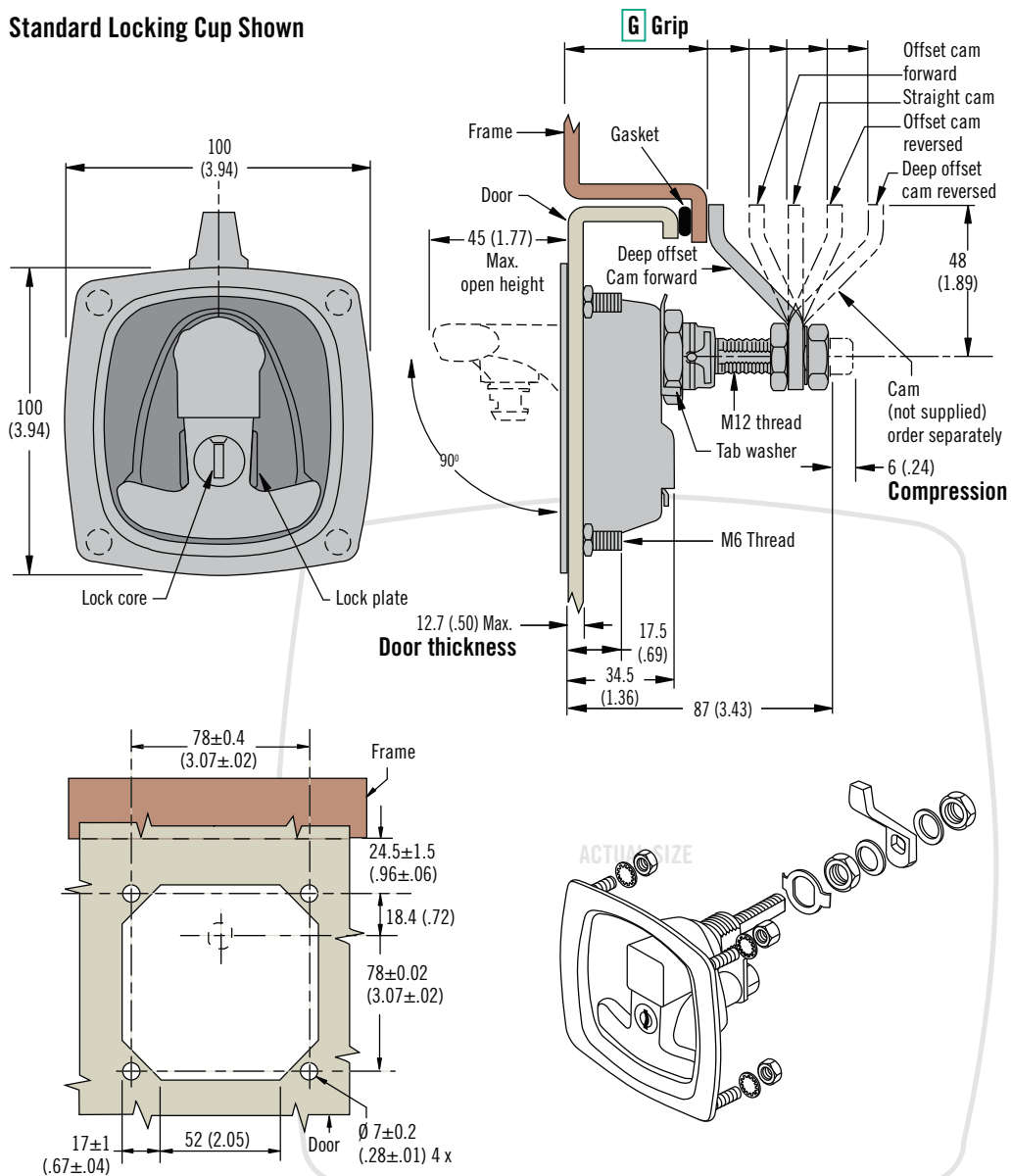

Standard Locking Cup Shown



- Heavy-duty performance
- Flush profile when latched
- Easy grip adjustment
- Intuitive operation

Material and Finish

Stainless steel, aluminum, black powder coated and plated steel

Performance Details

Max. static load: 1000 N (225 lbf)

Installation Notes

1. Insert latch and tighten 4 mounting nuts.
2. With latch in closed position, adjust jam nuts to position cam at correct grip.
Max. tightening torque: 20 N·m (177 in·lbf)

Notes

N2 product family:
See next page for details

- L** Locking style ←
- 0 Non-locking
 - 1 Key-locking keyed alike CH751 (2 keys supplied)

Latch part number (no cam)

N2 - 2 - 30 L - 01 - 5

Cam Part Number Table (order separately)

Part Number	G Grip		Cam Type
	Min.	Max.	
N2-21-101-12	28 (1.10)	43 (1.69)	Deep offset cam, forward
	88 (3.46)	104 (4.09)	Deep offset cam, reversed
N2-21-102-12	43 (1.69)	58 (2.28)	Offset cam, forward
	73 (2.87)	88 (3.46)	Offset cam, reversed
N2-21-103-12	58 (2.28)	73 (2.87)	Straight

Part Number Selection

Order both parts separately

Choose latch body style

Choose cam (see table)

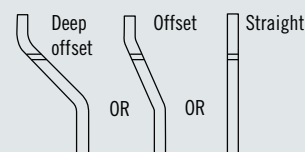

Other options available. For complete details on variety, part numbers, installation and specification, go to

INFO CLIC www.southco.com/N2



N2 Compression Latch

Lift & turn series · Folding T-handle · No cup style · Adjustable grip



- Heavy-duty performance
- Low profile when latched
- Easy grip adjustment
- Intuitive operation

Material and Finish

Stainless steel, aluminum, black powder coated and plated steel

Performance Details

Max. static load: 1000 N (225 lbf)

Installation Notes

1. Insert latch and tighten mounting nut.
2. Bend tab washer over mounting nut.
3. With latch in closed position, adjust jam nuts to position cam at correct grip. Max. tightening torque: 20 N·m (177 in·lbf)

Part Number Selection

Order both parts separately

Choose latch body style

Choose cam (see table)

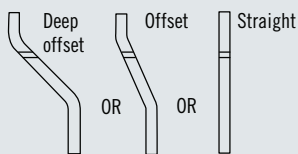

Locking Shown

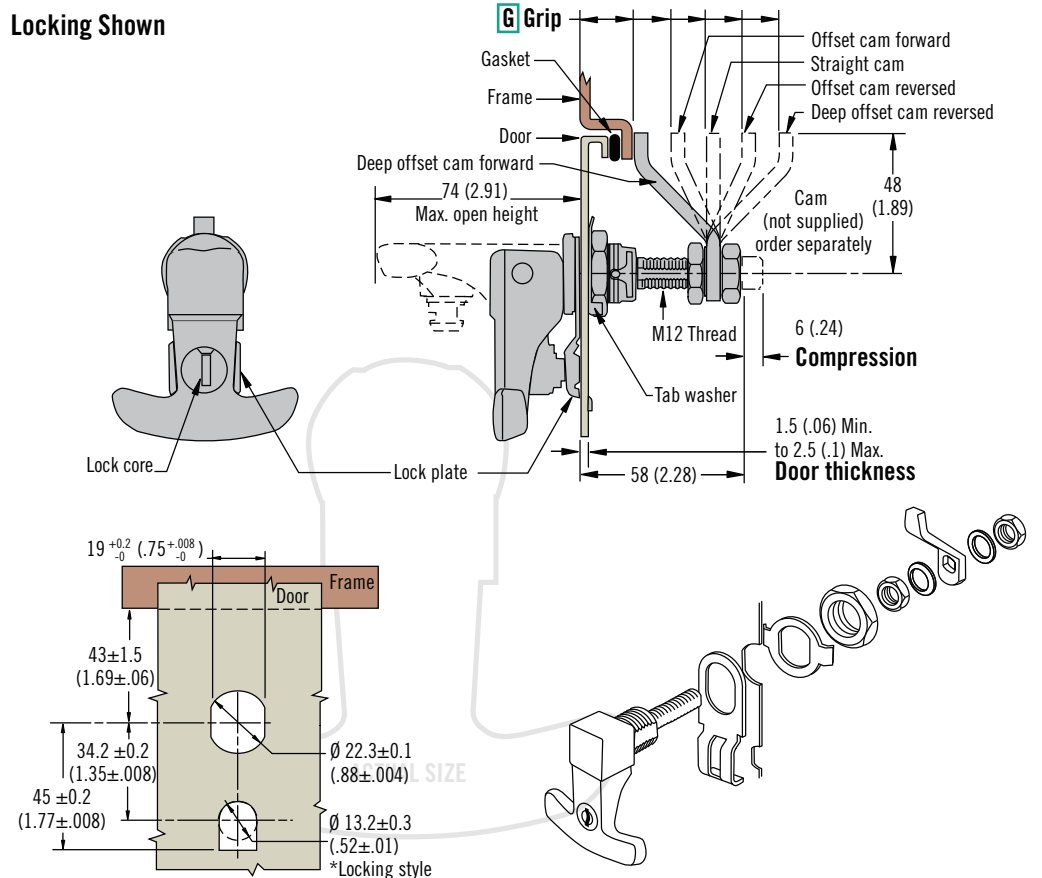

- L** Locking style
- 0 Non-locking
 - 1 Key-locking keyed alike CH751 (2 keys supplied)

Latch part number (no cam)

N2 - 2 - 10 L - 01 - 5

Cam Part Number Table (order separately)			
Part Number	Grip		Cam Type
	Min.	Max.	
N2-21-101-12	2.5 (.10)	15 (.59)	Deep offset cam, forward
	60 (2.36)	75 (2.95)	Deep offset cam, reversed
N2-21-102-12	15 (.59)	30 (1.18)	Offset cam, forward
	45 (1.77)	60 (2.36)	Offset cam, reversed
N2-21-103-12	30 (1.18)	45 (1.77)	Straight

Notes

Other styles available
Custom colors and keycodes
Contact Southco for details

N2 Product Family

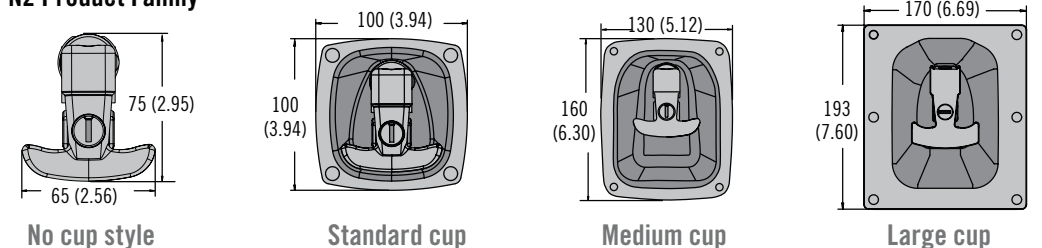

Dimensions in millimeters (inch) unless otherwise stated

Other options available. For complete details on variety, part numbers, installation and specification, go to

INFO CLIC www.southco.com/N2

© Southco-N2-11-08

southco
CONNECT · CREATE · INNOVATE



N2 Compression Latch

Lift & turn series · Folding T-handle · Medium flush cup style · Adjustable grip

- Heavy-duty performance
- Flush profile when latched
- Easy grip adjustment
- Ergonomic and intuitive operation

Material and Finish

Stainless steel, aluminum, black powder coated and plated steel

Performance Details

Max. static load: 1000 N (225 lbf)

Installation Notes

1. Insert latch and tighten 4 M6 mounting nuts. Max. tightening torque 7.2 N·m (63.7 in·lbf)
2. With latch in closed position, adjust M12 lock nuts to position cam at correct grip. Max. tightening torque: 20 N·m (177 in·lbf)

Key Part Numbers

Overmolded key CH751:

Single: PK-10-10-05

Pair: PK-10-01-05

Flat key

Pair: PK-10-01

Custom keys available. Contact Southco for details

Medium Locking Cup Shown

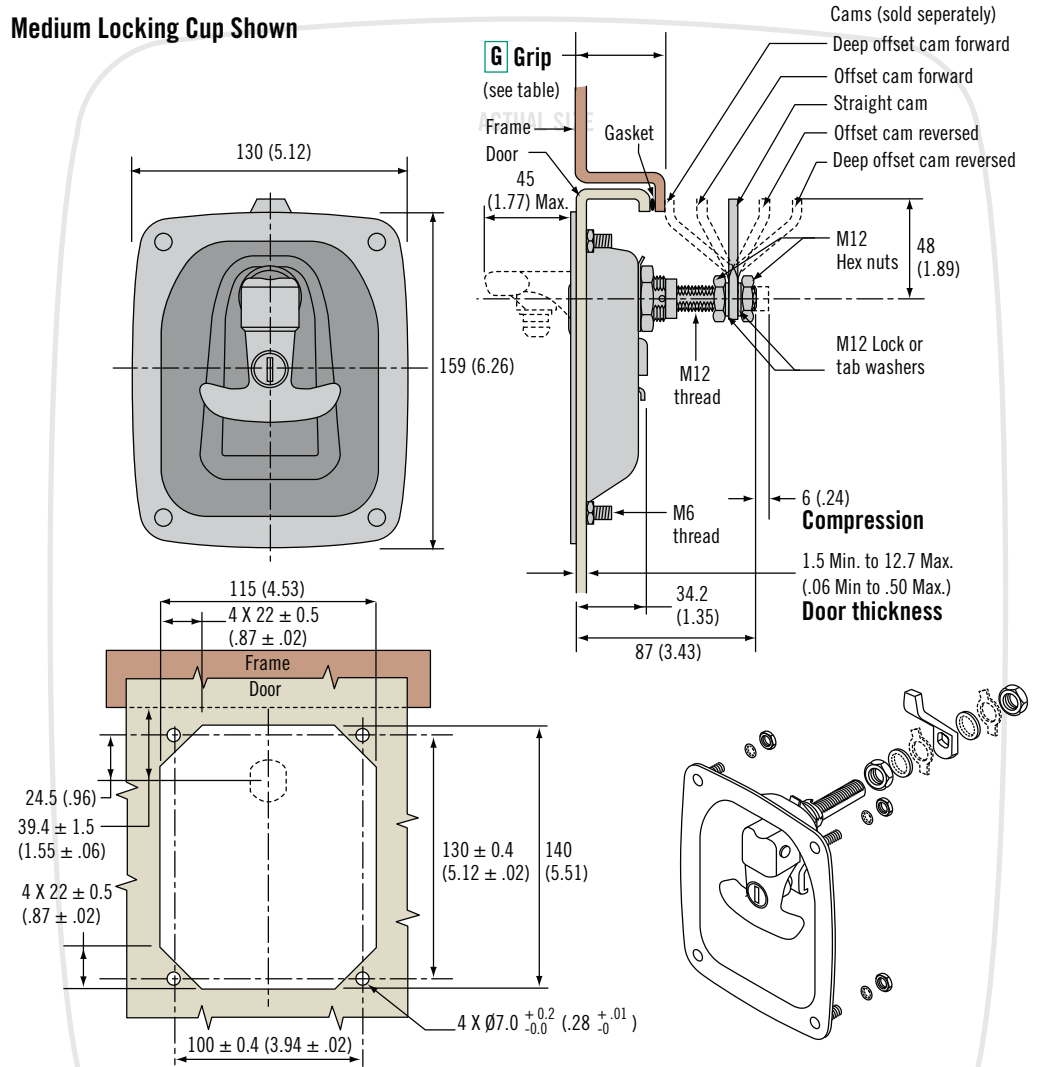

Overmolded Keys

Key CH751



Flat Keys

Key CH751



Part Number Selection

Order both parts separately

Choose latch body style

Choose cam (see table)

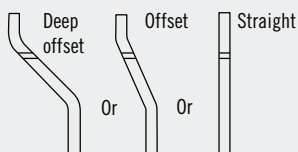

Cam Part Number Table (order separately)			
Part Number	G Grip		Cam Type
	Min.	Max.	
N2-21-101-12	28 (1.10)	43 (1.69)	Deep offset cam, forward
	88 (3.46)	104 (4.09)	Deep offset cam, reversed
N2-21-102-12	43 (1.69)	58 (2.28)	Offset cam, forward
	73 (2.87)	88 (3.46)	Offset cam, reversed
N2-21-103-12	58 (2.28)	73 (2.87)	Straight

L Locking style

- 0 Non-locking
- 1 Key-locking keyed alike CH751 (2 flat keys supplied)

Latch part number (no cam)

N2 - 2 - 50 L - 01 - 5

Dimensions in millimeters (inch) unless otherwise stated

Global Corporate Headquarters and Americas Customer Service & Technical Support Center
Concordville, PA – USA · Tel: (1) 610-459-4000 · Fax: (1) 610-459-4012

southco
CONNECT · CREATE · INNOVATE

INFO CLIC www.southco.com/N2

Southco® N2 MED NA 11-09



N2 Compression Latch

Lift & turn series · Stainless Steel · Folding T-handle
Flush cup style · Adjustable grip

- Heavy-duty performance
- Flush profile when latched
- Easy grip adjustment
- Intuitive operation

Material and Finish

Stainless steel

Performance Details

Max. static load: 1800 N (405 lbf)

Installation Notes

1. Insert latch and tighten 4 mounting nuts.
2. With latch in closed position, adjust jam nuts to position cam at correct grip.
Recommended tightening torque: 20-25 N·m (177-221 in·lbf)
3. If using M12 cam tab washer, after cam is adjusted to correct grip, bend both tabs over the M12 nut.

Keys

Key-locking keyed alike
CH751 (2 keys supplied)



Part Number Selection

Order both parts separately

Choose latch body style

Choose cam (see table)

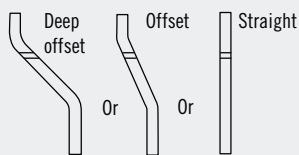

Standard Locking Cup Shown

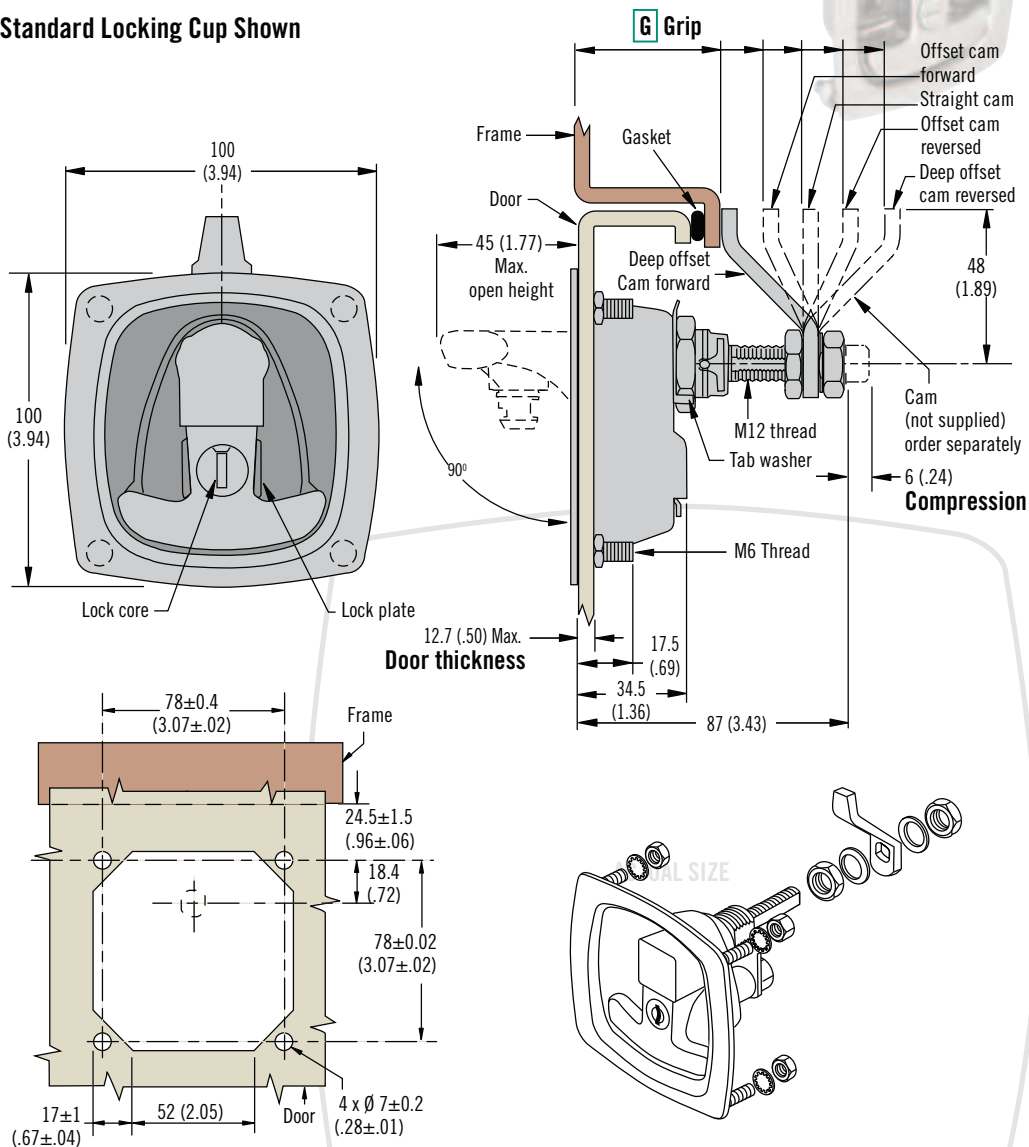

Cam Part Number Table (order separately)			
Part Number	G Grip		Cam Type
	Min.	Max.	
N2-21-101-24	28 (1.10)	43 (1.69)	Deep offset cam, forward
	88 (3.46)	104 (4.09)	Deep offset cam, reversed
N2-21-102-24	43 (1.69)	58 (2.28)	Offset cam, forward
	73 (2.87)	88 (3.46)	Offset cam, reversed
N2-21-103-24	58 (2.28)	73 (2.87)	Straight

L Locking style

- 0 Non-locking
- 1 Key-locking keyed alike CH751 (2 keys supplied)

Latch part number (no cam)

N2 - 2 - 30 L - 01 - 20

Other options available. For complete details on variety, part numbers, installation and specification, go to

INFO CLIC www.southco.com/N2

Dimensions in millimeters (inch) unless otherwise stated

southco
CONNECT · CREATE · INNOVATE

N2 Compression Latch

Lift & turn series · Stainless Steel · Folding T-handle
No cup style · Adjustable grip



Locking Shown

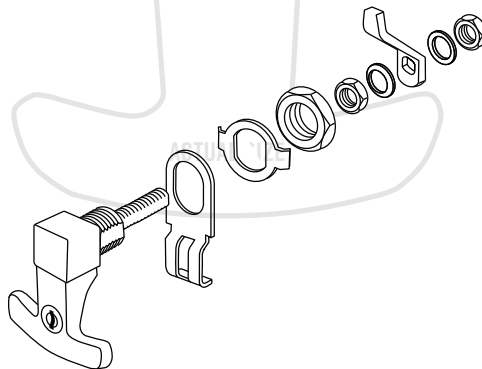
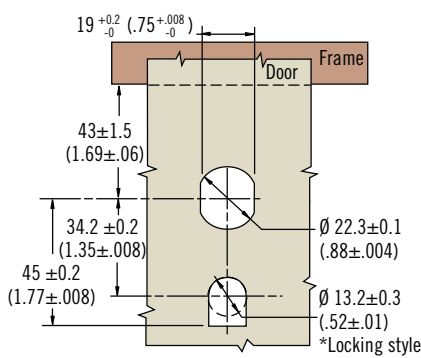
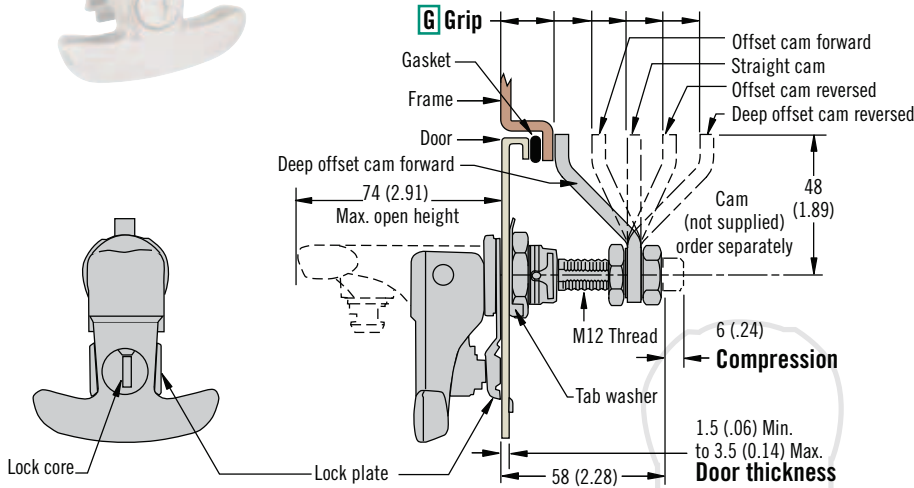

- Heavy-duty performance
- Low profile when latched
- Easy grip adjustment
- Intuitive operation

Material and Finish

Stainless steel

Performance Details

Max. static load: 1800 N (405 lbf)

Installation Notes

1. Insert latch and tighten mounting nut.
2. Bend tab washer over mounting nut.
3. With latch in closed position, adjust jam nuts to position cam at correct grip. Recommended tightening 20-25 N·m (177-221 in·lbf)
4. If using M12 cam tab washer, after cam is adjusted to correct grip, bend both tabs over the M12 nut.

Keys

Key-locking keyed alike

CH751 (2 keys supplied)



Part Number Selection

Order both parts separately

Choose latch body style

Choose cam (see table)

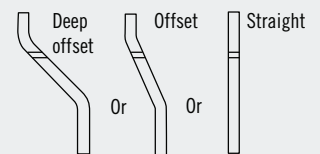

- L** Locking style
- 0 Non-locking
 - 1 Key-locking keyed alike
CH751 (2 keys supplied)

Latch part number (no cam)

N2 - 2 - 10 L - 01 - 20

Cam Part Number Table (order separately)

Part Number	Grip		Cam Type
	Min.	Max.	
N2-21-101-24	2.5 (.10)	15 (.59)	Deep offset cam, forward
	60 (2.36)	75 (2.95)	Deep offset cam, reversed
N2-21-102-24	15 (.59)	30 (1.18)	Offset cam, forward
	45 (1.77)	60 (2.36)	Offset cam, reversed
N2-21-103-24	30 (1.18)	45 (1.77)	Straight

Dimensions in millimeters (inch) unless otherwise stated



Global Corporate Headquarters and Americas Customer Service & Technical Support Center
Tel: (1) 610-459-4000 · Fax: (1) 610-459-4012 · www.southco.com · info@southco.com



www.southco.com/N2

© Southco N2SS 717NA 11-10