



E3 VISE ACTION® Compression Latch

Large · Zinc and plated steel · Wing knob · Adjustable grip

- Consistent pre-set compression
- Easy grip adjustment
- Multiple key codes

Material and Finish

Zinc alloy, powder coated and steel, zinc plated

Performance Details

Max. static load: 450 N (100 lbf)

Sealing Notes

NEMA 4 / IP65 sealing is achieved by using gasket supplied.

Installation Notes

Caution: Position cam so latching function can be achieved comfortably by hand. Recommended tightening torque for the mounting nut is 20 N·m (176 in·lbf).

Keys and Accessories

Key CH751 page 58
Key R001 page 58
Washers and sleeve nut see page 60

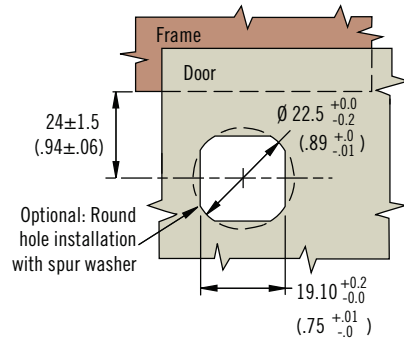
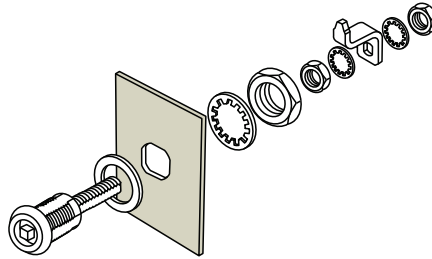
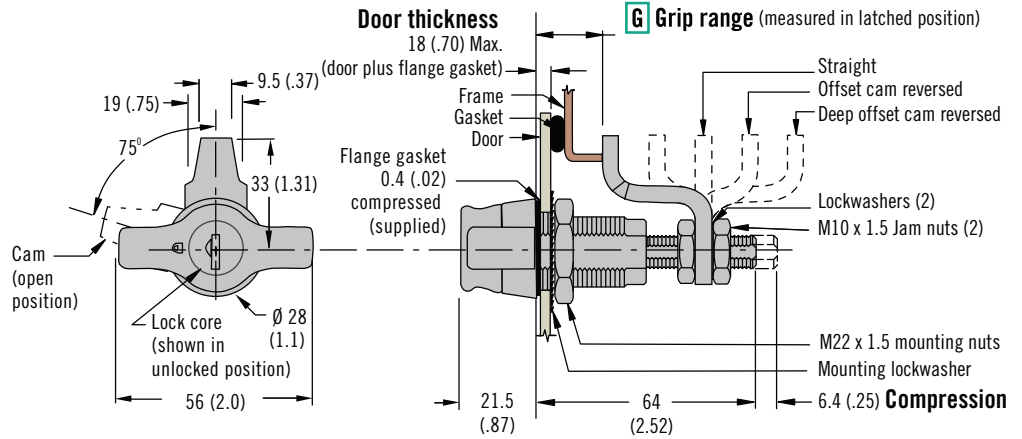

L Lock Styles



Wing knob, non-locking

Wing knob, key-locking, keyed CH751

Wing knob, key-locking, shuttered, keyed R001

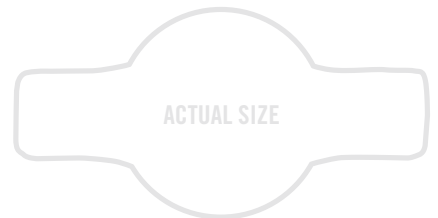

Part Number Selection

- L** Lock style ←
- 50 Wing knob, non-locking
- 51 Wing knob, key-locking, keyed CH751 (1 overmolded key supplied)
- 58 Wing knob, key-locking, keyed R001 (1 overmolded key supplied)

E3 - 1 L - G 5

G Grip	Min.	Max.	Cam Type
1	11.4 (.45)	27.2 (1.07)	Deep offset cam, forward
	66.3 (2.61)	76.2 (3.00)	Deep offset cam, reversed
2	25.4 (1)	41.1 (1.62)	Offset cam, forward
	52.6 (2.07)	68.3 (2.69)	Offset cam, reversed
3	38.9 (1.53)	54.6 (2.15)	Straight cam

Dimensions in millimeters (inch) unless otherwise stated