



D8 DZUS® PANEX Quarter-Turn Fasteners

Studs · Size 9

Material and Finish

Studs: Steel, zinc plated and chromate or chrome plated

82

85

D8

D1

D4

D7

NY

H Head Styles - Tool Actuated

Oval Slot

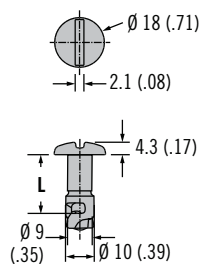

Hex Recess

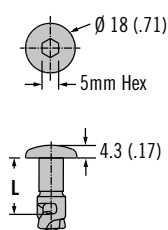

Phillips Recess

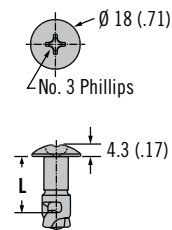

H Head Styles - Hand Actuated

Wing

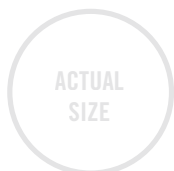
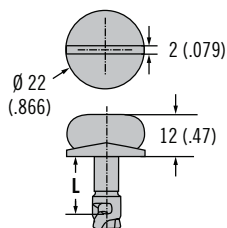

Bail

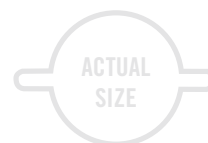
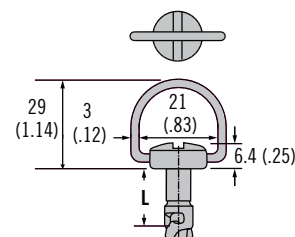

Stud Panel Preparation

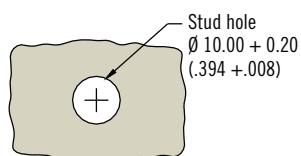

D8 DZUS® PANEX Quarter-Turn Fasteners

Stud selection · Size 9

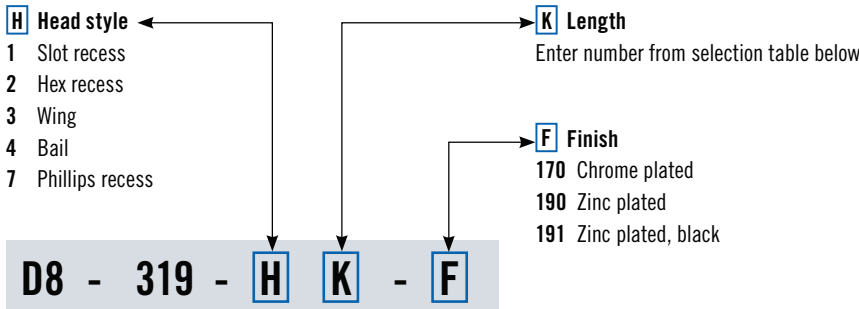

Part Number Selection

82

85

D8

D1

D4

D7

NY



To select correct fastener:

1. Select receptacle

Choose a receptacle from pages 300 - 302

2. Select retainer and accessories

from page 303 and note any adjustment values

3. Specify stud length

Calculate the total material thickness (TMT) using the formula given for the receptacle selected. Find the range of TMT using the stud length selection table (left) using the column (A, or B) given for the receptacle selected.

4. Complete the stud part number

by specifying the head style **H**, stud length **K**, and material **M**

Example:

For rivet-on
 D8-339-400-121 use column A
 For TMT value calculated as 5.2 (.206), K = 13

For slotted head style in steel, zinc plated material, completed part number: D8-319-113-190

A complete example can be found on page 271.

Notes

Stainless steel material may require a higher minimum order quantity. Contact Southco for details.

Stud Length Table					
A		B		K	L ±.15 (.006)
Min.	Max.	Min.	Max.		
TMT Range For: D8-339-400-121 D8-339-500-121 D8-339-300-121 D8-339-301-121 D8-339-305-121		TMT Range For: D8-339-200-190			
2.0 (.08)	2.9 (.11)	~	~	10	10 (.394)
3.0 (.12)	3.9 (.15)	~	~	11	11 (.433)
4.0 (.16)	4.9 (.19)	~	~	12	12 (.472)
5.0 (.20)	5.9 (.23)	~	~	13	13 (.512)
6.0 (.24)	6.9 (.27)	~	~	14	14 (.551)
7.0 (.28)	7.9 (.31)	~	~	15	15 (.591)
8.0 (.31)	8.9 (.35)	~	~	16	16 (.630)
9.0 (.35)	9.9 (.39)	~	~	17	17 (.669)
10.0 (.39)	10.9 (.43)	~	~	18	18 (.709)
11.0 (.43)	11.9 (.47)	~	~	19	19 (.748)
12.0 (.47)	12.9 (.51)	~	~	20	20 (.787)
13.0 (.51)	13.9 (.55)	~	~	21	21 (.827)
14.0 (.55)	14.9 (.59)	2.5 (.10)	3.4 (.13)	22	22 (.866)
15.0 (.59)	15.9 (.63)	3.5 (.14)	4.4 (.17)	23	23 (.906)
16.0 (.63)	16.9 (.67)	4.5 (.18)	5.4 (.21)	24	24 (.945)
17.0 (.67)	17.9 (.70)	5.5 (.22)	6.4 (.25)	25	25 (.984)
18.0 (.71)	18.9 (.74)	6.5 (.26)	7.4 (.29)	26	26 (1.02)
19.0 (.75)	19.9 (.78)	7.5 (.30)	8.4 (.33)	27	27 (1.06)
20.0 (.79)	20.9 (.82)	8.5 (.33)	9.4 (.37)	28	28 (1.10)
21.0 (.83)	21.9 (.86)	9.5 (.37)	10.4 (.41)	29	29 (1.14)
22.0 (.87)	22.9 (.90)	10.5 (.41)	11.4 (.45)	30	30 (1.18)





D8 DZUS® PANEX Quarter-Turn Fasteners

Receptacles · Size 9

Material and Finish

Steel, zinc immersion coating

Installation Notes

Install with $\varnothing 3$ (.125) rivets

82

85

D8

D1

D4

D7

NY

Part Number

See table

Notes

Utilize stud selection column indicated when choosing a stud length from the stud length table on page 299

Rivet-On

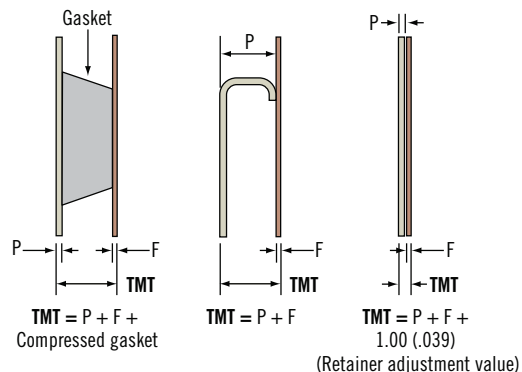
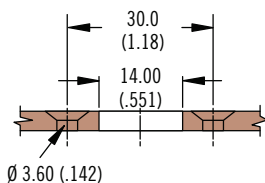
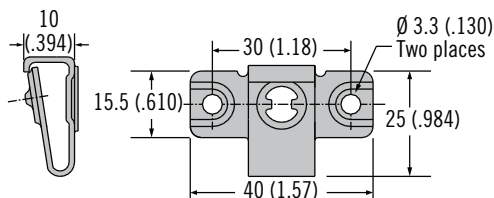

Part Number	Stud Selection Column
D8-339-400-121	A

Material and Finish

Steel, zinc immersion coating

Weld-On

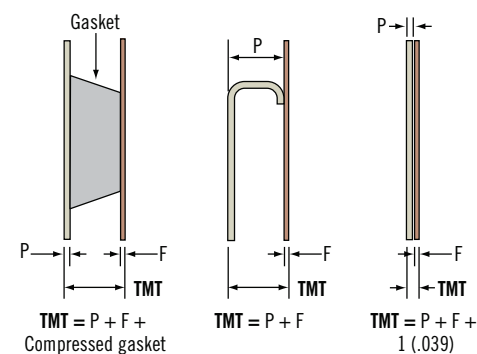
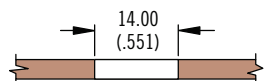
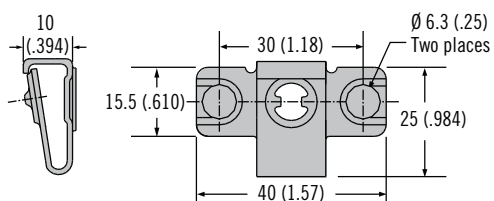

Part Number	Stud Selection Column
D8-339-500-121	A

Part Number

See table

Notes

Utilize stud selection column indicated when choosing a stud length from the stud length table on page 299

D8 DZUS® PANEX Quarter-Turn Fasteners Receptacles - Size 9

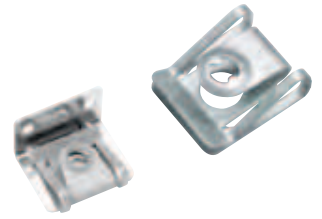

301

Side Mount

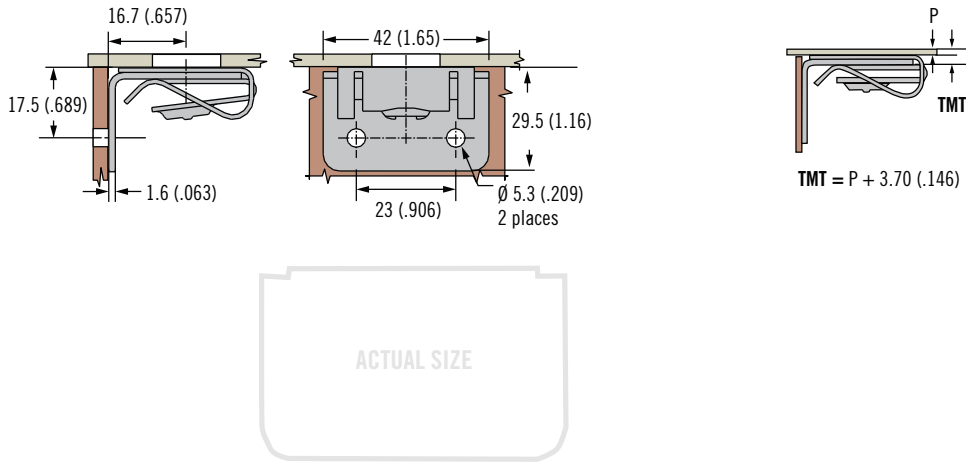

Material and Finish

Steel, zinc immersion coating

82

85

D8

D1

D4

D7

NY

Part Number

See table

Notes

Utilize stud selection column indicated when choosing a stud length from the stud length table on page 299

Part Number	Stud Selection Column
D8-339-305-121	A

Clip-On

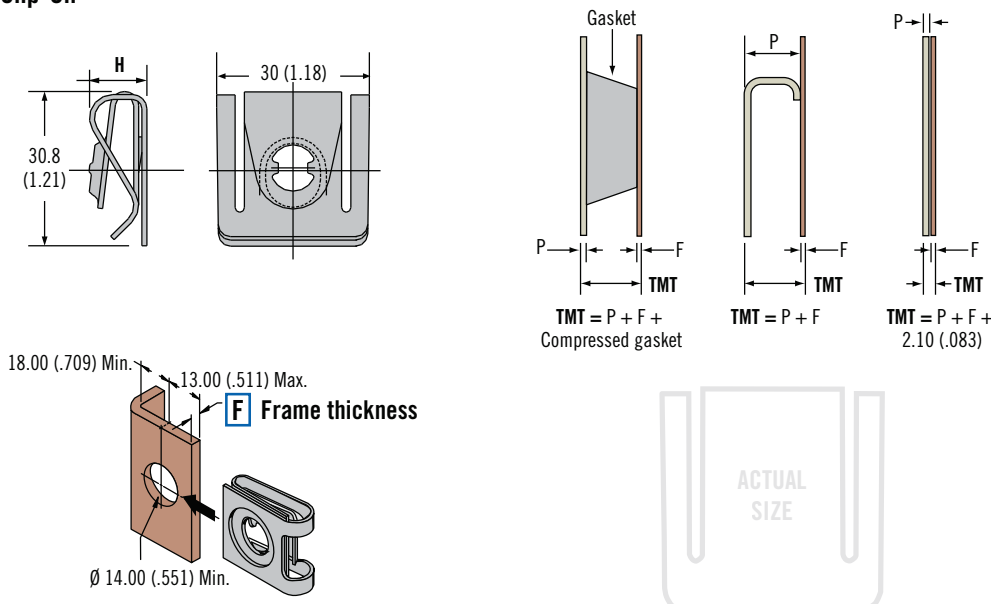

Material and Finish

Steel, zinc immersion coating

Part Number

See table

Notes

Utilize stud selection column indicated when choosing a stud length from the stud length table on page 299

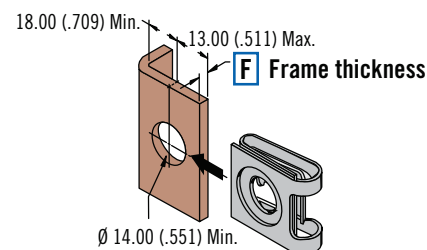

F Frame Thickness Range	Part Number	H	Stud Selection Column
0.7 - 3.2 (.028 - .126)	D8-339-300-121	10.7 (.421)	A
3.2 - 5.5 (.126 - .217)	D8-339-301-121	11.3 (.445)	



D8 DZUS® PANEX Quarter-Turn Fasteners

Receptacles · Size 9

Material and Finish

Steel, zinc plated

82

85

D8

D1

D4

D7

NY

Front Mount

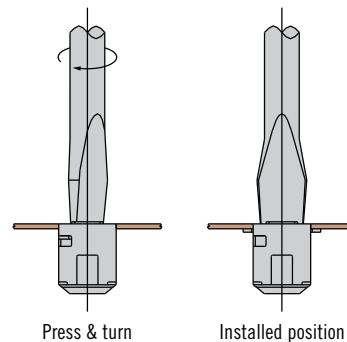
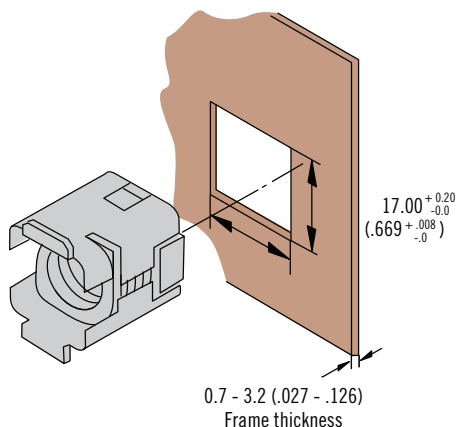
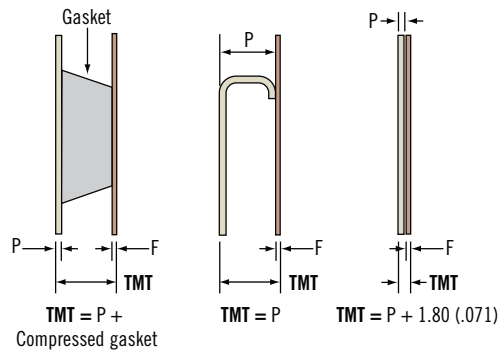
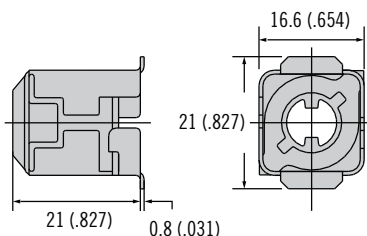

Part Number

See table

Notes

Utilize stud selection column indicated when choosing a stud length from the stud length table on page 299

Type	Part Number	Stud Selection Column
Front mount	D8-339-200-190	B

D8 DZUS® PANEX Quarter-Turn Fasteners

Retainers and accessories · Size 9



303

Retainer Push-On, Plastic

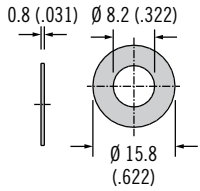

Retainer Push-On, Steel

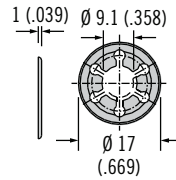

Type	Part Number	Material	Adjustment Value
Push-on Plastic	D8-329-100-040	High density polyethylene, natural	Included in TMT calculation
Push-on	D8-329-101-200	Stainless steel	

Material and Finish

See table

82

85

D8

D1

D4

D7

NY



Retainer Spring (Must be secured with steel retainer)

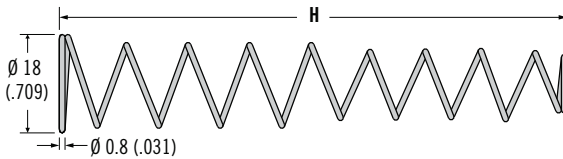

With Retaining Spring

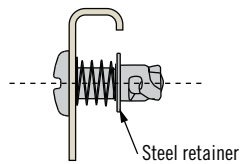

Without Retaining Spring

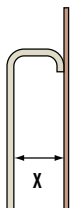
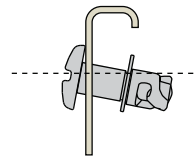

Part Number	H	X Min.	X Max.
D8-329-200-200	48 (1.89)	7 (.276)	43 (1.69)