

# D4 DZUS® Standard Line Quarter-Turn Fasteners

## Stud selection · Size 5

### Material and Finish

Studs:  
Steel, zinc plated or stainless steel

82

85

D8

D1

D4

D7

NY

### To select correct fastener:

#### 1. Select receptacle

Choose a receptacle from pages 320 - 321

#### 2. Select retainer and accessories

from pages 322 - 323 and note any adjustment values

#### 3. Specify stud length

Calculate the total material thickness (TMT) using the formula given for the receptacle selected. Find the range of TMT using the stud length selection table (right) using the column (A, B or C) given for the receptacle selected.

#### 4. Complete the stud part number

by specifying the head style **H**, stud length **K**, and material **M**

#### Example:

For rivet-on

D4-S5-225 use column A

For TMT value calculated as 5.21 (.205), K = 40

For slotted head style in steel material, completed part number: D4-AJ5-40

A complete example can be found on page 271.

#### Notes

Stainless steel material may require a higher minimum order quantity. Contact Southco for details.

### H Head Styles - Tool Actuated

#### Slot

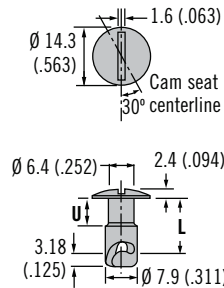

#### Hex Recess

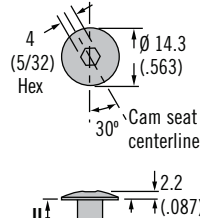

#### Phillips Recess

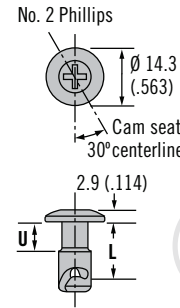

#### Flush slot

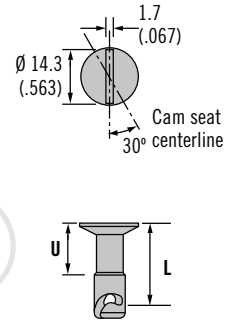

### H Head Styles - Hand Actuated

#### Wing

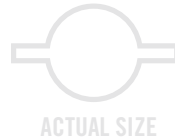
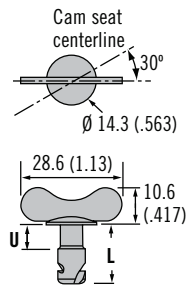

#### Bail

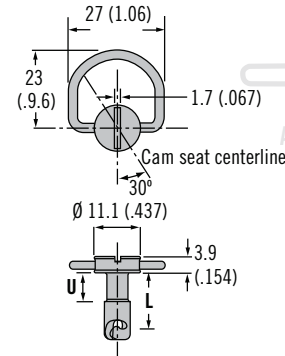

Stud Length Table										
A				B				U	L	K
TMT Range For: Rivet-On Receptacle D4-S5-225		TMT Range For: Rivet-On Receptacle D4-S5-200		TMT Range For: Weld-On Receptacle D4-X414-310		TMT Range For: Weld-On Receptacle D4-X414-285				
Min.	Max.	Min.	Max.	Min.	Max.	Min.	Max.			
2.67 (.105)	3.28 (.129)	3.3 (.13)	3.91 (.154)	~	~	~	~	3.18 (.125)	7.62 (.300)	30
3.94 (.155)	4.55 (.179)	4.57 (.18)	5.18 (.204)	1.65 (.065)	2.26 (.089)	2.29 (.09)	2.9 (.114)	3.81 (.150)	8.89 (.350)	35
5.21 (.205)	5.82 (.229)	5.84 (.23)	6.45 (.254)	2.92 (.115)	3.53 (.139)	3.56 (.14)	4.17 (.164)	5.08 (.200)	10.16 (.400)	40
6.48 (.255)	7.09 (.279)	7.11 (.28)	7.72 (.304)	4.19 (.165)	4.8 (.189)	4.83 (.19)	5.44 (.214)	5.72 (.225)	11.43 (.450)	45
7.75 (.305)	8.36 (.329)	8.38 (.33)	8.99 (.354)	5.46 (.215)	6.07 (.239)	6.1 (.24)	6.71 (.264)	6.35 (.250)	12.70 (.500)	50
9.02 (.355)	9.63 (.379)	9.65 (.38)	10.26 (.404)	6.73 (.265)	7.34 (.289)	7.37 (.29)	7.98 (.314)	6.99 (.275)	13.97 (.550)	55
10.29 (.405)	10.9 (.429)	10.92 (.43)	11.53 (.454)	8.00 (.315)	8.61 (.339)	8.64 (.34)	9.25 (.364)	7.62 (.300)	15.24 (.600)	60
11.56 (.455)	12.17 (.479)	12.19 (.48)	12.8 (.504)	9.27 (.365)	9.88 (.389)	9.91 (.39)	10.52 (.414)	8.89 (.350)	16.51 (.650)	65
12.83 (.505)	13.44 (.529)	13.46 (.53)	14.07 (.554)	10.54 (.415)	11.15 (.439)	11.18 (.44)	11.79 (.464)	10.16 (.400)	17.78 (.700)	70
14.1 (.555)	14.71 (.579)	14.73 (.58)	15.34 (.604)	11.81 (.465)	12.42 (.489)	12.45 (.49)	13.06 (.514)		19.05 (.750)	75
15.37 (.605)	15.98 (.629)	16.00 (.63)	16.61 (.654)	13.08 (.515)	13.69 (.539)	13.72 (.54)	14.33 (.564)	12.7 (.500)	20.32 (.800)	80
16.64 (.655)	17.25 (.679)	17.27 (.68)	17.88 (.704)	14.35 (.565)	14.96 (.589)	14.99 (.59)	15.6 (.614)		21.59 (.850)	85
17.91 (.705)	18.52 (.729)	18.54 (.73)	19.15 (.754)	15.62 (.615)	16.23 (.639)	16.26 (.64)	16.87 (.664)	15.24 (.600)	22.86 (.900)	90
19.18 (.755)	19.79 (.779)	19.81 (.78)	20.42 (.804)	16.89 (.665)	17.5 (.689)	17.53 (.69)	18.14 (.714)		24.13 (.950)	95
20.45 (.805)	21.06 (.829)	21.08 (.83)	21.69 (.854)	18.16 (.715)	18.77 (.739)	18.8 (.74)	19.41 (.764)	17.78 (.70)	25.40 (1.00)	100

**Flush**

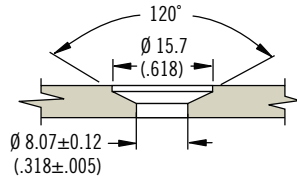

**Standard**

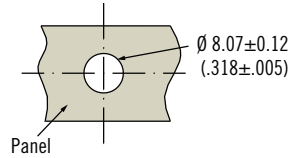

**Part Number Selection**

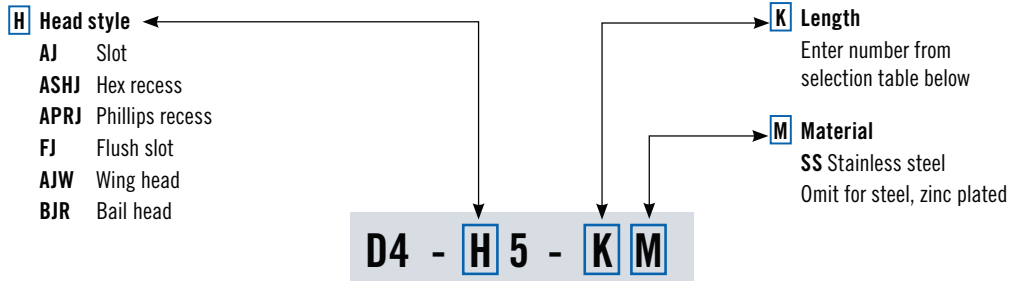

Stud Length Table						
C				U	L	K
TMT Range For: Clip-On Receptacle D4-SL5-305		TMT Range For: Clip-On Receptacle D5-SL5-280				
Min.	Max.	Min.	Max.			
~	~	1.17 (.046)	1.78 (.07)	3.18 (.125)	7.62 (.300)	<b>30</b>
1.8 (.071)	2.41 (.095)	2.44 (.096)	3.05 (.12)	3.81 (.150)	8.89 (.350)	<b>35</b>
3.07 (.121)	3.68 (.145)	3.71 (.146)	4.32 (.17)	5.08 (.200)	10.16 (.400)	<b>40</b>
4.34 (.171)	4.95 (.195)	4.98 (.196)	5.59 (.22)	5.72 (.225)	11.43 (.450)	<b>45</b>
5.61 (.221)	6.22 (.245)	6.25 (.246)	6.86 (.27)	6.35 (.250)	12.70 (.500)	<b>50</b>
6.88 (.271)	7.49 (.295)	7.52 (.296)	8.13 (.32)	6.99 (.275)	13.97 (.550)	<b>55</b>
8.15 (.321)	8.76 (.345)	8.79 (.346)	9.4 (.37)	7.62 (.300)	15.24 (.600)	<b>60</b>
9.42 (.371)	10.03 (.395)	10.06 (.396)	10.67 (.42)	8.89 (.350)	16.51 (.650)	<b>65</b>
10.69 (.421)	11.3 (.445)	11.33 (.446)	11.94 (.47)	10.16 (.400)	17.78 (.700)	<b>70</b>
11.96 (.471)	12.57 (.495)	12.6 (.496)	13.21 (.52)		19.05 (.750)	<b>75</b>
13.23 (.521)	13.84 (.545)	13.87 (.546)	14.48 (.57)	12.7 (.500)	20.32 (.800)	<b>80</b>
14.5 (.571)	15.11 (.595)	15.14 (.596)	15.75 (.62)		21.59 (.850)	<b>85</b>
15.77 (.621)	16.38 (.645)	16.41 (.646)	17.02 (.67)	15.24 (.600)	22.86 (.900)	<b>90</b>
17.04 (.671)	17.65 (.695)	17.68 (.696)	18.29 (.72)		24.13 (.950)	<b>95</b>
18.31 (.721)	18.92 (.745)	18.95 (.746)	19.56 (.77)	17.78 (.70)	25.40 (1.00)	<b>100</b>



- 82
- 85
- D8
- D1
- D4**
- D7
- NY





# D4 DZUS® Standard Line Quarter-Turn Fasteners

## Receptacles · Size 5

### Material and Finish

Steel, zinc plated or stainless steel

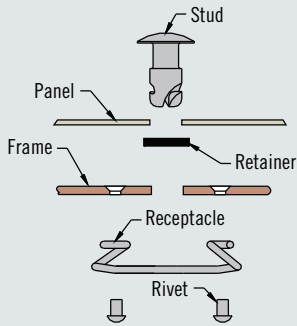

### Rivet-On

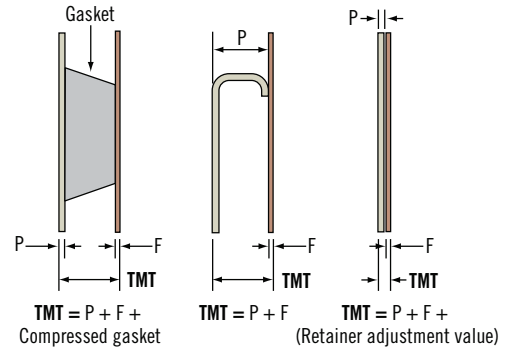
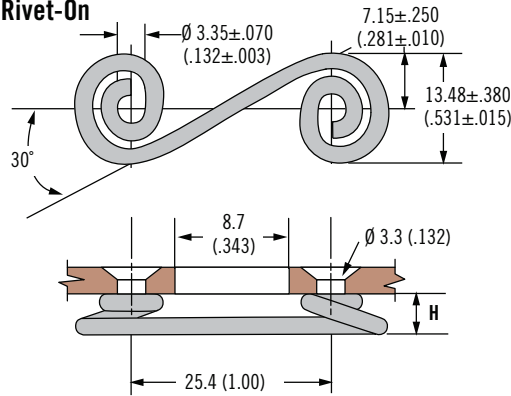

### Part Number

See table

### Notes

Utilize stud selection column indicated when choosing a stud length from the stud length table on page 318

Part Number		H	Stud Selection Column
Steel	Stainless Steel		
D4-S5-200	D4-S5-200SS	5.08 (.200)	A
D4-S5-225	D4-S5-225SS	5.72 (.225)	

### Material and Finish

Steel, zinc plated or stainless steel

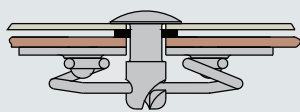

### Weld-On

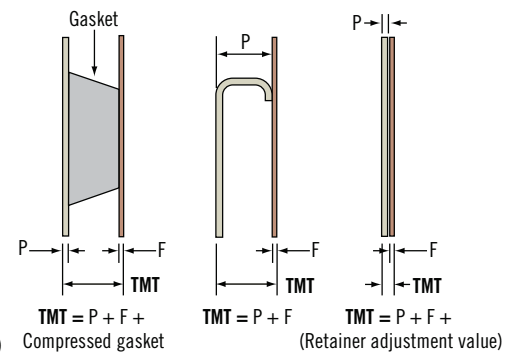
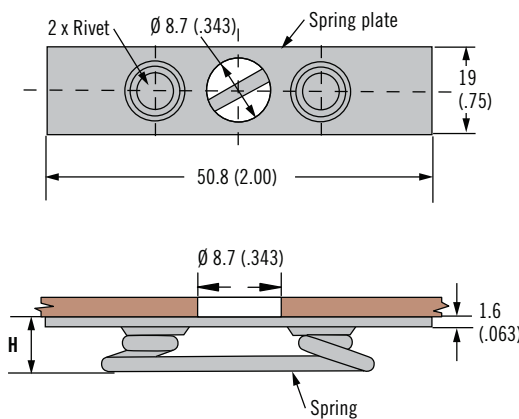

### Part Number

See table

### Notes

Utilize stud selection column indicated when choosing a stud length from the stud length table on page 318

Part Number		H	Stud Selection Column
Steel	Stainless Steel		
D4-X414-285	D4-X414-285SS	7.2 (.285)	B
D4-X414-310	D4-X414-310SS	7.9 (.310)	

# D4 DZUS® Standard Line Quarter-Turn Fasteners

## Receptacles · Size 5



321

### Clip-On

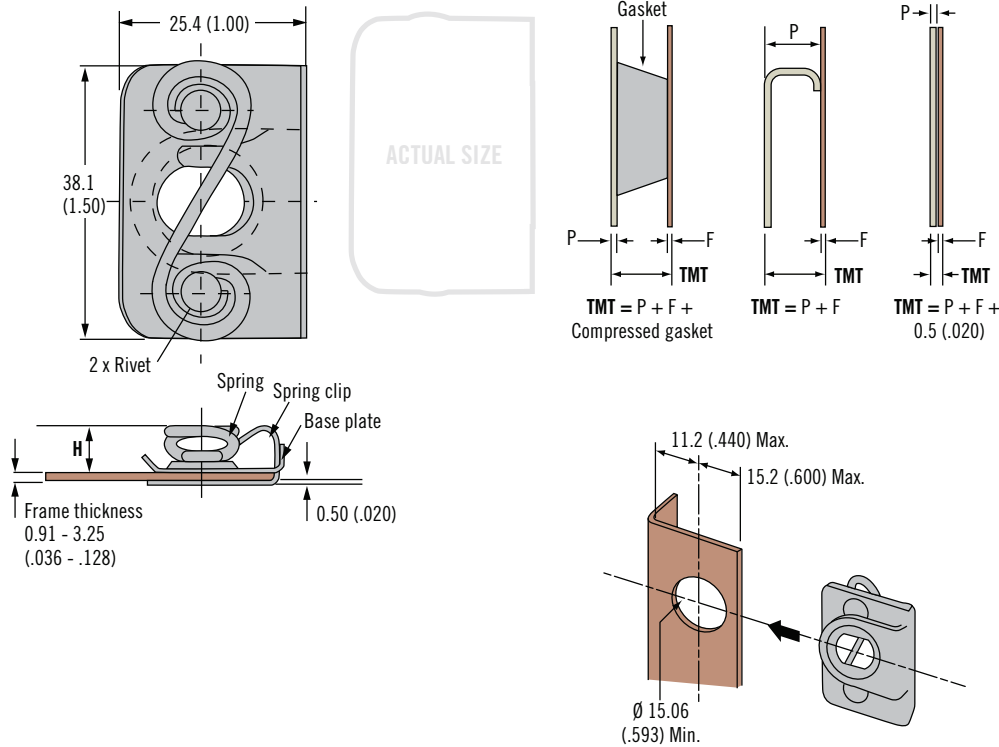

### Material and Finish

Studs: Steel, zinc plated

82

85

D8

D1

D4

D7

NY



Part Number	H	Stud Selection Column
D4-SL5-280	7.11 (.280)	C
D4-SL5-305	7.75 (.305)	

### Part Number

See table

### Notes

Utilize stud selection column indicated when choosing a stud length from the stud length table on page 318



# D4 DZUS® Standard Line Quarter-Turn Fasteners

## Retainers · Size 5

### Material and Finish

Retaining ring and spring:  
Stainless steel  
Retainer GH: Aluminum, natural  
Retainer GP: HD polythene

### Installation Notes

1. Place the retainer on the mandrel as shown
2. Align ring or spring ends so that they will miss the stud cam
3. Place mandrel in end of stud cam
4. Place tool over mandrel
5. Push retainer until it is sealed in stud undercut

### Notes

**Tooling:**  
TFRS hand tool: Spreads the inside diameter of retainers over stud shanks and then pushes them into stud undercuts  
TB1A block: Nests stud heads during installation. (Any flat block may be used for BJR bail head studs).

### Part Number

See table

### Retainer GP

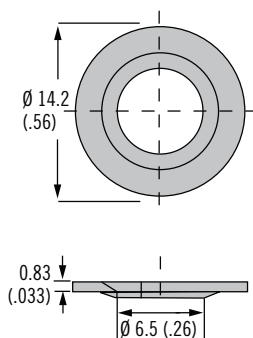

### Retainer GH

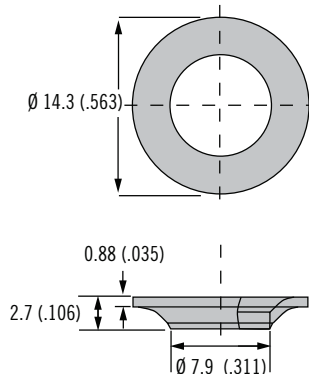

### Retainer Ring

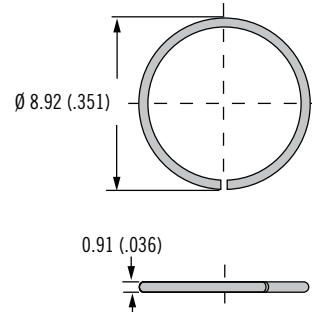

### Spring

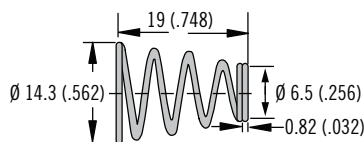

### Install Retainer GP, Retaining Ring and SX

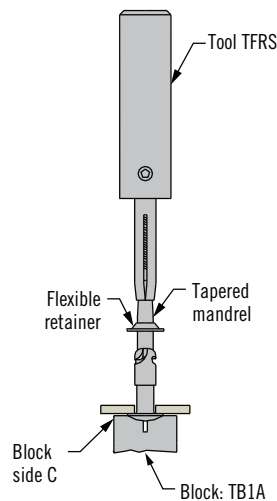

### Install Retainer GH

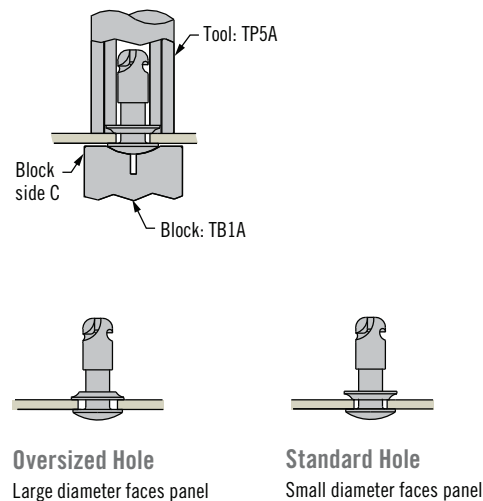

Type	Part Number	Adjustment Value	Installation Tool Part Number
Retainer GP, natural	D4-GP5	Add 0.86 (.034)	29-TFRS5 and 29-TB1A5 (both required for correct installation - see images above)
Retainer GP, black	D4-GP5B		
Retainer GH	D4-GH5	Add 0.78 (.031)	29-TP5A5 and 29-TB1A5 (both required for correct installation - see images above)
Retaining ring	D4-RR5	Add 0.91 (.035)	29-TFRS5 and 29-TB1A5 (both required for correct installation - see images above)
Retaining spring	D4-SX510	Add 1.64 (.064)	

# D4 DZUS® Standard Line Quarter-Turn Fasteners

## Retainers - Size 5



### Retainer GA

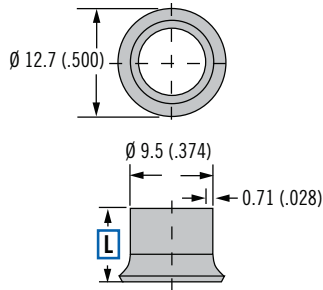

### Installation Retainer GA

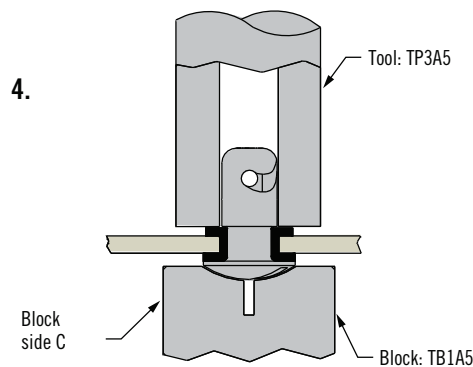
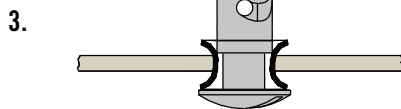
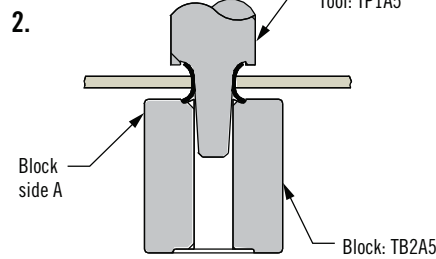

### Material and Finish

Retainer GA: Aluminum, natural

### Installation Notes

1. Insert retainer in panel hole
2. Set retainer
3. Insert stud
4. Flatten retainer

82

85

D8

D1

D4

D7

NY



Panel Thickness	L Length	Part Number	Adjustment Value	Installation Tool Part Number
0.38 - 0.64 (.015 - .025)	4.45 (.175)	D4-GA5-175	Add 1.42 (.056)	29-TP1A5, 29-TP3A5, 29-TB1A5 and 29-TB2A5 (all four required for correct installation - see images above)
0.66 - 1.27 (.026 - .050)	5.08 (.200)	D4-GA5-200		
1.29 - 2.38 (.051 - .094)	6.35 (.250)	D4-GA5-250		

### Part Number

See table