

D4 DZUS® Standard Line Quarter-Turn Fasteners

Stud selection · Size 4

Material and Finish

Studs:
Steel, zinc plated or stainless steel

82

85

D8

D1

D4

D7

NY

To select correct fastener:

1. Select receptacle

Choose a receptacle from pages 314 - 315

2. Select retainer and accessories

from pages 316 - 317 and note any adjustment values

3. Specify stud length

Calculate the total material thickness (TMT) using the formula given for the receptacle selected. Find the range of TMT using the stud length selection table (right) using the column (A, B, C, or D) given for the receptacle selected.

4. Complete the stud part number

by specifying the head style **H**, stud length **K**, and material **M**

Example:

For rivet-on

D4-S4-225 use column A

For TMT value calculated as 5.2 (.206), K = 40

For slotted head style in steel material, completed part number: D4-AJ4-40

A complete example can be found on page 271

H Head Styles - Tool Actuated

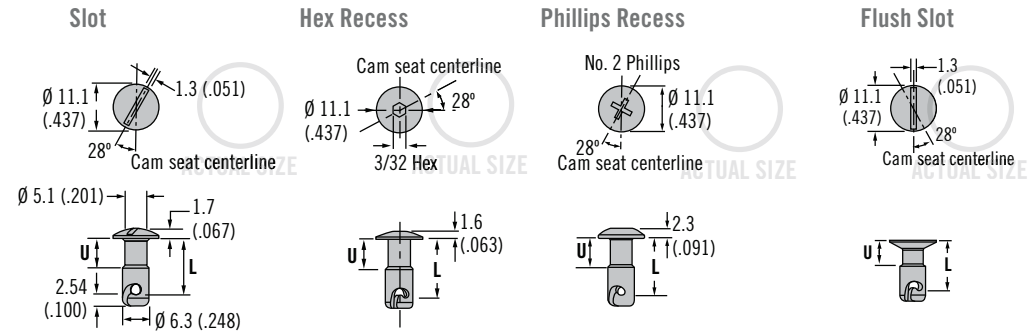

H Head Styles - Hand Actuated

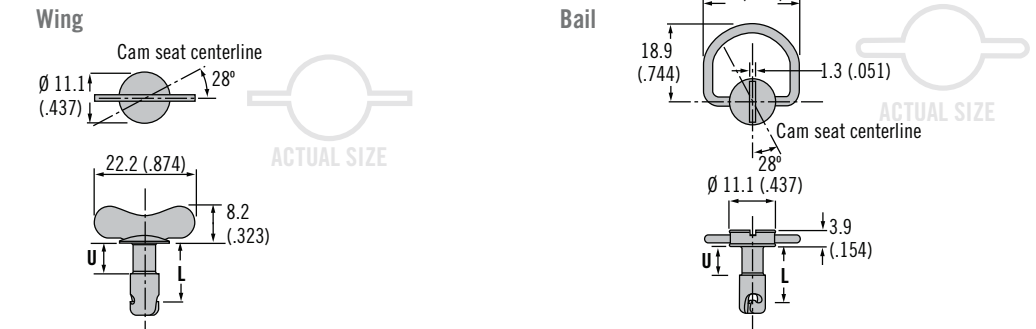

Stud Length Table										
A				B				K	U	L
TMT Range For: Rivet-On Receptacle D4-S4-225		TMT Range For: Rivet-On Receptacle D4-S4-200		TMT Range For: Weld-On Receptacle D4-X485-300		TMT Range For: Weld-On Receptacle D4-X485-275				
Min.	Max.	Min.	Max.	Min.	Max.	Min.	Max.			
1.27 (.050)	1.88 (.074)	1.91 (.075)	2.51 (.099)	~	~	~	~	25	2.54 (.100)	6.35 (.250)
2.54 (.100)	3.15 (.124)	3.18 (.125)	3.78 (.149)	0.64 (.025)	1.24 (.049)	1.27 (.050)	1.88 (.074)	30		7.62 (.300)
3.81 (.150)	4.42 (.174)	4.45 (.175)	5.05 (.199)	1.91 (.075)	2.51 (.099)	2.54 (.100)	3.15 (.124)	35	3.81 (.150)	8.89 (.350)
5.08 (.200)	5.69 (.224)	5.72 (.225)	6.32 (.249)	3.18 (.125)	3.78 (.149)	3.81 (.150)	4.42 (.174)	40	5.08 (.200)	10.16 (.400)
6.35 (.250)	6.96 (.274)	6.99 (.275)	7.59 (.299)	4.45 (.175)	5.05 (.199)	5.08 (.200)	5.69 (.224)	45	5.72 (.225)	11.43 (.450)
7.62 (.300)	8.23 (.324)	8.26 (.325)	8.86 (.349)	5.72 (.225)	6.32 (.249)	6.35 (.250)	6.96 (.274)	50	6.35 (.250)	12.70 (.500)
8.89 (.350)	9.50 (.374)	9.53 (.375)	10.13 (.399)	6.99 (.275)	7.59 (.299)	7.62 (.300)	8.23 (.324)	55	6.99 (.275)	13.97 (.550)
10.16 (.400)	10.77 (.424)	10.80 (.425)	11.40 (.449)	8.26 (.325)	8.86 (.349)	8.89 (.350)	9.50 (.374)	60	7.62 (.300)	15.24 (.600)
11.43 (.450)	12.04 (.474)	12.07 (.475)	12.67 (.499)	9.53 (.375)	10.13 (.399)	10.16 (.400)	10.77 (.424)	65	8.89 (.350)	16.51 (.650)
12.70 (.500)	13.31 (.524)	13.34 (.525)	13.94 (.549)	10.80 (.425)	11.40 (.449)	11.43 (.450)	12.04 (.474)	70		17.78 (.700)
13.97 (.550)	14.58 (.574)	14.61 (.575)	15.21 (.599)	12.07 (.475)	12.67 (.499)	12.70 (.500)	13.31 (.524)	75	10.16 (.400)	19.05 (.750)
15.24 (.600)	15.85 (.624)	15.88 (.625)	16.48 (.649)	13.34 (.525)	13.94 (.549)	13.97 (.550)	14.58 (.574)	80		20.32 (.800)
16.51 (.650)	17.12 (.674)	17.15 (.675)	17.75 (.699)	14.61 (.575)	15.21 (.599)	15.24 (.600)	15.85 (.624)	85	12.7 (.500)	21.59 (.850)
17.78 (.700)	18.39 (.724)	18.42 (.725)	19.02 (.749)	15.88 (.625)	16.48 (.649)	16.51 (.650)	17.12 (.674)	90		22.86 (.900)
19.05 (.750)	19.66 (.774)	19.69 (.775)	20.29 (.799)	17.15 (.675)	17.75 (.699)	17.78 (.700)	18.39 (.724)	95	15.24 (.600)	24.13 (.950)
20.32 (.800)	20.93 (.824)	20.96 (.825)	21.56 (.849)	18.42 (.725)	19.02 (.749)	19.05 (.750)	19.66 (.774)	100		25.40 (1.00)

Flush

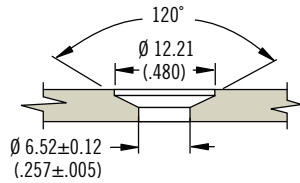

Standard

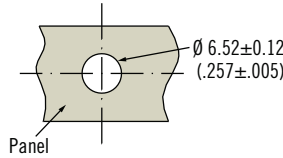

Part Number Selection

H Head style
AJ Slot
ASHJ Hex recess
APRJ Phillips recess
FJ Flush slot
AJW Wing head
BJR Ring head

K Length
 Enter number from selection table on below

M Material
SS Stainless steel
 Omit for steel, zinc plated

D4 - H 4 - K M

Stud Length Table						
C				K	U	L
TMT Range For: Clip-On Receptacle D4-SL4-305		TMT Range For: Clip-On Receptacle D4-SL4-280				
Min.	Max.	Min.	Max.			
~	~	~	~	25	2.54 (.100)	6.35 (.250)
~	~	1.17 (.046)	1.78 (.070)	30		7.62 (.300)
1.80 (.071)	2.41 (.095)	2.44 (.096)	3.05 (.120)	35	3.81 (.150)	8.89 (.350)
3.07 (.121)	3.68 (.145)	3.71 (.146)	4.32 (.170)	40	5.08 (.200)	10.16 (.400)
4.34 (.171)	4.95 (.195)	4.98 (.196)	5.59 (.220)	45	5.72 (.225)	11.43 (.450)
5.61 (.221)	6.22 (.245)	6.25 (.246)	6.86 (.270)	50	6.35 (.250)	12.70 (.500)
6.88 (.271)	7.49 (.295)	7.52 (.296)	8.13 (.320)	55	6.99 (.275)	13.97 (.550)
8.15 (.321)	8.76 (.345)	8.79 (.346)	9.40 (.370)	60	7.62 (.300)	15.24 (.600)
9.42 (.371)	10.03 (.395)	10.06 (.396)	10.67 (.420)	65	8.89 (.350)	16.51 (.650)
10.69 (.421)	11.30 (.445)	11.33 (.446)	11.94 (.470)	70		17.78 (.700)
11.96 (.471)	12.57 (.495)	12.60 (.496)	13.21 (.520)	75	10.16 (.400)	19.05 (.750)
13.23 (.521)	13.84 (.545)	13.87 (.546)	14.48 (.570)	80		20.32 (.800)
14.50 (.571)	15.11 (.595)	15.14 (.596)	15.75 (.620)	85	12.7 (.500)	21.59 (.850)
15.77 (.621)	16.38 (.645)	16.41 (.646)	17.02 (.670)	90		22.86 (.900)
17.04 (.671)	17.65 (.695)	17.68 (.696)	18.29 (.720)	95	15.24 (.600)	24.13 (.950)
18.31 (.721)	18.92 (.745)	18.95 (.746)	19.56 (.770)	100		25.40 (1.00)

Stud Length Table					
D			K	U	L
TMT Range For: Snap-In - Rear Mount Receptacle D4-SQC4-F		D4-GP4B			
Min.	Max.				
0.48 (.019)	1.09 (.043)	None	45	5.72 (.225)	11.43 (.450)
1.12 (.044)	1.73 (.068)	One	50	6.35 (.250)	12.70 (.500)
1.75 (.069)	2.36 (.093)	None	50		
2.39 (.094)	3.00 (.118)	One	55	6.99 (.275)	13.97 (.550)
3.02 (.119)	3.63 (.143)	None	55		
3.66 (.144)	4.27 (.168)	One	60	7.62 (.300)	15.24 (.600)
4.29 (.169)	4.90 (.193)	None	60		
4.93 (.194)	5.54 (.218)	One	65	8.89 (.350)	16.51 (.650)
5.56 (.219)	6.17 (.243)	None	65		
6.20 (.244)	6.81 (.268)	One	70	10.16 (.400)	17.78 (.700)
6.83 (.269)	7.44 (.293)	None	70		
7.47 (.294)	8.08 (.318)	One	75	19.05 (.750)	19.05 (.750)
8.10 (.319)	8.71 (.343)	None	75		
8.74 (.344)	9.35 (.368)	One	80	10.16 (.400)	20.32 (.800)
9.37 (.369)	9.98 (.393)	None	80		

- 82
- 85
- D8
- D1
- D4**
- D7
- NY

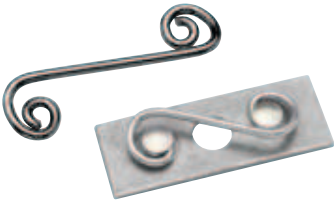

D4 DZUS® Standard Line Quarter-Turn Fasteners

Receptacles · Size 4

Material and Finish

Steel, zinc plated or stainless steel

Notes

After selecting receptacle use stud selection letter **A** and follow instruction on page 312

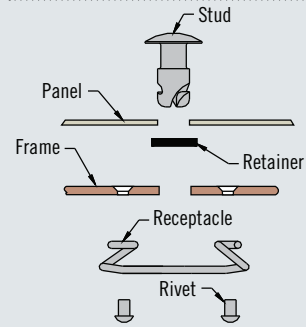

Part Number

See table

Utilize stud selection column indicated when choosing a stud length from the stud length table on pages 312 - 313

Material and Finish

Steel, zinc plated or stainless steel

Notes

After selecting receptacle use stud selection letter **B** and follow instruction on page 312

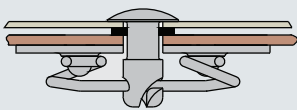

Part Number

See table

Utilize stud selection column indicated when choosing a stud length from the stud length table on pages 312 - 313

Rivet-On

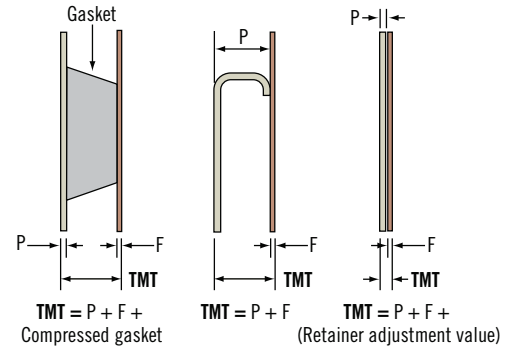
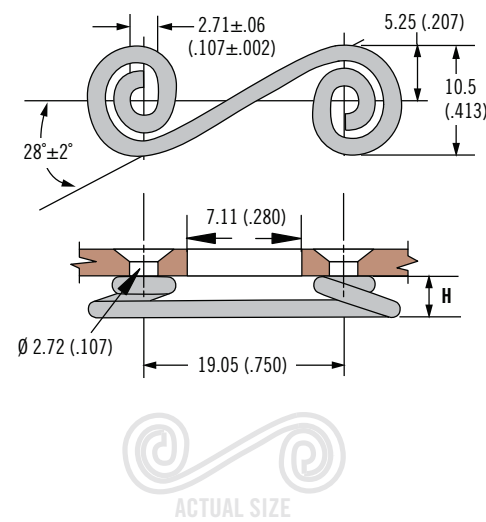

Part Number		H	Stud Selection Column
Steel	Stainless Steel		
D4-S4-200	D4-S4-200SS	5.08 (.200)	A
D4-S4-225	D4-S4-225SS	5.72 (.225)	

Weld-On

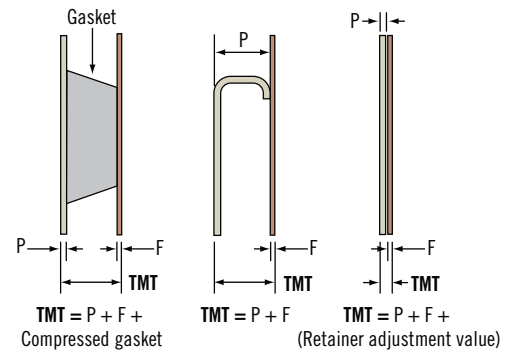
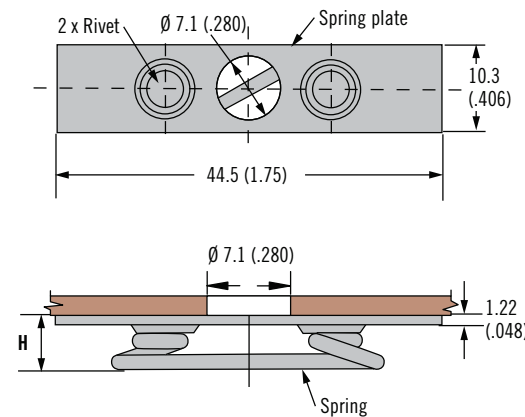

ACTUAL SIZE

Part Number		H	Stud Selection Column
Steel	Stainless Steel		
D4-X485-275	D4-X485-275SS	6.98 (.275)	B
D4-X485-300	D4-X485-300SS	7.62 (.300)	

D4 DZUS® Standard Line Quarter-Turn Fasteners

Receptacles · Size 4

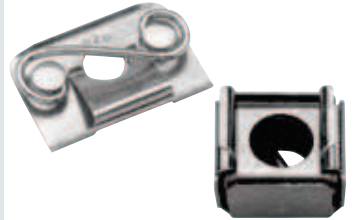

Clip-On

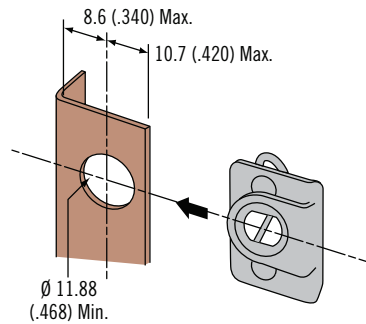
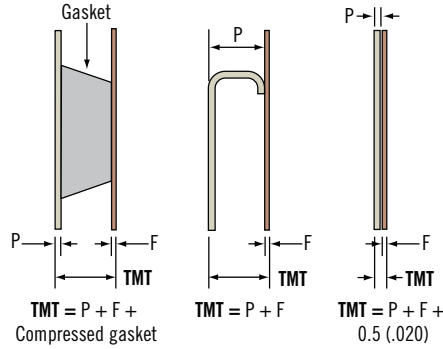
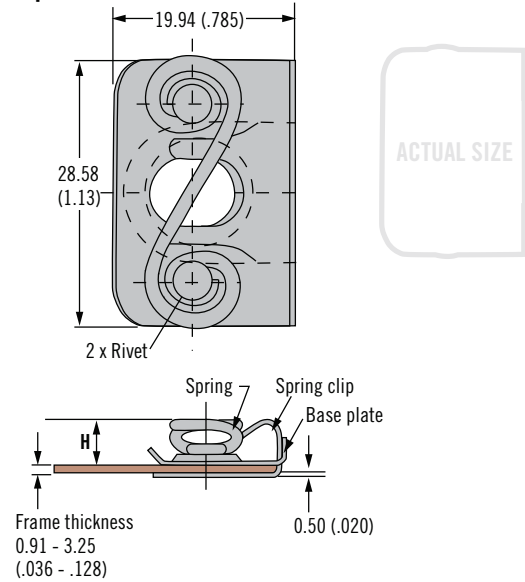

Part Number	H	Stud Selection Column
D4-SL4-280	7.11 (.280)	C
D4-SL4-305	7.75 (.305)	

Material and Finish

Steel, zinc plated

Notes

After selecting receptacle use stud selection letter **C** and follow instruction on page 312

Part Number

See table

Utilize stud selection column indicated when choosing a stud length from the stud length table on pages 312 - 313

Snap-In – Rear Mount

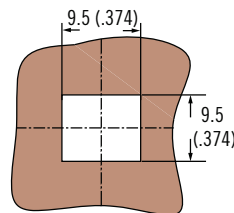
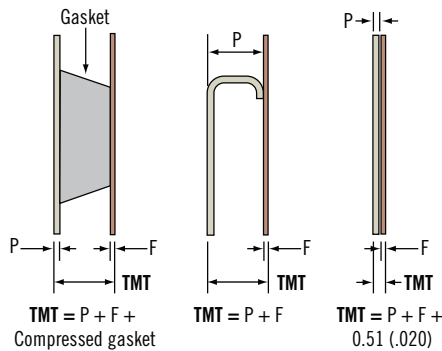
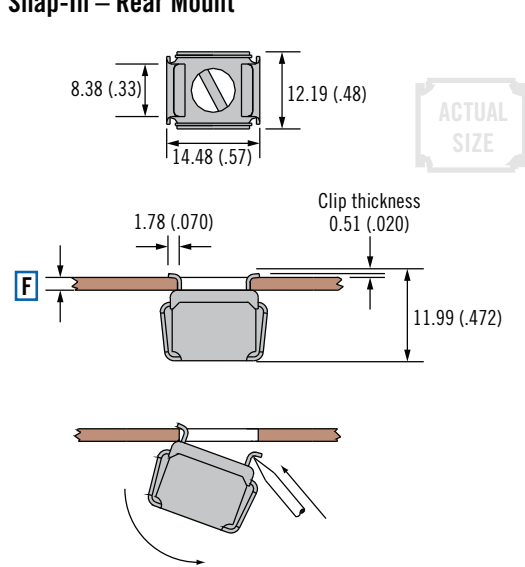

Part Number	F Frame Thickness	H	Stud Selection Column
D4-SQC4-16	0.78 - 1.42 (.031 - .056)	11.48 (.452)	D
D4-SQC4-20	1.47 - 1.98 (.058 - .078)	11.48 (.452)	
D4-SQC4-25	2 - 2.49 (.079 - .098)	11.48 (.452)	
D4-SQC4-30	2.59 - 3.18 (.102 - .125)	11.48 (.452)	

Material and Finish

Steel, zinc plated

Installation Notes

For stud retention use only retaining ring part number: D4-RR4

Notes

After selecting receptacle use stud selection letter **D** and follow instruction on page 312

Part Number

See table

Utilize stud selection column indicated when choosing a stud length from the stud length table on pages 312 - 313



D4 DZUS® Standard Line Quarter-Turn Fasteners

Retainers · Size 4

Material and Finish

Retaining ring and spring:
Stainless steel

Retainer GH: Aluminum, natural

Retainer GP: HD polythene

Installation Notes

1. Place the retainer on the mandrel as shown
2. Align ring or spring ends so that they will miss the stud cam
3. Place mandrel in end of stud cam
4. Place tool over mandrel
5. Push retainer until it is sealed in stud undercut

Notes

Tooling:

TFRS hand tool: Spreads the inside diameter of retainers over stud shanks and then pushes them into stud undercuts.

TB1A block: Nests stud heads during installation. (Any flat block may be used for BJR bail head studs).

Retainer GP

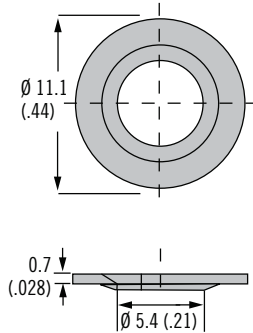

Retainer GH

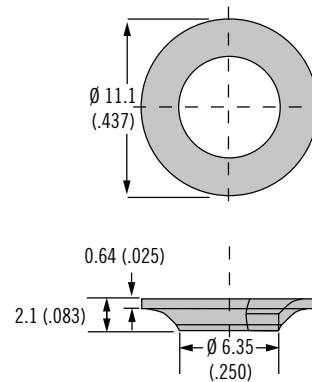

Retainer Ring

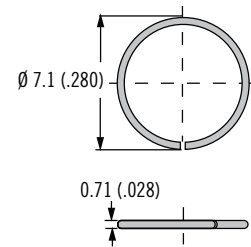

Spring

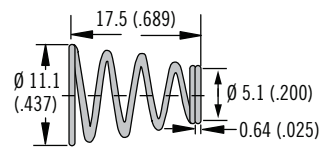

Install Retainer GP, Retaining Ring and SX

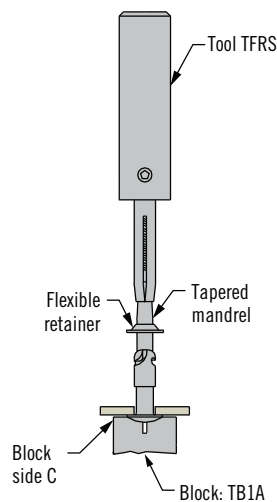

Install Retainer GH

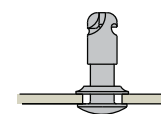
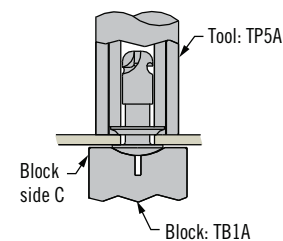

Oversized Hole
Large diameter faces panel

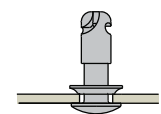

Standard Hole
Small diameter faces panel

Part Number

see table

Type	Part Number	Adjustment Value	Installation Tool Part Number
Retainer GP, natural	D4-GP4	Add 0.7 (.028)	29-TFRS4 and 29-TB1A4 (both required for correct installation - see images above)
Retainer GP, black	D4-GP4B		
Retainer GH	D4-GH4	Add 0.64 (.025)	29-TP5A4 and 29-TB1A4 (both required for correct installation - see images above)
Retaining ring	D4-RR4	Add 0.74 (.029)	29-TFRS4 and 29-TB1A4 (both required for correct installation - see images above)
Retaining spring	D4-SX523	Add 1.28 (.050)	

D4 DZUS® Standard Line Quarter-Turn Fasteners

Retainers - Size 4



Retainer GA

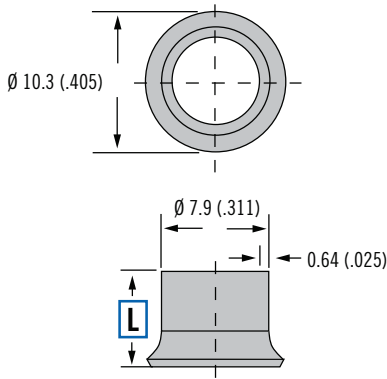

Installation Retainer GA

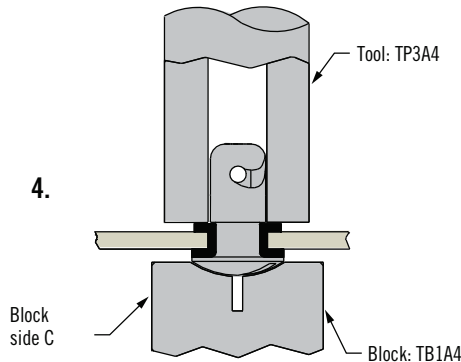
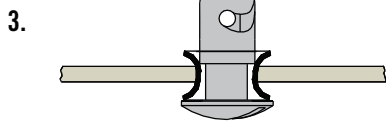
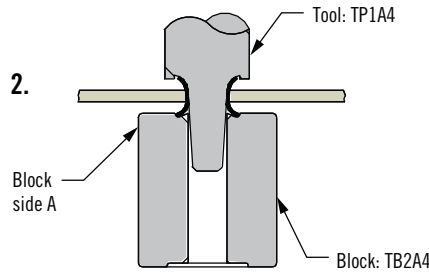
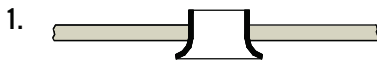

Material and Finish

Retainer GA: Aluminum, natural

Installation Notes

1. Insert retainer in panel hole
2. Set retainer
3. Insert stud
4. Flatten retainer

82

85

D8

D1

D4

D7

NY



Panel Thickness	L	Part Number	Adjustment Value	Installation Tool Part Number
0.38 - 0.64 (.015 - .025)	4.45 (.175)	D4-GA4-175	Add 1.28 (.050)	29-TP1A4, 29-TP3A4 and 29-TB1A4 (all required for correct installation - see images above)
0.66 - 1.27 (.026 - .050)	5.08 (.200)	D4-GA4-200		
1.29 - 2.38 (.051 - .094)	6.35 (.250)	D4-GA4-250		

Part Number

see table