

91 Draw Latch

Under-center · Small · Adjustable



Latch

Standard

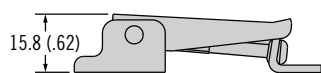
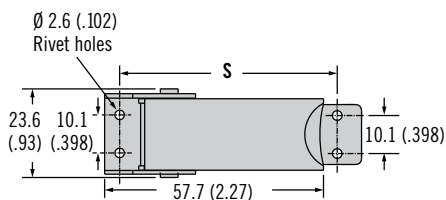

Latch shown with 91-630-XX keeper

Secondary Catch

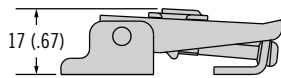
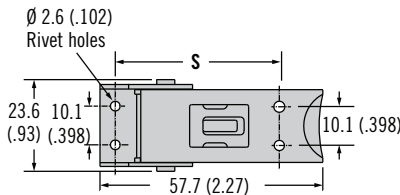

Latch shown with 91-634-XX keeper

Keeper

Exposed

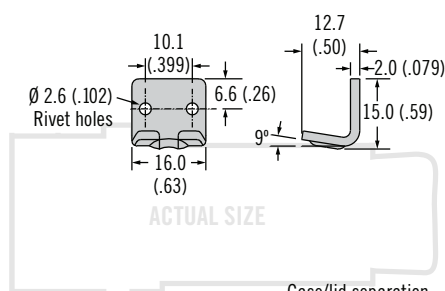

Concealed

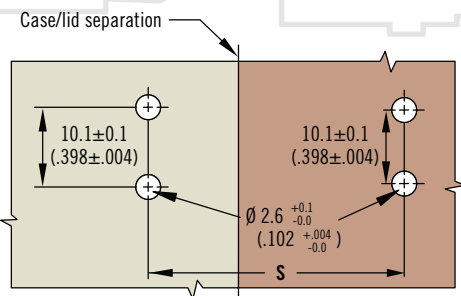
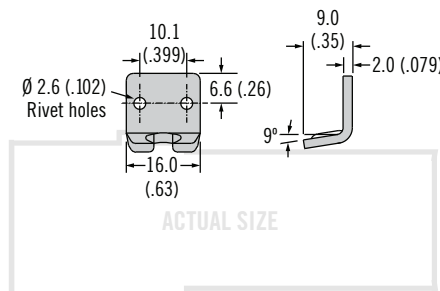

Material	Latch Part Number	
	Standard	Secondary Catch
Steel	91-351-07	91-361-07
Stainless Steel	91-351-52	91-361-52

S	Keeper Type	Steel	Stainless Steel
		39 - 47 (1.53 - 1.85)	Concealed
52 - 60 (2.04 - 2.36)	Exposed	91-630-07	91-630-52

- Adjustable grip
- Secondary catch option to prevent accidental opening

Material and Finish

Stainless steel or steel, zinc plated

Performance Details

Max. working load

Stainless steel: 710 N (160 lbf)

Steel, zinc plated: 1200 N (270 lbf)

Installation Notes

Ø 2.5 (No. 3) screws (not supplied)