



47 Captive Screws

Styled knob series · 8-32 thread size

- Designed for hand operation
- Spring ejected
- Wide variety of sizes, recesses and installation options

Material and Finish

Ferrule:

Press-in: Hardened carbon steel, zinc plate, chromate, plus sealer

Flare-in, floating and snap-in: Aluminum, natural

Knob: Aluminum, natural or black powder coated

Screw: Hardened carbon steel, zinc plated, chromate, plus sealer

Installation Notes

See pages 392 - 393, 497

Notes

 To ensure you receive **SOUTHCO** quality parts, look for the segmented circle

Recess Styles

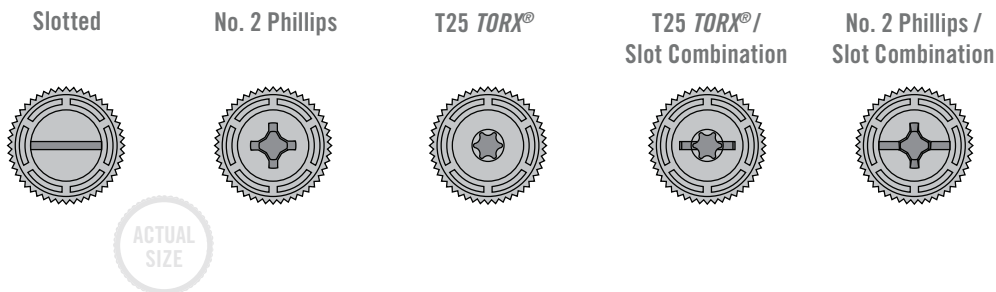

Knob Height and Screw Projection

(Flare-in style shown)

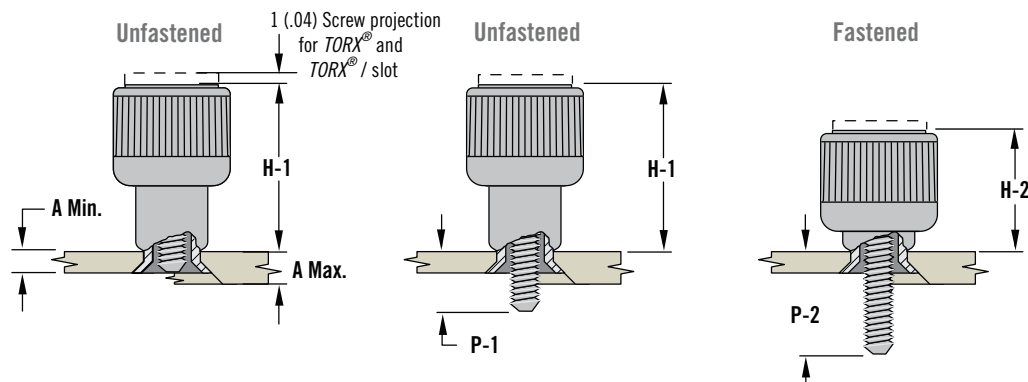

Installation Styles

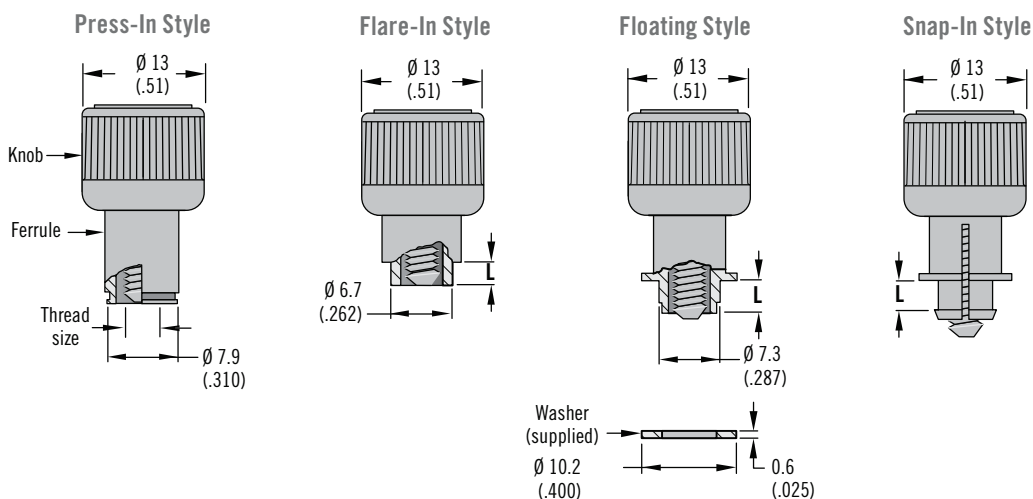

TORX® is a registered trademark of Acument™ Intellectual Properties, LLC

Dimensions in millimeters (inch) unless otherwise stated

Installation Style	Knob Height		Outer Panel Dimensions		B	Total Float	Flange Length L	Screw Projection Beyond Outer Surface of Panel		Part Number								
	H-1	H-2	A Min.	A Max.				P-1	P-2	Slotted Recess	Phillips Recess	TORX® Recess	TORX® / Slot Combination	Phillips / Slot Combination				
Press-In Style	16.2 (.64)	11.2 (.44)	0.9 (.036)	~	~	0.8 (.03)	~	0.5 (.02)	5.6 (.22)	47-60-301-24	47-60-321-24	47-60-341-20	47-60-361-20	47-60-381-20				
								2 (.08)	7.1 (.28)	47-61-301-24	47-61-321-24	47-61-341-20	47-61-361-20	47-61-381-20				
								3.8 (.15)	8.9 (.35)	47-62-301-24	47-62-321-24	47-62-341-20	47-62-361-20	47-62-381-20				
								5.3 (.21)	10.4 (.41)	47-63-301-24	47-63-321-24	47-63-341-20	47-63-361-20	47-63-381-20				
Flare-In Style	15.6 (.61)	10.5 (.41)	1.5 (.058)	3.2 (.125)	0.4 (.015)	0.9 (.03)	1.8 (.070)	1 (.04)	6 (.24)	47-10-302-14	47-10-322-14	47-10-342-10	47-10-362-10	47-10-382-10				
			3.2 (.126)	4.8 (.189)	1.6 (.062)		3.4 (.135)	2.8 (.11)	7.6 (.3)	47-10-304-14	47-10-324-14	47-10-344-10	47-10-364-10	47-10-384-10				
			4.8 (.189)	6.4 (.250)	3.2 (.125)		5 (.197)	4.3 (.17)	9.2 (.36)	47-10-306-14	47-10-326-14	47-10-346-10	47-10-366-10	47-10-386-10				
			6.3 (.251)	7.9 (.312)	4.8 (.189)		6.6 (.260)	5.8 (.23)	10.8 (.43)	47-10-308-14	47-10-328-14	47-10-348-10	47-10-368-10	47-10-388-10				
			1.5 (.058)	3.2 (.125)	0.4 (.015)		1.8 (.07)	2.8 (.11)	7.6 (.3)	47-11-302-14	47-11-322-14	47-11-342-10	47-11-362-10	47-11-382-10				
			3.2 (.126)	4.8 (.189)	1.6 (.062)		1.8 (.07)	4.3 (.17)	9.2 (.36)	47-12-302-14	47-12-322-14	47-12-342-10	47-12-362-10	47-12-382-10				
			4.8 (.189)	6.4 (.250)	3.2 (.125)		1.8 (.07)	5.8 (.23)	10.8 (.43)	47-13-302-14	47-13-322-14	47-13-342-10	47-13-362-10	47-13-382-10				
			3.2 (.126)	4.8 (.189)	1.6 (.062)		3.4 (.135)	4.3 (.17)	9.2 (.36)	47-11-304-14	47-11-324-14	47-11-344-10	47-11-364-10	47-11-384-10				
			4.8 (.189)	6.4 (.250)	3.2 (.125)		3.4 (.135)	5.8 (.23)	10.8 (.43)	47-12-304-14	47-12-324-14	47-12-344-10	47-12-364-10	47-12-384-10				
			5 (.197)	5.8 (.23)	10.8 (.43)		5 (.197)	5.8 (.23)	10.8 (.43)	47-11-306-14	47-11-326-14	47-11-346-10	47-11-366-10	47-11-386-10				
			Floating Style	16 (.63)	11.2 (.44)		~	0.8 (.031)	2.3 (.09)	2.3 (.09)	3.2 (.127)	2.3 (.09)	7.1 (.28)	47-10-310-14	47-10-330-14	47-10-350-10	47-10-370-10	47-10-390-10
							0.8 (.031)	1.6 (.063)	3.1 (.121)		3.2 (.127)	3.8 (.15)	8.9 (.35)	47-11-310-14	47-11-330-14	47-11-350-10	47-11-370-10	47-11-390-10
1.6 (.063)	2.4 (.094)	3.9 (.153)				3.2 (.127)	5.6 (.22)	10.4 (.41)	47-12-310-14		47-12-330-14	47-12-350-10	47-12-370-10	47-12-390-10				
0.8 (.031)	1.6 (.063)	3.1 (.121)				4 (.158)	2.3 (.09)	7.1 (.28)	47-10-311-14		47-10-331-14	47-10-351-10	47-10-371-10	47-10-391-10				
1.6 (.063)	2.4 (.094)	3.9 (.153)				4 (.158)	3.8 (.15)	8.9 (.35)	47-11-311-14		47-11-331-14	47-11-351-10	47-11-371-10	47-11-391-10				
0.8 (.031)	1.6 (.063)	3.1 (.121)				4 (.158)	5.6 (.22)	10.4 (.41)	47-12-311-14		47-12-331-14	47-12-351-10	47-12-371-10	47-12-391-10				
1.6 (.063)	2.4 (.094)	3.9 (.153)				4.8 (.190)	3.8 (.15)	8.9 (.35)	47-10-312-14		47-10-332-14	47-10-352-10	47-10-372-10	47-10-392-10				
0.8 (.031)	1.6 (.063)	3.1 (.121)				4.8 (.190)	5.6 (.22)	10.4 (.41)	47-11-312-14		47-11-332-14	47-11-352-10	47-11-372-10	47-11-392-10				
1.6 (.063)	2.4 (.094)	3.9 (.153)				1.1 (.044)	1 (.04)	3 (.22)	47-60-310-14		47-60-330-14	47-60-350-10	47-60-370-10	47-60-390-10				
0.5 (.020)	1 (.039)	2 (.079)				1.1 (.044)	2.8 (.11)	7.1 (.28)	47-61-310-14		47-61-330-14	47-61-350-10	47-61-370-10	47-61-390-10				
1 (.039)	1.6 (.063)	2.6 (.103)				1.1 (.044)	4.3 (.17)	8.9 (.35)	47-63-310-14		47-63-330-14	47-63-350-10	47-63-370-10	47-63-390-10				
1.6 (.063)	2.5 (.098)	3.5 (.138)				1.1 (.044)	5.8 (.23)	10.4 (.41)	47-63-310-14		47-63-330-14	47-63-350-10	47-63-370-10	47-63-390-10				
Snap-In Style	15.7 (.62)	11.2 (.44)	0.5 (.020)	1 (.039)	2 (.079)	0.9 (.03)	1.1 (.044)	2.8 (.11)	7.1 (.28)	47-61-310-14	47-61-330-14	47-61-350-10	47-61-370-10	47-61-390-10				
			1 (.039)	1.6 (.063)	2.6 (.103)		1.1 (.044)	4.3 (.17)	8.9 (.35)	47-63-310-14	47-63-330-14	47-63-350-10	47-63-370-10	47-63-390-10				
			1.6 (.063)	2.5 (.098)	3.5 (.138)		1.1 (.044)	5.8 (.23)	10.4 (.41)	47-63-310-14	47-63-330-14	47-63-350-10	47-63-370-10	47-63-390-10				
			0.5 (.020)	1 (.039)	2 (.079)		1.7 (.068)	2.8 (.11)	7.1 (.28)	47-60-312-14	47-60-332-14	47-60-352-10	47-60-372-10	47-60-392-10				
			1 (.039)	1.6 (.063)	2.6 (.103)		1.7 (.068)	4.3 (.17)	8.9 (.35)	47-61-312-14	47-61-332-14	47-61-352-10	47-61-372-10	47-61-392-10				
			1.6 (.063)	2.5 (.098)	3.5 (.138)		1.7 (.068)	5.8 (.23)	10.4 (.41)	47-62-312-14	47-62-332-14	47-62-352-10	47-62-372-10	47-62-392-10				
			0.5 (.020)	1 (.039)	2 (.079)		2.6 (.103)	2.8 (.11)	7.1 (.28)	47-60-314-14	47-60-334-14	47-60-354-10	47-60-374-10	47-60-394-10				
			1 (.039)	1.6 (.063)	2.6 (.103)		2.6 (.103)	4.3 (.17)	8.9 (.35)	47-61-314-14	47-61-334-14	47-61-354-10	47-61-374-10	47-61-394-10				
			1.6 (.063)	2.5 (.098)	3.5 (.138)		2.6 (.103)	5.8 (.23)	10.4 (.41)	47-62-314-14	47-62-334-14	47-62-354-10	47-62-374-10	47-62-394-10				

Part numbers in shaded rows (shown in table) are fully retracting in minimum panel thickness



To add a black powder coated finish, change the part number from the table as shown:

- Change 1 to 5: 47-80-102-14
47-80-102-54
- Change 2 to 6: 47-80-102-24
47-80-102-64

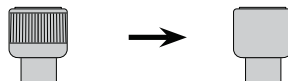

For a smooth knob, change the part number from the table as shown:

- Change 0 to 1: 47-90-161-20
47-90-161-21
- Change 4 to 5: 47-90-101-24
47-90-101-25

Part Number

See table

All screw part numbers shown in table are for a natural knob finish and a knurled knob

For black finish and smooth knob options, minimums may apply