



# 47 Captive Screws

Styled knob series · 1/4-20 thread size

- Designed for hand operation
- Spring ejected
- Wide variety of sizes, recesses and installation options

### Material and Finish

Ferrule:

Press-in: Hardened carbon steel, zinc plate, chromate, plus sealer  
 Flare-in and Floating: Aluminum, natural

Knob: Aluminum, natural or black powder coated

Screw: Hardened carbon steel, zinc plated, chromate, plus sealer

### Installation Notes

See pages 392 - 393, 497

### Notes

 To ensure you receive **SOUTHCO**® quality parts, look for the segmented circle

### Recess Styles



### Knob Height and Screw Projection

(Flare-in style shown)

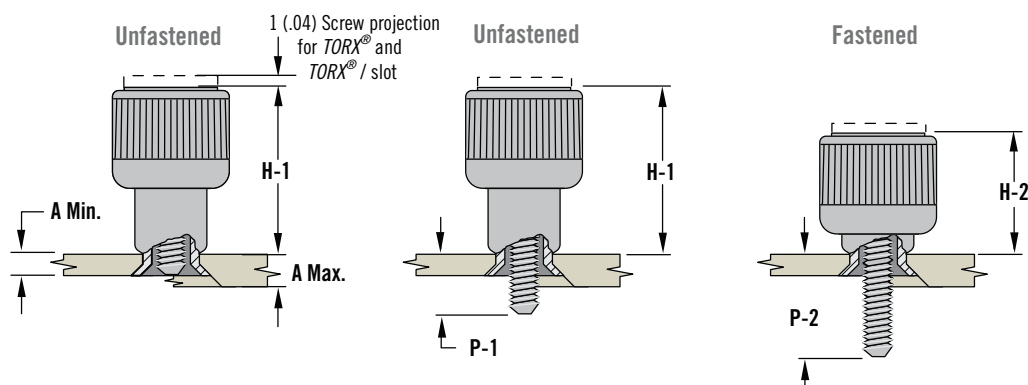

### Installation Styles

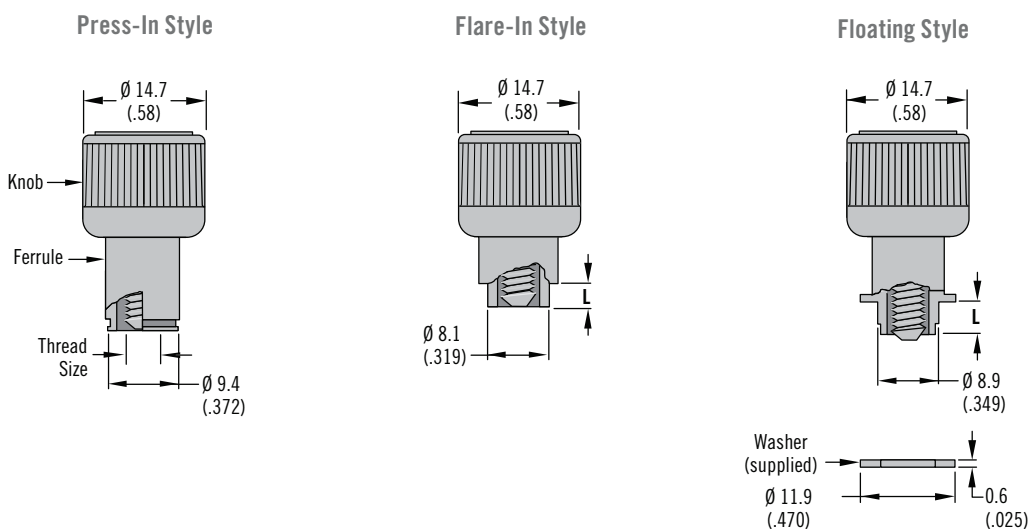

TORX® is a registered trademark of Acument™ Intellectual Properties, LLC

Dimensions in millimeters (inch) unless otherwise stated

Installation Style	Knob Height		Outer Panel Dimensions		B	Total Float	Flange Length L	Screw Projection Beyond Outer Surface of Panel		Part Number				
	H-1	H-2	A Min.	A Max.				P-1	P-2	Slotted Recess	Phillips Recess	TORX® Recess	TORX® / Slot Combination	Phillips / Slot Combination
	<b>Press-In Style</b>	20 (.79)	13.4 (.53)	0.9 (.036)				~	~	0.8 (.03)	~	0.5 (.02)	7.1 (.28)	47-60-601-24
								2.1 (.08)	8.7 (.34)	47-61-601-24	47-61-621-24	47-61-641-20	47-61-661-20	47-61-681-20
								3.7 (.15)	10.3 (.41)	47-62-601-24	47-62-621-24	47-62-641-20	47-62-661-20	47-62-681-20
								5.3 (.21)	11.9 (.47)	47-63-601-24	47-63-621-24	47-63-641-20	47-63-661-20	47-63-681-20
<b>Flare-In Style</b>	19.3 (.76)	12.7 (.50)	1.5 (.058)	3.2 (.125)	0.4 (.015)	0.9 (.03)	1.8 (.070)	1.2 (.05)	7.8 (.31)	47-10-602-14	47-10-622-14	47-10-642-10	47-10-662-10	47-10-682-10
			3.2 (.126)	4.8 (.189)	1.6 (.062)		3.4 (.135)	2.8 (.11)	9.4 (.37)	47-10-604-14	47-10-624-14	47-10-644-10	47-10-664-10	47-10-684-10
			4.8 (.188)	6.4 (.250)	3.2 (.125)		5 (.197)	4.4 (.17)	11 (.43)	47-10-606-14	47-10-626-14	47-10-646-10	47-10-666-10	47-10-686-10
			6.4 (.251)	7.9 (.312)	4.8 (.189)		6.6 (.260)	6 (.24)	12.6 (.50)	47-10-608-14	47-10-628-14	47-10-648-10	47-10-668-10	47-10-688-10
			1.5 (.058)	3.2 (.125)	0.4 (.015)		1.8 (.070)	2.8 (.11)	9.4 (.37)	47-11-602-14	47-11-622-14	47-11-642-10	47-11-662-10	47-11-682-10
			3.2 (.126)	4.8 (.189)	1.6 (.062)		3.4 (.135)	4.4 (.17)	11 (.43)	47-12-602-14	47-12-622-14	47-12-642-10	47-12-662-10	47-12-682-10
			4.8 (.189)	6.4 (.250)	3.2 (.125)		5 (.197)	6 (.24)	12.6 (.50)	47-13-602-14	47-13-622-14	47-13-642-10	47-13-662-10	47-13-682-10
			6.4 (.251)	7.9 (.312)	4.8 (.189)		6.6 (.260)	6 (.24)	12.6 (.50)	47-11-604-14	47-11-624-14	47-11-644-10	47-11-664-10	47-11-684-10
			1.5 (.058)	3.2 (.125)	0.4 (.015)		1.8 (.070)	4.4 (.17)	11 (.43)	47-12-604-14	47-12-624-14	47-12-644-10	47-12-664-10	47-12-684-10
			3.2 (.126)	4.8 (.189)	1.6 (.062)		3.4 (.135)	6 (.24)	12.6 (.50)	47-11-606-14	47-11-626-14	47-11-646-10	47-11-666-10	47-11-686-10
			4.8 (.189)	6.4 (.250)	3.2 (.125)		5 (.197)	6 (.24)	12.6 (.50)	47-11-606-14	47-11-626-14	47-11-646-10	47-11-666-10	47-11-686-10
			6.4 (.251)	7.9 (.312)	4.8 (.189)		6.6 (.260)	6 (.24)	12.6 (.50)	47-11-606-14	47-11-626-14	47-11-646-10	47-11-666-10	47-11-686-10
			8.0 (.315)	9.6 (.38)	2.0 (.079)		8.0 (.315)	2.0 (.079)	12.0 (.47)	47-11-608-14	47-11-628-14	47-11-648-10	47-11-668-10	47-11-688-10
			10.0 (.394)	11.6 (.457)	4.0 (.157)		10.0 (.394)	4.0 (.157)	16.0 (.63)	47-11-610-14	47-11-630-14	47-11-650-10	47-11-670-10	47-11-690-10
<b>Floating Style</b>	20 (.79)	13.3 (.52)	~	0.8 (.031)	2.3 (.090)	2.3 (.09)	3.2 (.127)	2.1 (.08)	8.8 (.35)	47-10-610-14	47-10-630-14	47-10-650-10	47-10-670-10	47-10-690-10
							3.7 (.15)	10.4 (.41)	47-11-610-14	47-11-630-14	47-11-650-10	47-11-670-10	47-11-690-10	
							5.3 (.21)	12 (.47)	47-12-610-14	47-12-630-14	47-12-650-10	47-12-670-10	47-12-690-10	
			0.8 (.031)	1.6 (.063)	3.1 (.122)		4 (.158)	2.1 (.08)	8.8 (.35)	47-10-611-14	47-10-631-14	47-10-651-10	47-10-671-10	47-10-691-10
							3.7 (.15)	10.4 (.41)	47-11-611-14	47-11-631-14	47-11-651-10	47-11-671-10	47-11-691-10	
							5.3 (.21)	12 (.47)	47-12-611-14	47-12-631-14	47-12-651-10	47-12-671-10	47-12-691-10	
			1.6 (.063)	2.4 (.094)	3.9 (.153)		4.8 (.190)	3.7 (.15)	10.4 (.41)	47-10-612-14	47-10-632-14	47-10-652-10	47-10-672-10	47-10-692-10
							5.3 (.21)	12 (.47)	47-11-610-14	47-11-632-14	47-11-652-10	47-11-672-10	47-11-692-10	

Part numbers in shaded rows (shown in table) are fully retracting in minimum panel thickness

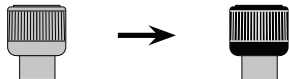

To add a black powder coated finish, change the part number from the table as shown:

- Change 1 to 5: 47-80-102-14  
47-80-102-54
- Change 2 to 6: 47-80-102-24  
47-80-102-64

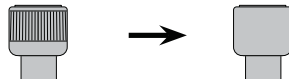

For a smooth knob, change the part number from the table as shown:

- Change 0 to 1: 47-90-161-20  
47-90-161-21
- Change 4 to 5: 47-90-101-24  
47-90-101-25

**Part Number**

See table  
 All screw part numbers shown in table are for a natural knob finish and a knurled knob  
 For black finish and smooth knob options, minimums may apply