

REV.	MODIFICATION.	DATE	DRN
01	PRODUCTION RELEASE	21/01/11	SF

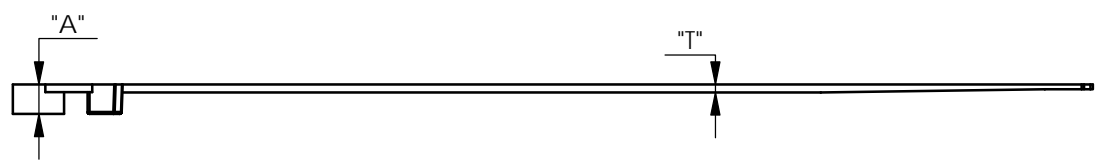
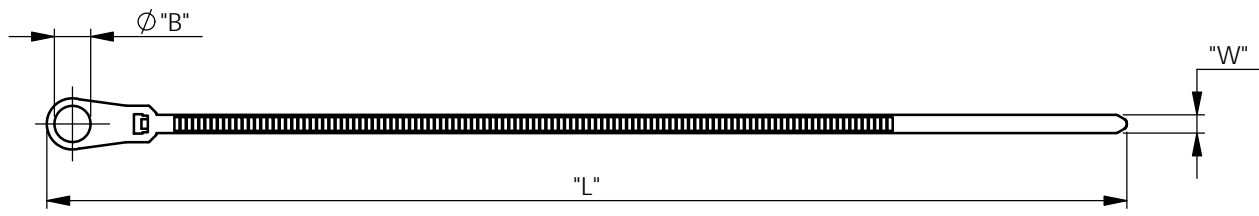

PART NUMBER	MAX LOOP TENSILE STRENGTH (N)	"L"	"W"	"T"	BUNDLE ϕ (MAX)	"A"	"B"
RG-2150-I	130	150	3.6	1.1	34	4.5	4.5
RG-2200-S	220	206	4.8	1.4	50	5.2	5.5
RG-2200-H	540	220	7.5	1.9	44	6.5	5.9
RG-2300-H		330			75		
RG-2380-H		383			101		

INFORMATION CONTAINED IN THIS DOCUMENT IS CONFIDENTIAL TO RICHCO INTERNATIONAL Co. Ltd. AND MAY NOT BE DISCLOSED OR REPRODUCED IN WHOLE OR PART WITHOUT THEIR WRITTEN CONSENT.

RICHCO, INC. WWW.RICHCO-INC.COM	ALL DIMENSIONS IN mm GENERAL TOLERANCES ± 0.25 UNLESS OTHERWISE STATED 1 DECIMAL PLACE \pm 2 DECIMAL PLACES \pm ANGULAR $\pm 1^\circ$	THIRD ANGLE
---	--	-----------------

MATERIAL: NYLON 6/6 UL94-V2(RMS-01)	COLOUR: NATURAL
--	--------------------

DESCRIPTION: SCREW MOUNT CABLE TIE	PART No: See Table
---------------------------------------	-----------------------

DRG No: 011-008	NPR No: EU10-0018	SHEET SIZE A4
--------------------	----------------------	------------------

DRN SF	DATE 29/09/10	CHKD TC	DATE 29/09/10	SCALE NTS	SHEET No. 1 OF 1
-----------	------------------	------------	------------------	--------------	---------------------