

REV.	MODIFICATION.	DATE	DRN
01	NEW DRAWING	18/10/04	NJB
02	ECN 06-277	29/11/06	NJB
03	CO2010114	06/03/08	SF
04	CO2010826	18/09/09	OW

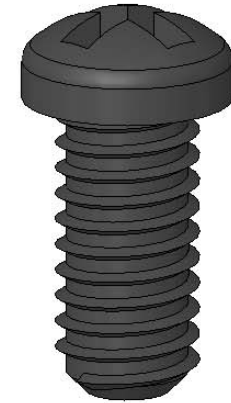
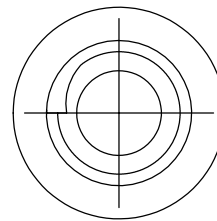
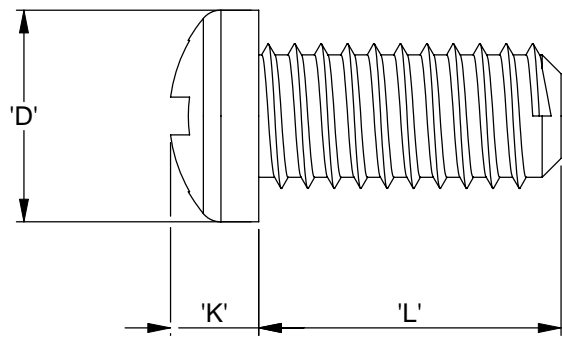

NOTES:
 1) ALTERNATE UNITS FOR REFERENCE ONLY
 2) ALL PRIMARY DIMENSIONS IN mm,
 SECONDARY DIMENSIONS IN INCHES.

INFORMATION CONTAINED IN THIS DOCUMENT IS CONFIDENTIAL TO RICHCO INTERNATIONAL Co. Ltd. AND MAY NOT BE DISCLOSED OR REPRODUCED IN WHOLE OR PART WITHOUT THEIR WRITTEN CONSENT

RICHCO, INC.
 WWW.RICHCO-INC.COM

GENERAL TOLERANCES ±0.25 [0.010]
 ARE PRIMARY UNLESS OTHERWISE STATED
 1 DECIMAL PLACE ±
 2 DECIMAL PLACES ±
 ANGULAR ±1°

PART REF:	L ±0.5 [±.02]										D	K
NSE-34812-M6-L	8.0	10.0	12.0	16.0	20.0	25.0	30.0	40.0	50.0	60.0	12.0	4.6
	[.236]	[.315]	[.394]	[.473]	[.630]	[.788]	[.985]	[1.182]	[1.575]	[1.969]	[.472]	[.181]
NSE-34812-M5-L	6.0	8.0	10.0	12.0	16.0	20.0	25.0	30.0	40.0	50.0	9.5	3.7
	[.236]	[.315]	[.394]	[.473]	[.630]	[.788]	[.985]	[1.182]	[1.575]	[1.969]	[.374]	[.145]
NSE-34812-M4-L	6.0	8.0	10.0	12.0	16.0	20.0	25.0	30.0	40.0	8.0	3.1	
	[.236]	[.315]	[.394]	[.473]	[.630]	[.788]	[.985]	[1.182]	[1.575]	[.315]	[.122]	
NSE-34812-M3-L	4.0	5.0	6.0	8.0	10.0	12.0	16.0	20.0	25.0	6.0	2.4	
	[.158]	[.197]	[.236]	[.315]	[.394]	[.473]	[.630]	[.788]	[.985]	[.236]	[.094]	

MATERIAL: NYLON 6/6 (RMS-179)				COLOUR: NATURAL	
TITLE: METRIC SCREW (DIN 34812)				PART No: NSE-34812-MX-L	
DRG No: 04-118		NPR REF:			SIZE A4
DRN NJB	DATE 18/10/04	CHKD I.C	DATE 18/10/04		SCALE NTS