

NYLON 6/6 UL94 V-2 (RMS-01) PART NUMBER	NYLON 6/6 UL94 V-0 (RMS-19) PART NUMBER	MAX NO. OF CONDUCTORS	"A" ±0.5 (.02)	"B" ±1.0 (.04)	"C" REF	"D" REF	"E" ±0.5 (.02)
FCW-29-01	FCW-29-19	30	31.5 (1.24)	45.1 (1.78)	7.7 (.30)	11.1 (.44)	18.9 (.74)
FCW-30-01	FCW-30-19		31.6 (1.24)	45.5 (1.79)	9.0 (.35)	13.1 (.52)	
FCW-40-01	FCW-40-19	40	39.3 (1.55)	53.0 (2.09)	9.3 (.37)	13.4 (.53)	19.1 (.75)
FCW-50-01	FCW-50-19	50	63.2 (2.49)	77.2 (3.04)	9.1 (.36)	13.2 (.52)	18.9 (.74)
FCW-50H-01	FCW-50H-19		64.6 (2.54)	78.2 (3.08)	15.0 (.59)	19.0 (.75)	

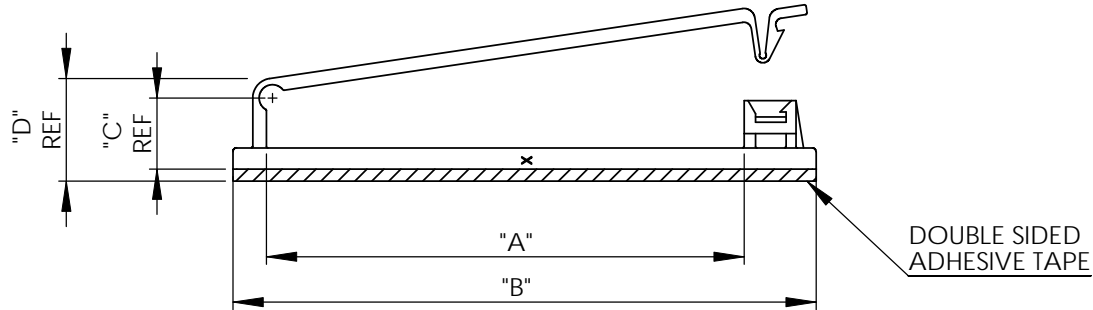
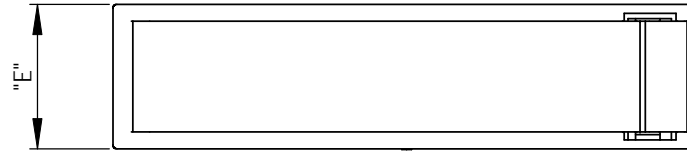

- NOTES:  
 1. COLOR: NATURAL.  
 2. TAPE: 1.6(1/16) THICK, DOUBLE SIDE ADHESIVE (RMS-350).  
 3. ALTERNATE UNITS FOR REFERENCE ONLY

TITLE: <b>FLAT CABLE CLAMP</b>						DWG IN MM[IN]	
CREATED USING SOLIDWORKS	FILE #: FCW	DWN: J.T	APP: J.T	FINAL			
TOLERANCES UNLESS NOTED .X=±0.25 ANG.±1°	SHEET: 1 OF 1	SHEET SIZE: A	DT: 11.17.06	CHKD: W.H	PART #	PRINT TYPE	
RE: RICHCO XIAMEN	RICHCO XIAMEN		RICHCO XIAMEN RICHCO_XIAMEN@RICHCO.CN (+86) 592-6884500		SEE TABLE	CA	

B	SEE C0220034 FOR CHANGES	J.T	09.03.09
A	RELEASED FOR PRODUCTION, SEE ECN XM0013	J.T	06.07.07
REV.	DESCRIPTION	ENGR.	DATE