

PART NO.	DIM. "A" ±.015(0.4)
CHDLCBST-2-01	1/8 (3.18)
CHDLCBST-3-01	3/16 (4.76)
CHDLCBST-4-01	1/4 (6.35)
CHDLCBST-5-01	5/16 (7.94)
CHDLCBST-6-01	3/8 (9.53)
CHDLCBST-7-01	7/16 (11.11)
CHDLCBST-8-01	1/2 (12.70)
CHDLCBST-9-01	9/16 (14.29)
CHDLCBST-10-01	5/8 (15.88)

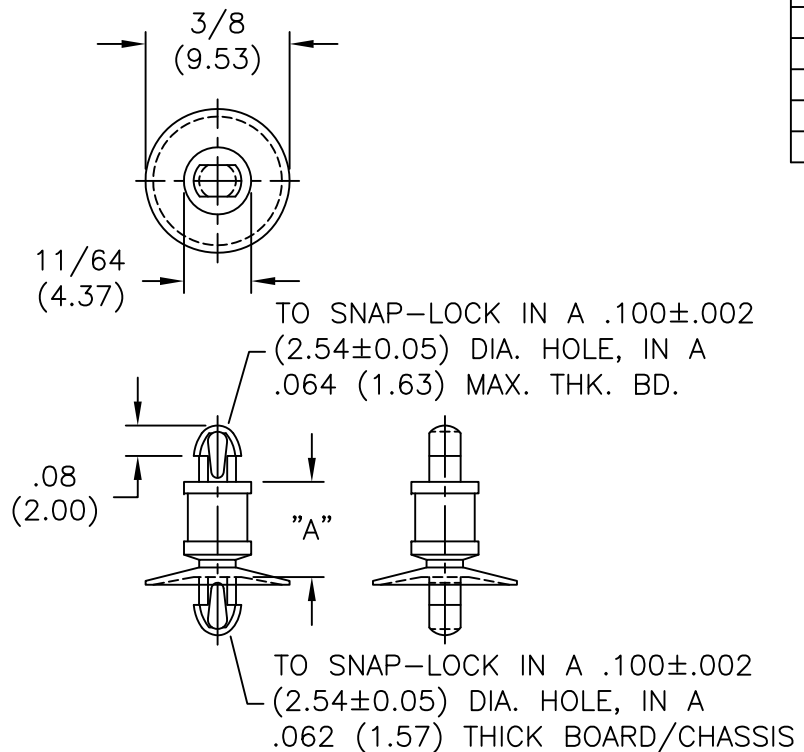

NOTES:

- MATERIAL: NYLON 6/6 UL94 V-2 (RMS-01).
NYLON 6/6 UL94 V-0 (RMS-19) AVAILABLE.
- COLOR: NATURAL.

TITLE: CUPPED HALF DUAL LOCKING CBS, TEARDROP					DWG IN IN (MM)			
TOLERANCES UNLESS NOTED .XX=±.010 .XXX=±.005 FRAC=±1/64 ANG=±1°			FILE # CHDLCBST		DWN: P.B.		APP:	
D SEE CO 200647 FOR CHANGES SK 03.29.11			MAT'L: SEE NOTES		DT: 06-21-94		DT:	
C CHANGED FILE NO. AND TITLE BLOCK SM 04.27.01			RE: RICHCO, INC.		RICHCO INC. PO BOX 804238, CHICAGO, 60680 (773) 539-4060		PART # SEE TABLE	
B MAT'L RMS-19 ADDED J.L. 12.19.97							PRINT TYPE CA	
A CONVERTED TO ACAD PB 06.21.95								
REV DESCRIPTION ENGR DATE								