

FIG 1:

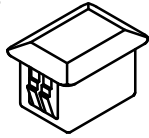

FIG 2:

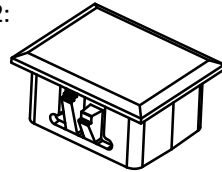

FIG 3:



REV.	MODIFICATION.	DATE	DRN
01	C0-2010730	15/07/09	OW
02	C0-2010780	25/08/09	OW
03	C0-2010881	05/02/10	OW
04	C0-2010984	07/09/10	SF
05	C0-2011040	19/01/11	SF

PART No.	"A"	"B"	"C"	"D"	"E"	"L1"	"L2"	PANEL THICKNESS	FIG	COLOUR
BPE-SC-1-01	21.5 +0.6 -0 [.85 +.024 -0]	12.8 [.50]	12 [.47]	9.3 [.37]	1.5 [.059]	13 [.512]	9.5 [.374]	1.4 - 3.5 [.550 - .138]	1	BLACK
BPE-SC-2-01	16 [.63]									
BPE-SC-3-01	34.8 [1.37]	25.8 [1.02]				26 [1.024]				
BPE-RJ45-01	17.7[.70]	14.7 [.58]	22[.87]	19.1 [.75]		19.3-20 [.760-.787]	14.9-15 [.587-.591]	0.75[.030], 1.2[.050], 1.6[.060], 2.7 [.110], 3.5 [.140]	2	GREY
BPE-LC-D-01	15 [.59]	13.2 [.52]	15 [.59]	13.2 [.52]	2 [.078]	13.5 [.532]	13.5 [.532]	0.75[.030], 1.2[.050], 1.6[.060], 2.7 [.110], 3.75 [.148]	1	BLACK
BPE-ST-1-01	Ø12 [.47]	Ø9.2 [.36]	Ø12 [.47]	7.7 [.30]	1.5 [.059]	Ø9.4 [.370]	7.9 [.311]	1.4 - 3.5 [.055 - .138]	3	

FIG 1:

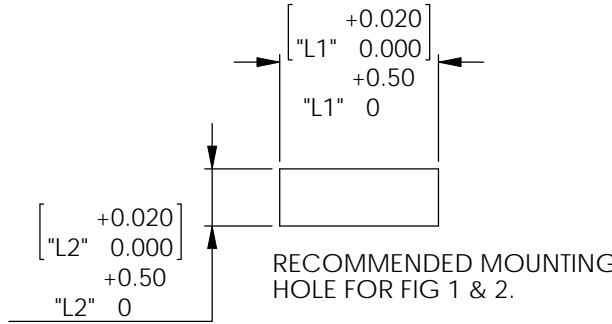
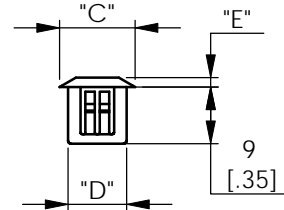
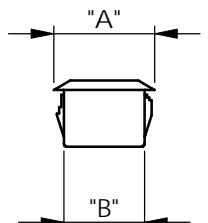

FIG 2:

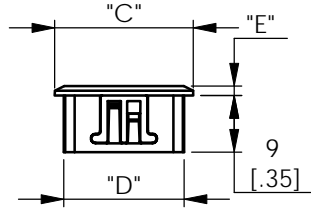
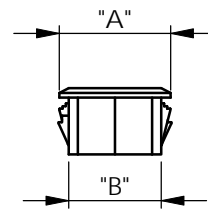
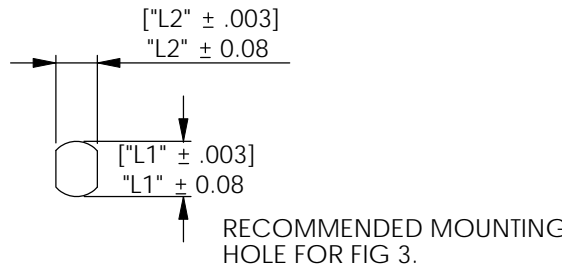
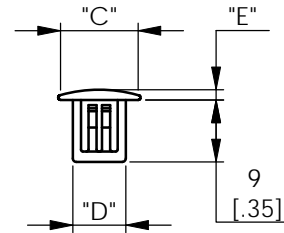
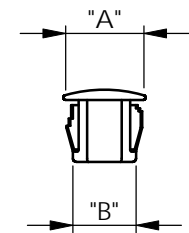

FIG 3:



- NOTES:
 1) ALTERNATE UNITS FOR REFERENCE ONLY
 2) PARTS AVAILABLE IN OTHER COLOURS BY SPECIAL ORDER
 3) PARTS AVAILABLE IN NYLON 6/6 UL94 V-0(RMS-19) BY SPECIAL ORDER, REPLACE -01 WITH -19 AT END OF PART NUMBER

INFORMATION CONTAINED IN THIS DOCUMENT IS CONFIDENTIAL TO RICHCO INTERNATIONAL Co. Ltd. AND MAY NOT BE DISCLOSED OR REPRODUCED IN WHOLE OR PART WITHOUT THEIR WRITTEN CONSENT.

RICHCO, INC.
 WWW.RICHCO-INC.COM

ALL DIMENSIONS IN mm
 GENERAL TOLERANCES ±0.25
 UNLESS OTHERWISE STATED
 1 DECIMAL PLACE ±
 2 DECIMAL PLACES ±
 ANGULAR ±1°

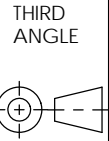

MATERIAL:
 NYLON 6/6 UL94 V-2 (RMS-01)

COLOUR:
 SEE TABLE

DESCRIPTION:
 BLANKING PLUGS

PART No:
 SEE TABLE

DRG No:
 09-071

NPR No:
 N/A

SHEET SIZE
 A4

DRN
 OW

DATE
 15/07/09

CHKD
 TC

DATE
 15/07/09

SCALE
 NTS

SHEET No.
 1 OF 1