

Steel
Zinc plated

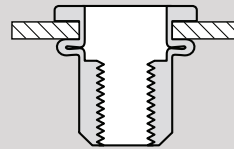
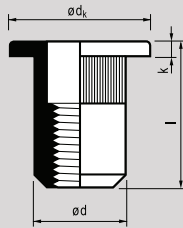

MASTERGRIP | open end | cylindrical head

$\emptyset d$		l [+0,5/-0]		Item nr.	$\emptyset d_k$ [+0/-0,5]	k \leq	$\emptyset d$ [+0/-0,2]			
[mm]		[mm]	[mm]		[mm]	[mm]	[mm]	[Nm]	[N]	[N]
M3	!	10,5	0,5-2,5	23M03C01	7,0	0,9	4,9	3,0	4.900	990
	*	11,5	2,5-4,0	C02						
$\emptyset 5,0$										
M4	=	11,0	0,5-3,0	23M04C01*	9,0	1,1	5,9	4,5	7.840	1.660
	!	14,0	3,0-5,5	C02						
$\emptyset 6,0$										
M5	=	13,0	0,5-3,0	23M05C01*	10,0	1,1	6,9	7,8	11.070	2.760
	!	16,0	3,0-5,5	C02						
$\emptyset 7,0$	*	19,0	5,5-8,0	C03						
M6	=	16,0	0,5-3,0	23M06C01*	12,0	1,6	8,9	20,0	17.640	3.430
	!	18,5	3,0-5,5	C02						
$\emptyset 9,0$	*	21,0	5,5-8,0	C03						
M8	=	17,5	0,5-3,0	23M08C01*	15,0	1,6	10,9	29,0	27.440	4.410
	=	20,0	3,0-5,5	C02						
$\emptyset 11,0$	*	22,5	5,5-8,0	C03						
	*	25,0	8,0-10,5	C04						
M10	=	19,0	0,5-3,0	23M10C01*	16,0	2,1	11,9	32,0	29.400	4.900
	=	24,0	3,0-6,0	C02						
$\emptyset 12,0$	*	27,0	6,0-9,0	C03						
	*	30,0	9,0-12,0	C04						
M12	=	25,0	1,0-4,0	23M12C01	22,0	2,1	15,9	43,7	48.020	6.860
	*	28,0	4,0-7,0	C02						
$\emptyset 16,0$	*	31,0	7,0-10,0	C03						

* these rivets of range 23-C0 are also available in blister pack.



=	identical to old program
!	improved technical data
*	addition