







For installation information please refer to the tooling overview and manuals on our website.
 Pour les conditions de pose, merci de vous référer à la description de l'outil et aux manuels disponibles sur notre site Web.
 Angaben zur Verarbeitung entnehmen Sie bitte der Geräteübersicht und den Betriebsanleitungen auf unserer Website.
 Per informazioni sull'installazione preghiamo consultare i manuali e la panoramica degli attrezzi sul nostro sito web.
 Para ver información sobre máquinas de colocación, consulte nuestra página web, apartados visión general de máquinas y manuales.

English	Français	Deutsch	Italiano	Español
Dome head	Tête plate	Flachrundkopf	Testa tonda	Cabeza alomada
Body: Low carbon steel* Zinc plated Clear trivalent passivated	Corps: Acier bas carbone* Revêtement zingué Passivation claire trivalente	Hülse: Stahl* Verzinkt Klar chromatiert, Cr6-frei	Corpo: Acciaio a basso tenore di carbonio* Zincato, Passivazione chiara trivalente	Cuerpo: Acero bajo en carbono* Zincado Pasivado claro trivalente
Stem: Medium carbon steel** Zinc plated Clear trivalent passivated	Tige: Acier au carbone** Revêtement zingué Passivation claire trivalente	Dorn: Stahl** Verzinkt Klar chromatiert, Cr6-frei	Gambo: Acciaio a medio tenore di carbonio** Zincato, Passivazione chiara trivalente	Vástago: Acero medio en carbono** Zincado, Pasivado claro trivalente

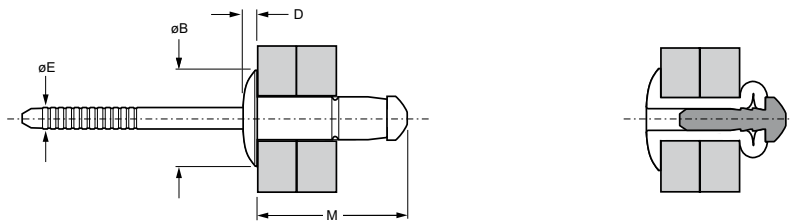
*: BS3111 Type 0, SAE 1008, DIN 1654, QSt 34-3 / BS3111 Type 0, SAE 1015 DIN 1711, RSt 38-2, Werkstoff 1.0401

** : BS3111 Type 1, SAE 1030/1037/1040/1045, Werkstoff 1.1178/1.1176/1.1186/1.1191

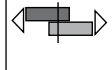

Ø nom.					M max.	ØB max.	D max.	ØE max.	 kN ⁽²⁾	 kN ⁽¹⁾	Part No/ref
	min.	max.	min.	max.							
3.2 (1/8")	1.0	3.0	3.3	3.4	9.1	6.8	1.4	2.0	1.20	1.30	0BN01-00408
	3.0	5.0			11.7				1.75		0BN01-00411
	5.0	7.0			14.0				2.50		0BN01-00414
4.0 (5/32")	1.0	3.0	4.1	4.3	10.4	8.0	1.4	2.6	2.40	2.80	0BN01-00509
	3.0	5.0			12.9				3.50		0BN01-00512
	5.0	7.0			15.7				4.10		0BN01-00516
	7.0	9.0			18.1				3.30	2.50	0BN01-00519
4.8 (3/16")	1.5	3.5	4.9	5.1	12.1	9.6	1.5	3.2	3.60	3.80	0BN01-00611
	3.5	6.0			14.7				4.20		0BN01-00614
	6.0	8.5			17.6				5.60		0BN01-00618
6.0	1.5	4.0	6.1	6.3	14.0	12.3	2.1	4.0	4.20	5.40	0BN01-06010
	3.0	6.0			17.0				5.40		0BN01-06013
	6.0	9.0			20.0				8.50		0BN01-06016
	9.0	12.0			23.0				8.50		0BN01-06019

all dimensions in mm / en millimètre / alle Maße in mm / in millimetri / en milímetros

1) typical values / valeurs moyennes / typische Werte / Valori tipici / valores típicos

2) through stem / avec tige / bei tragendem Restdorn / attraverso il gambo / con el vástago en la zona de cortadura