

## Clean room hinge 65 x 60 mm

Model : 72-7-4252

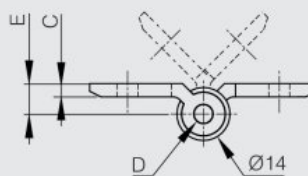

No metal-to-metal contact. Polyacetal bushings minimize particles.  
Door size: max. W600 x L800.  
Door weigh: max. 13 kg/pair.  
303 stainless steel pin.

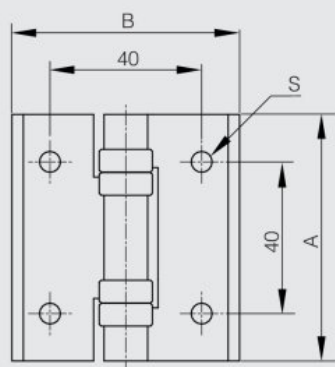

Material	aluminium
Finish	anodised
A (length)	65
D (pin diameter)	5
B (width)	60
C	3.5
E	8
Weight (g)	50
Opening angle	270
S	5.5
Material	aluminium
Functions	free swing hinges