

## Spring hinges 60 mm long - with 2 holes

Model : 71-1-3579



Opening spring force:

$M(0^\circ)$ : 0.09 N.m /  $M(90^\circ)$ : 0.07 N.m /  $M(180^\circ)$ : 0.045 N.m

Closing spring force:

$M(0^\circ)$ : 0.045 N.m /  $M(90^\circ)$ : 0.07 N.m /  $M(180^\circ)$ : 0.09 N.m

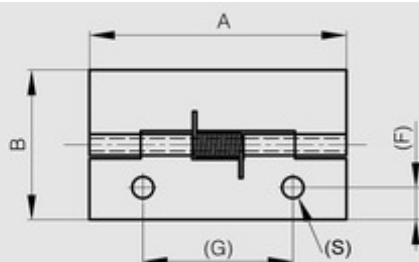

Material	steel
Finish	raw
A (length)	60
D (pin diameter)	3
B (width)	35
C	1
Weight (g)	22
G (pitch)	35
F (pitch)	7.5
Opening angle	270
Note	stainless steel opening spring
S	5
Material	steel
Functions	spring hinges