



**HINGE WITH OR WITHOUT FRICTION IN
STAINLESS STEEL - FRICTION TORQUE 8
N.M**

62-1-3733

Constant torque.

Pin in steel.

Cap in polyethylene.

Material	304 stainless steel
Finish	raw
Pin material	304 stainless steel
Note	no torque
Weight (g)	230 g
Opening angle	270 °
Functions	no torque

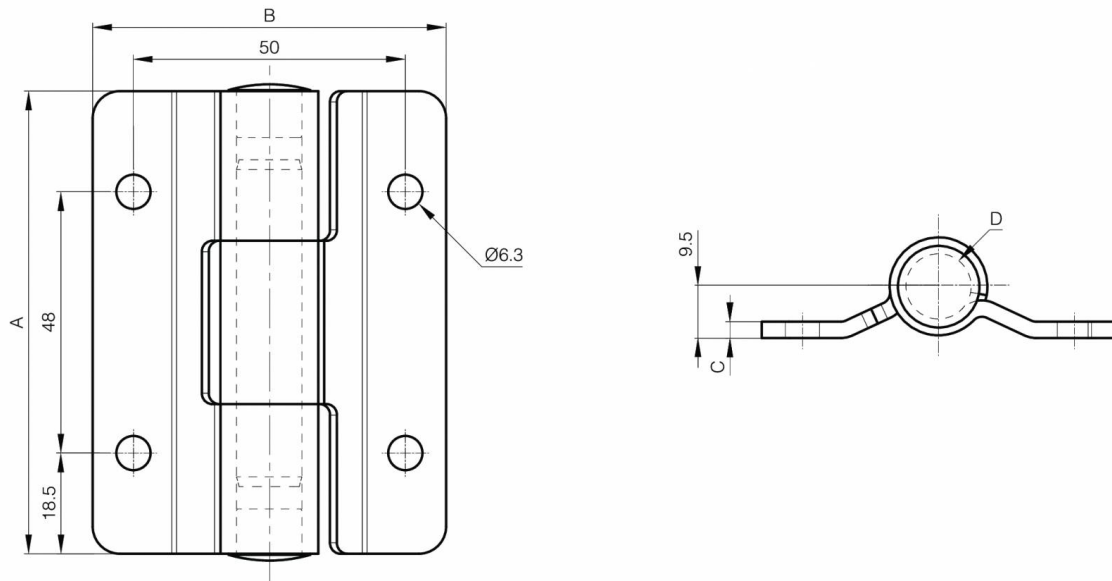

A (length)	85 mm
B (width)	65 mm
C	3 mm
D (pin diameter)	12
S	6.3 mm