

Carbon Kevlar hinges with glass fiber - 50 mm width

Model : 54-7-3605

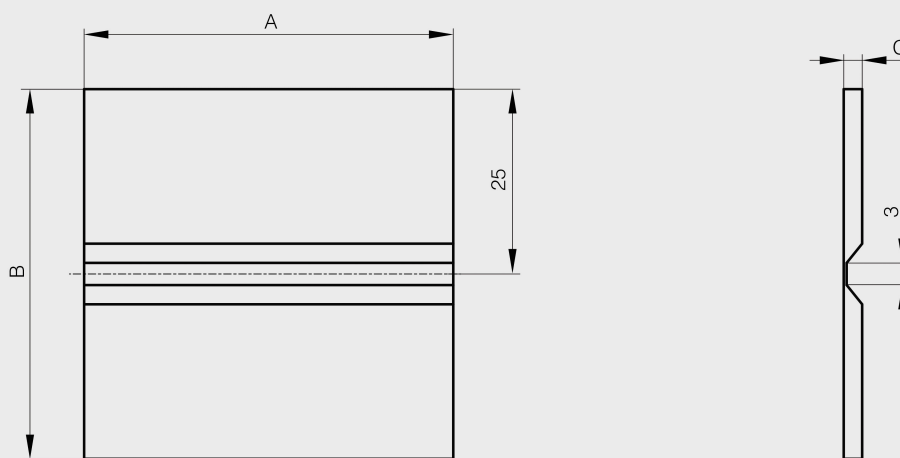

Hinge is constructed of rigid leaves and a flex unit.
The rigid leaves are a glass fibre carbon hybrid.
The Kevlar flex units are impregnated with a flexible urethane.
Design for bond or screws assembly.
No metallic component. Ultra light, ultra thin.



Material	carbon / glass fibre / Kevlar
Finish	black
A (length)	50
B (width)	50
C	2.5
Weight (g)	8
Opening angle	270
Material	polymer