

Stainless steel friction hinge - friction torque 1.9 N.m

Model : 52-7-4048

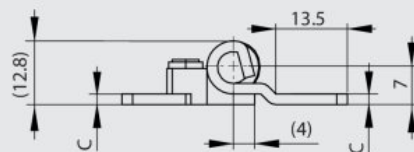

Hinge with friction torque holds lid / door in desired position.
 Operating temperature: -20°C / +60°C.

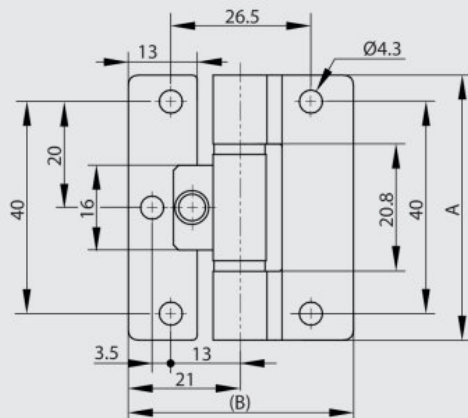

Material	304 stainless steel
Finish	polished
A (length)	50
B (width)	42.5
C	2
Weight (g)	51
Opening angle	270
Material	stainless steel
Functions	friction hinges
Torque	1.9 N.m