

Small hinges with 6 knuckles

Model : 50-7-3554

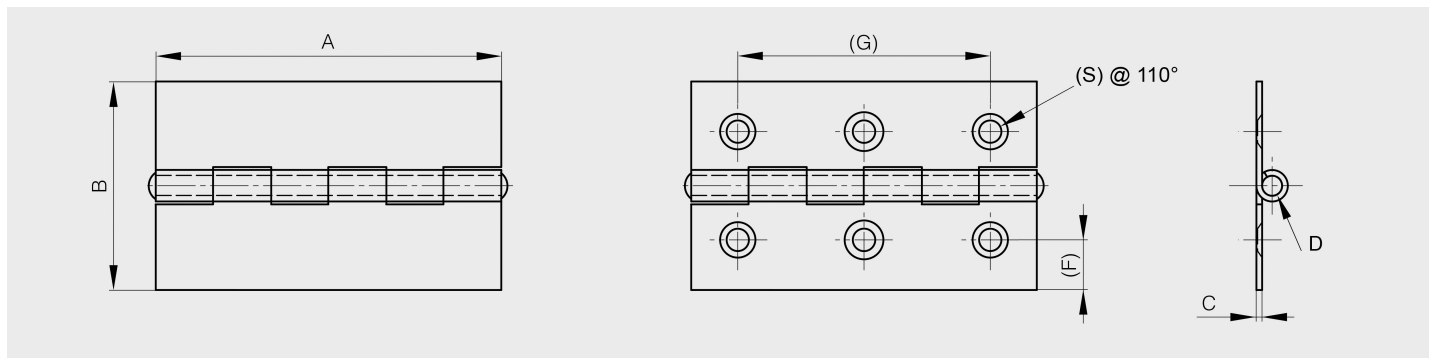

All hinges have headed pins except 50-7-3552, 50-7-3553, 50-7-3561.



Material	steel
Finish	raw
A (length)	80.5
D (pin diameter)	3.5
B (width)	45.4
C	1
Weight (g)	47
G (pitch)	59.3
F (pitch)	9.6
Opening angle	270
Note	drilled / headed pin
S	4
Material	steel
Functions	free swing hinges