

## Rolled knuckle continuous hinge - 80 mm width

Model : 42-1-4548

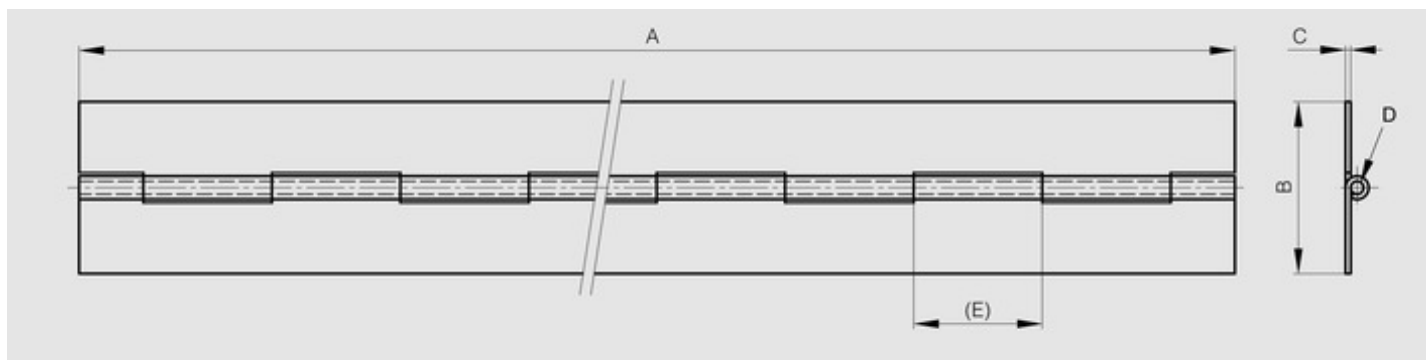

Opening angle 270°. Other lengths and pin materials are available on request.  
Specific drilling requirements are also available on request.



Material	316L stainless steel
Finish	raw
A (length)	1980
D (pin diameter)	6
B (width)	80
C	2
E	30
Weight (g)	3470
Opening angle	270
Note	drilled
Material	stainless steel
Functions	continuous hinges
Pin material	stainless steel