

## Rolled knuckle continuous hinge - 80 mm width

Model : 42-1-4547

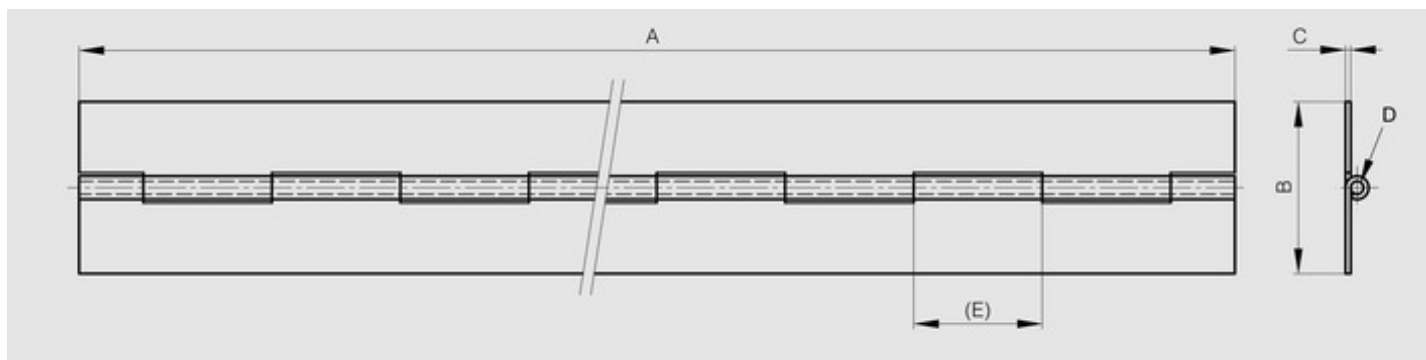

Opening angle 270°. Other lengths and pin materials are available on request.  
Specific drilling requirements are also available on request.



Material	304 stainless steel
Finish	raw
A (length)	2000
D (pin diameter)	6
B (width)	80
C	3
Weight (g)	5000
E	40
G (pitch)	60
F (pitch)	35
Opening angle	270
Note	drilled
S	5.2
Material	stainless steel
Functions	continuous hinges
Pin material	stainless steel