

Rolled knuckle continuous hinge - 32 mm width

Model : 42-1-4460

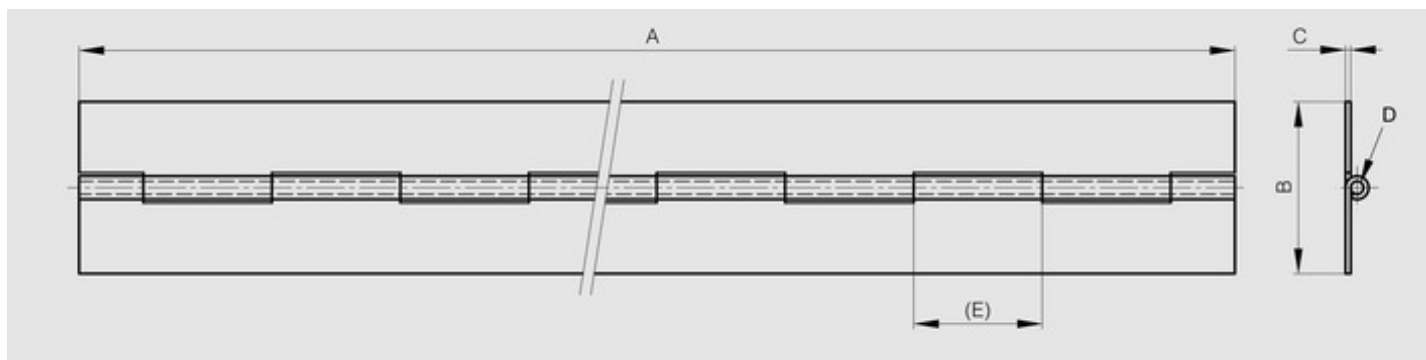

Opening angle 270°. Other lengths and pin materials are available on request.
Specific drilling requirements are also available on request.



Material	304 stainless steel
Finish	raw
A (length)	1950
D (pin diameter)	3
B (width)	32
C	1.5
Weight (g)	1030
E	12.5
Opening angle	270
Note	undrilled
Material	stainless steel
Functions	continuous hinges
Pin material	stainless steel