

## Rolled knuckle continuous hinge - 100 mm width

Model : 42-1-4458

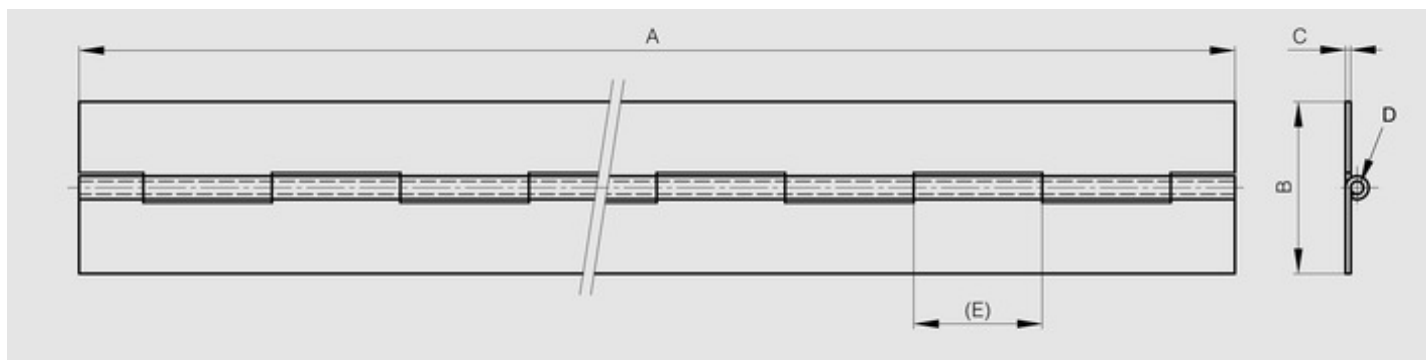

Opening angle 270°. Other lengths and pin materials are available on request.  
Specific drilling requirements are also available on request.



Material	304 stainless steel
Finish	raw
A (length)	1995
D (pin diameter)	10
B (width)	100
C	3
Weight (g)	7110
E	40
Opening angle	270
Note	undrilled
Material	stainless steel
Functions	continuous hinges
Pin material	stainless steel