

## Rolled knuckle continuous hinge - 32 mm width

Model : 42-1-4346

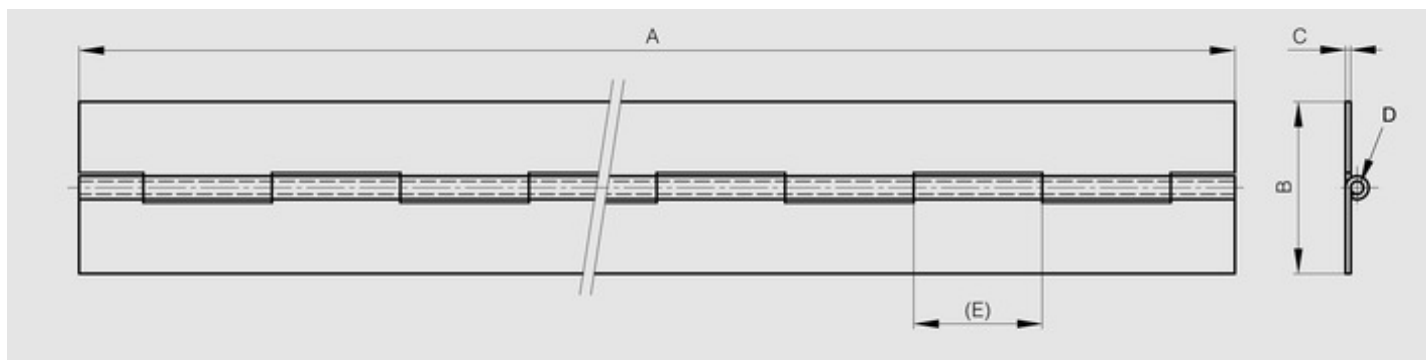

Opening angle 270°. Other lengths and pin materials are available on request.  
Specific drilling requirements are also available on request.



Material	304 stainless steel
Finish	raw
A (length)	1800
D (pin diameter)	3
B (width)	32
C	1.2
E	30
Weight (g)	790
Opening angle	270
Note	undrilled
Material	stainless steel
Functions	continuous hinges
Pin material	stainless steel