

Rolled knuckle continuous hinge - 63 mm width

Model : 42-1-4221

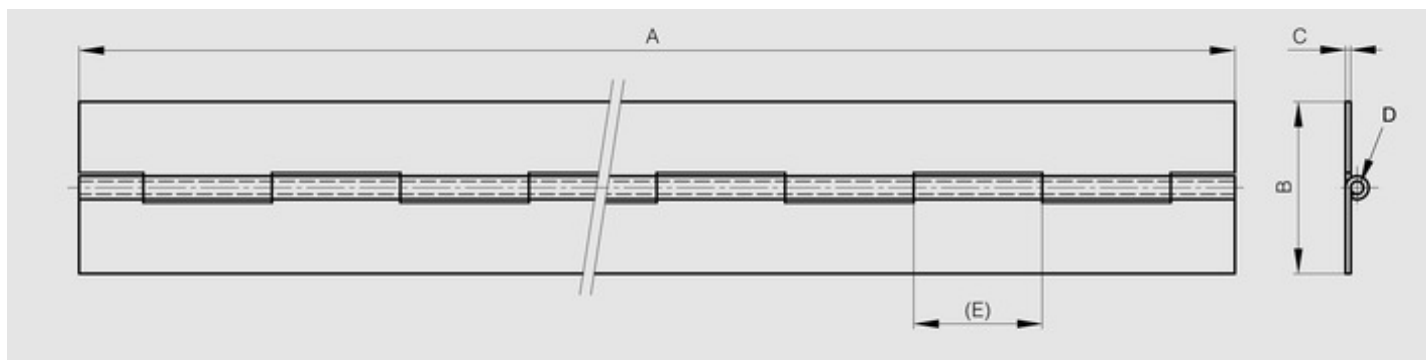

Opening angle 270°. Other lengths and pin materials are available on request.
Specific drilling requirements are also available on request.



Material	304 stainless steel
Finish	raw
A (length)	1800
B (width)	63
D (pin diameter)	4
C	1.5
E	15
Weight (g)	1800
Opening angle	270
Note	undrilled
Material	stainless steel
Functions	continuous hinges
Pin material	stainless steel