

Rolled knuckle continuous hinge - 120 mm width

Model : 42-1-4095

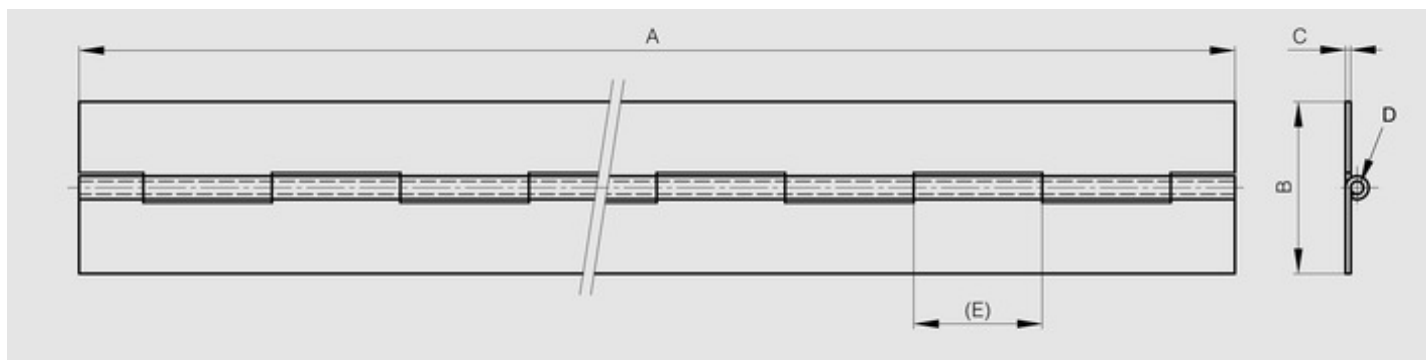

Opening angle 270°. Other lengths and pin materials are available on request.
Specific drilling requirements are also available on request.



| | |
|------------------|---------------------|
| Material | 304 stainless steel |
| Finish | raw |
| A (length) | 2100 |
| B (width) | 120 |
| D (pin diameter) | 6 |
| C | 2 |
| E | 30 |
| Weight (g) | 5000 |
| Opening angle | 270 |
| Note | undrilled |
| Material | stainless steel |
| Functions | continuous hinges |
| Pin material | stainless steel |