

Rolled knuckle continuous hinge - 76 mm width

Model : 42-1-4094

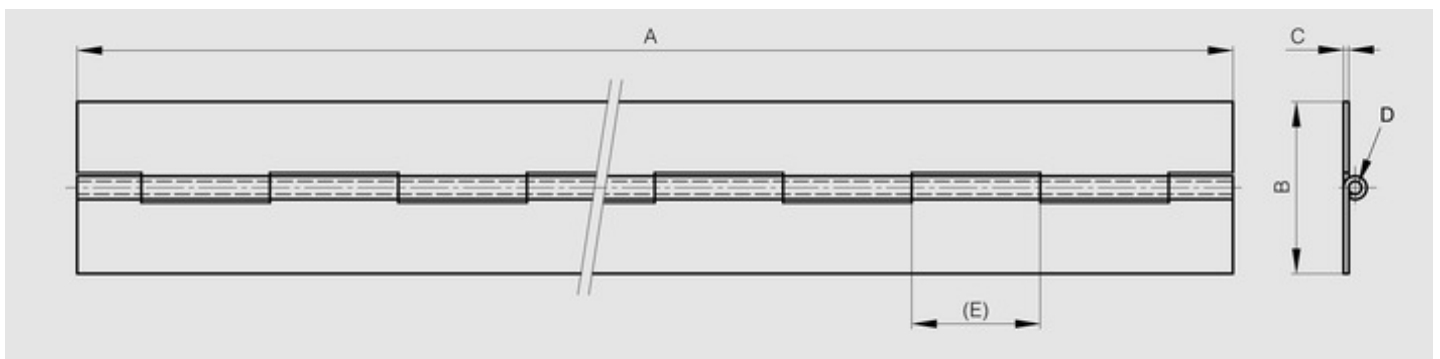

Opening angle 270°. Other lengths and pin materials are available on request.
Specific drilling requirements are also available on request.
Hinge in raw galvanised steel is made of pregalvanised steel. Therefore any cut surface is ungalvanised.



Material	304 stainless steel
Finish	raw
A (length)	2160
B (width)	76
D (pin diameter)	4
C	1.5
E	15
Weight (g)	2400
Opening angle	270
Note	undrilled
Material	stainless steel
Functions	continuous hinges
Pin material	stainless steel