

Rolled knuckle continuous hinge - 80 mm width

Model : 42-1-3304

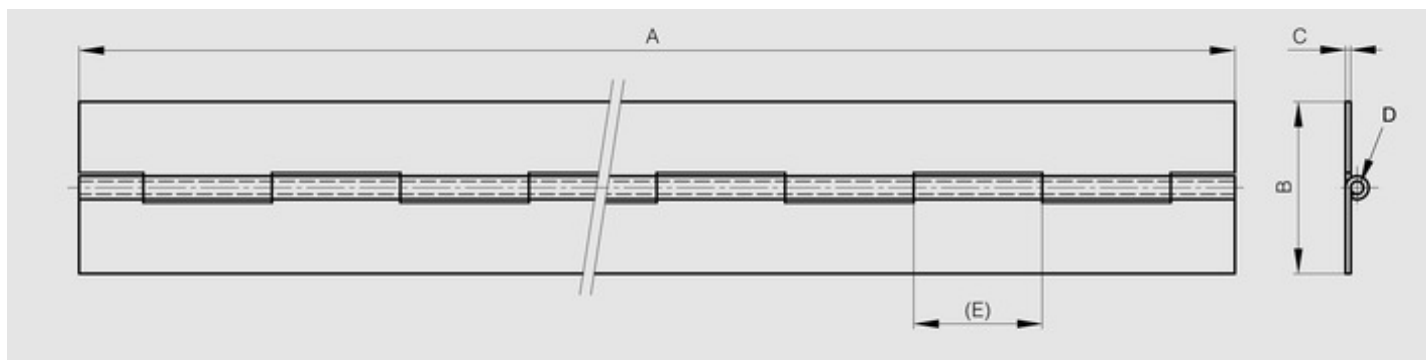

Opening angle 270°. Other lengths and pin materials are available on request.
Specific drilling requirements are also available on request.



Material	304 stainless steel
Finish	raw
A (length)	1000
D (pin diameter)	6
B (width)	80
C	3
E	40
Weight (g)	2530
Opening angle	270
Note	undrilled
Material	stainless steel
Functions	continuous hinges
Pin material	stainless steel