

Rolled knuckle continuous hinge - 100 mm width

Model : 41-1-3561

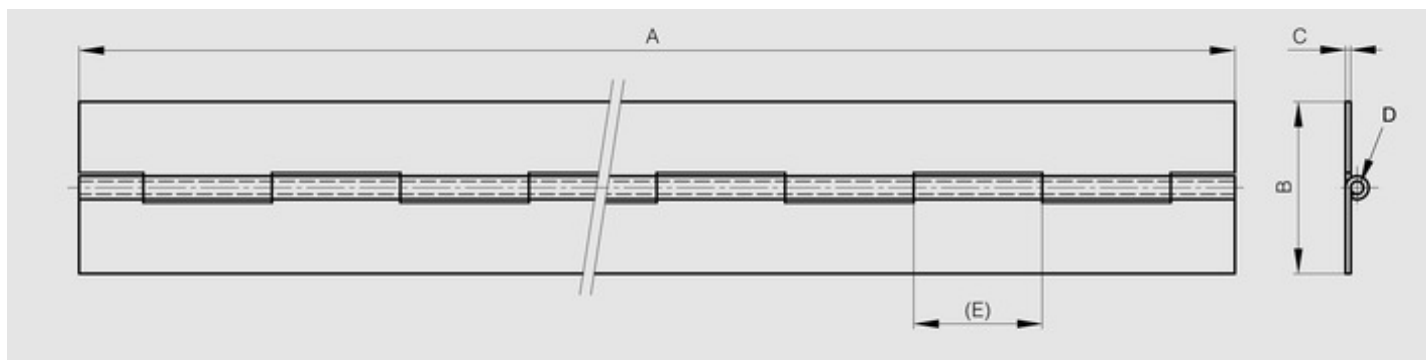

Opening angle 270°. Other lengths and pin materials are available on request.
Specific drilling requirements are also available on request.



Material	5754 alu
Finish	raw
A (length)	1000
D (pin diameter)	10
B (width)	100
C	4
E	40
Weight (g)	2030
Opening angle	270
Note	undrilled
Material	aluminium
Functions	continuous hinges
Pin material	steel