

## Rolled knuckle continuous hinge - 80 mm width

Model : 41-1-3558

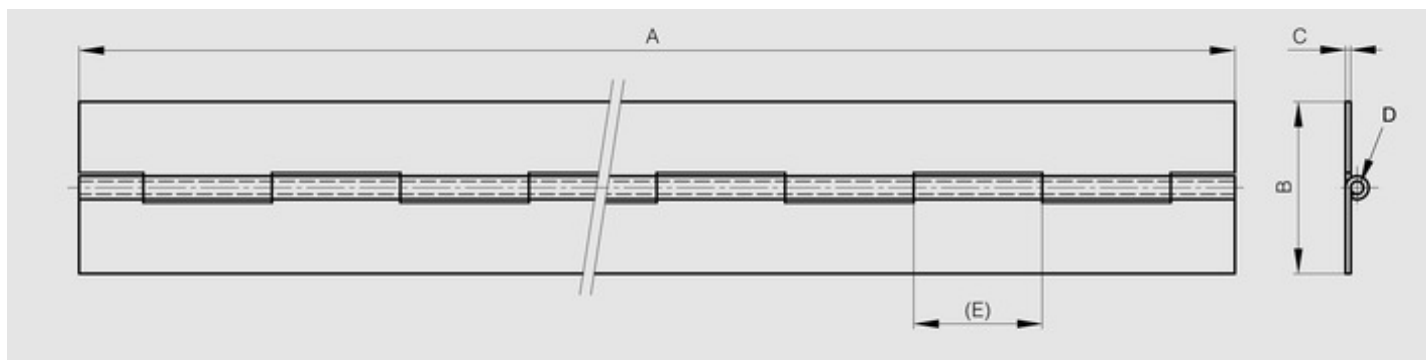

Opening angle 270°. Other lengths and pin materials are available on request.  
Specific drilling requirements are also available on request.



|                  |                   |
|------------------|-------------------|
| Material         | 5754 alu          |
| Finish           | raw               |
| A (length)       | 1995              |
| D (pin diameter) | 6                 |
| B (width)        | 80                |
| C                | 3                 |
| Weight (g)       | 1780              |
| E                | 40                |
| Opening angle    | 270               |
| Note             | undrilled         |
| Material         | aluminium         |
| Functions        | continuous hinges |
| Pin material     | aluminium         |