

## Rolled knuckle continuous hinge - 80 mm width

Model : 40-1-4774

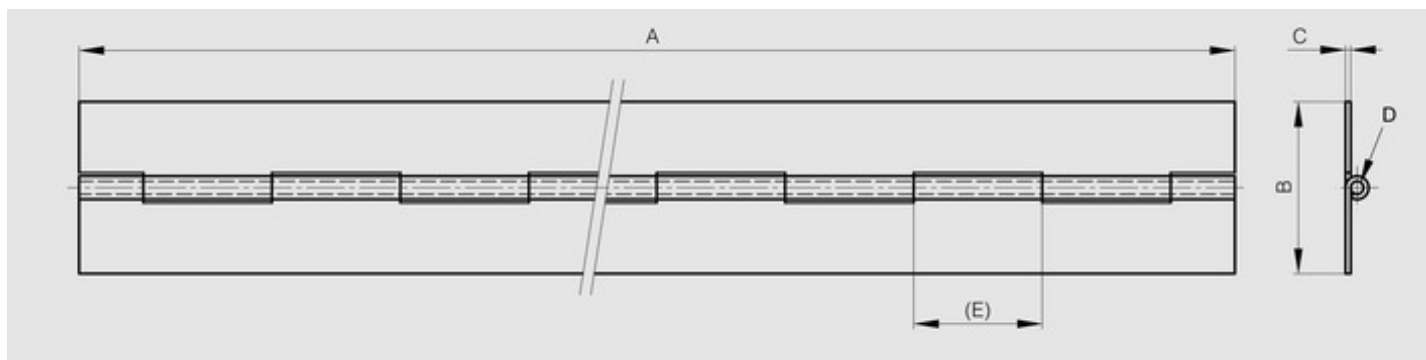

Opening angle 270°. Other lengths and pin materials are available on request.  
Specific drilling requirements are also available on request.



Material	steel
Finish	raw
A (length)	1950
D (pin diameter)	3
B (width)	80
C	1.5
E	12.5
Weight (g)	2170
Opening angle	270
Note	undrilled
Material	steel
Functions	continuous hinges
Pin material	steel