

Rolled knuckle continuous hinge - 120 mm width

Model : 40-1-4770

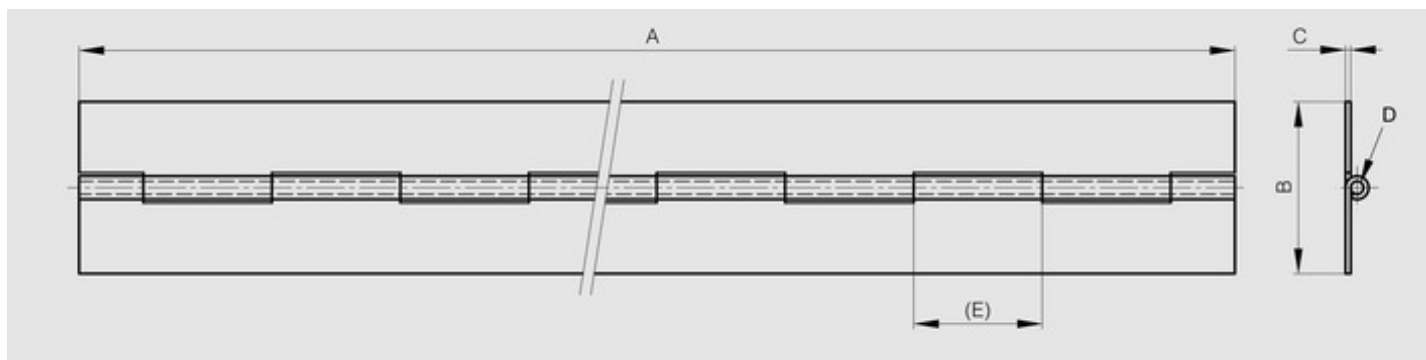

Opening angle 270°. Other lengths and pin materials are available on request.
Specific drilling requirements are also available on request.



Material	steel
Finish	raw
A (length)	1000
D (pin diameter)	10
B (width)	120
C	5
Weight (g)	6550
E	40
Opening angle	270
Note	undrilled
Material	steel
Functions	continuous hinges
Pin material	steel