

Rolled knuckle continuous hinge - 57 mm width

Model : 40-1-4680

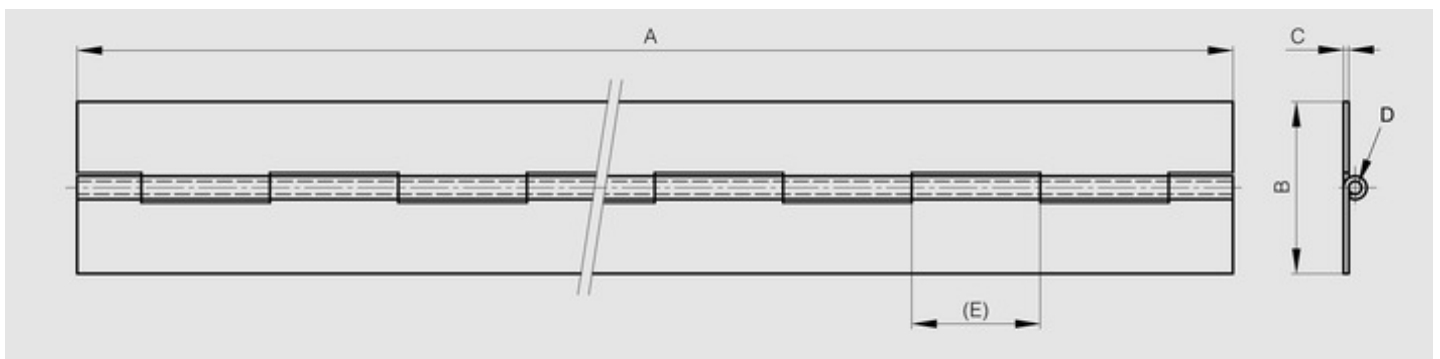

Opening angle 270°. Other lengths and pin materials are available on request.
Specific drilling requirements are also available on request.
Hinge in raw galvanised steel is made of pregalvanised steel. Therefore any cut surface is ungalvanised.



Material	galvanised steel
Finish	raw
A (length)	2160
B (width)	57
D (pin diameter)	4
C	1.5
E	15
Weight (g)	2000
Opening angle	270
Note	undrilled
Material	steel
Functions	continuous hinges
Pin material	brass