

## Rolled knuckle continuous hinge - 70 mm width

Model : 40-1-4372

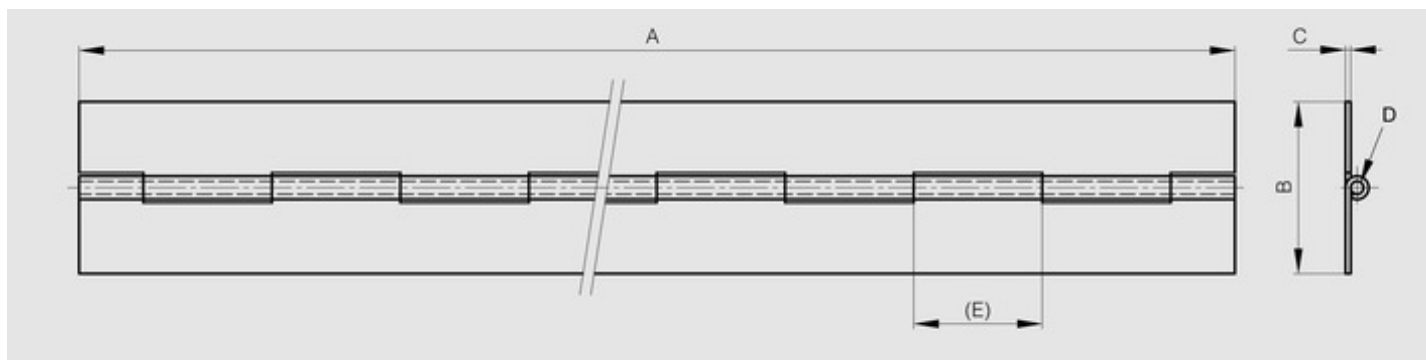

Opening angle 270°. Other lengths and pin materials are available on request.  
Specific drilling requirements are also available on request.



Material	steel
Finish	raw
A (length)	2040
B (width)	70
D (pin diameter)	6
C	2
E	30
Weight (g)	3114
Opening angle	270
Note	undrilled
Material	steel
Functions	continuous hinges
Pin material	steel