

Rolled knuckle continuous hinge - 80 mm width

Model : 40-1-3542

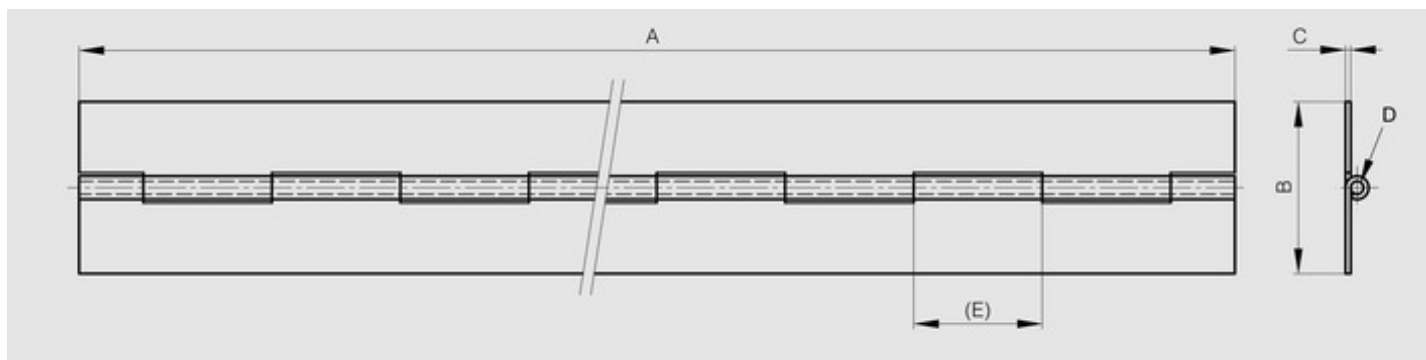

Opening angle 270°. Other lengths and pin materials are available on request.
Specific drilling requirements are also available on request.



Material	steel
Finish	raw
A (length)	2000
B (width)	80
D (pin diameter)	7.6
C	2
E	40
Weight (g)	3900
Opening angle	270
Note	undrilled
Material	steel
Functions	continuous hinges
Pin material	steel