

Rolled knuckle continuous hinge - 15 mm width

Model : 40-1-3327

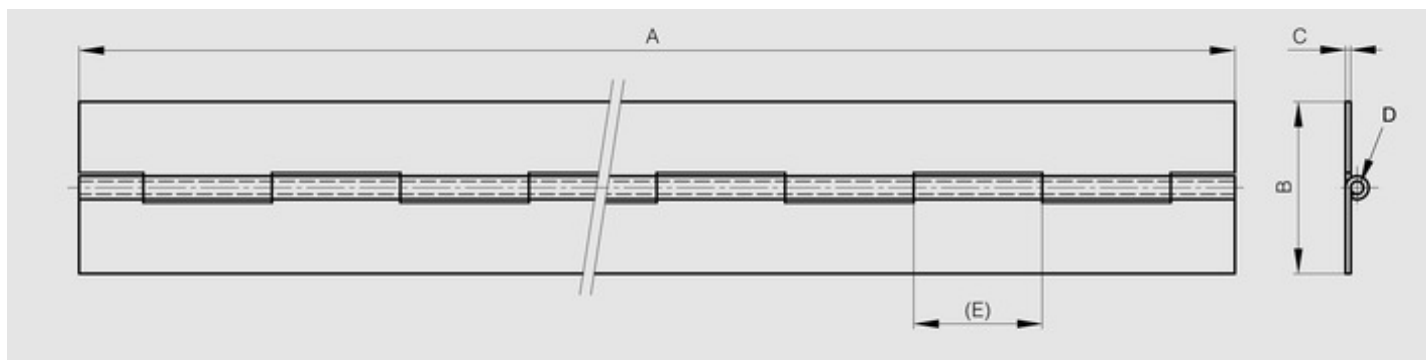

Opening angle 270°. Other lengths and pin materials are available on request.
Specific drilling requirements are also available on request.



Material	steel
Finish	raw
A (length)	2040
D (pin diameter)	1.5
B (width)	15
C	0.7
E	15
Weight (g)	260
Opening angle	270
Note	undrilled
Material	steel
Functions	continuous hinges
Pin material	steel