

Undrilled continuous hinge with one cranked leaf

Model : 39-1-3633

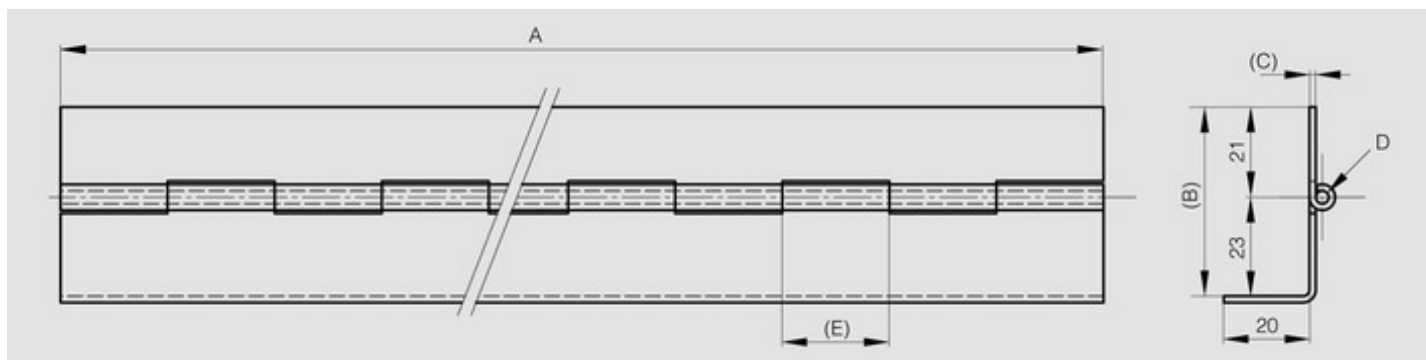

Opening angle 270°. Other lengths and pin materials are available on request.
Specific drilling requirements are also available on request.



Material	304 stainless steel
Finish	raw
A (length)	1995
D (pin diameter)	3
B (width)	44
C	1.5
E	25
Weight (g)	1787
Opening angle	270
Note	undrilled
Material	stainless steel
Functions	continuous hinges
Pin material	304 stainless steel