

Undrilled continuous hinge with one cranked leaf

Model : 39-1-3632

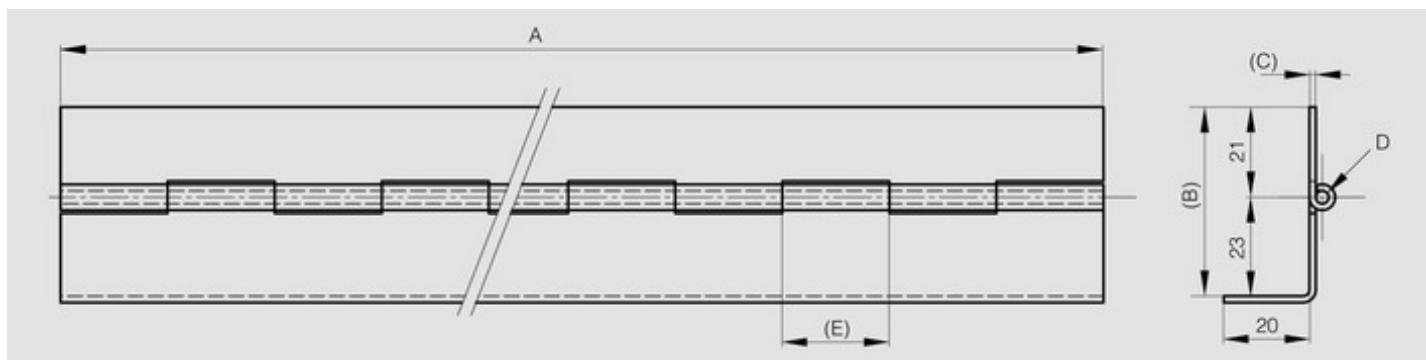

Opening angle 270°. Other lengths and pin materials are available on request.
Specific drilling requirements are also available on request.



Material	steel
Finish	zinc plated
A (length)	1995
D (pin diameter)	3
B (width)	44
C	1.5
E	25
Weight (g)	1756
Opening angle	270
Note	undrilled
Material	steel
Functions	continuous hinges
Pin material	304 stainless steel