

## Undrilled continuous hinge with one cranked leaf

Model : 39-1-3300

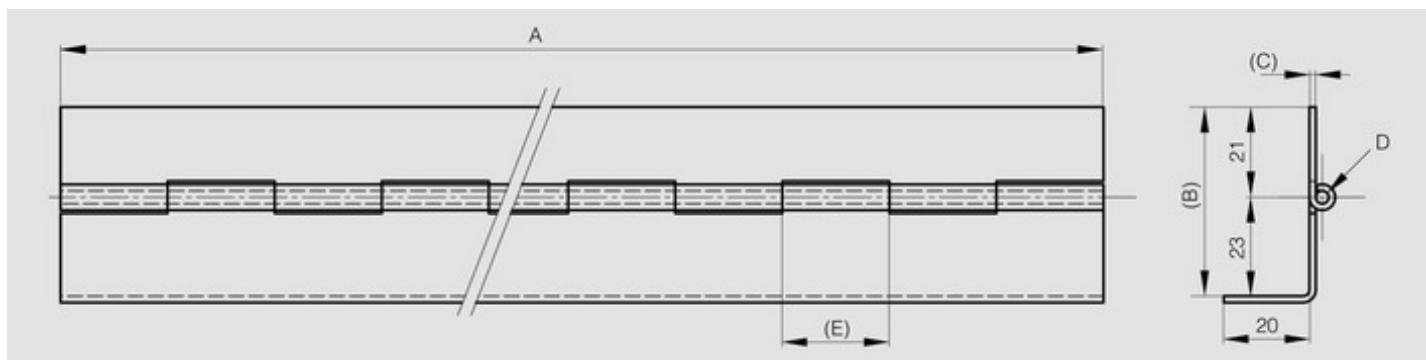

Opening angle 270°. Other lengths and pin materials are available on request.  
Specific drilling requirements are also available on request.



Material	430 stainless steel
Finish	raw
A (length)	1600
D (pin diameter)	3
B (width)	44
C	1.5
E	25
Weight (g)	1430
Opening angle	270
Note	undrilled
Material	stainless steel
Functions	continuous hinges
Pin material	304 stainless steel