

Adjustable toggle latches with strike 82 mm and 103 mm long
 Model : 16-7-4019

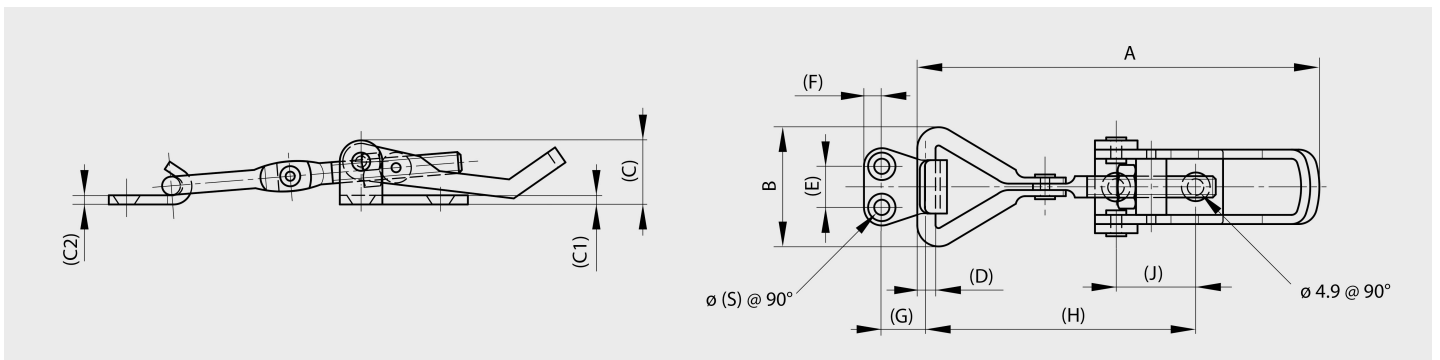

Material	steel
Finish	zinc plated
A (length)	103
B (width)	34
D (pin diameter)	5
C	16
Weight (g)	90
E	17
G (pitch)	10
F (pitch)	6.5
J	17
Opening type	swinging
H	68-86
Locking option	adjustable and padlockable
Note	103 < A < 121
S	5.2
Material	steel
C1	2.5
Latching system	toggle latches
C2	3