



## **CONCEALED SPRINGLOADED PIN HINGES**

### **A**

**12-1-4312**

Stainless steel spring.

Hinges in raw steel and zinc plated steel with a zinc plated pin.

304 stainless steel pin for hinges in stainless steel.

Circlip in 1.4122 stainless steel.

<b>A</b>	82 mm
----------	-------

<b>Note</b>	type 2
<b>Material</b>	steel
<b>Weight (g)</b>	46 g
<b>B</b>	18.2 mm
<b>C</b>	3 mm
<b>D (pin diameter)</b>	6
<b>Finish</b>	raw
<b>Nouvelle référence</b>	NEW

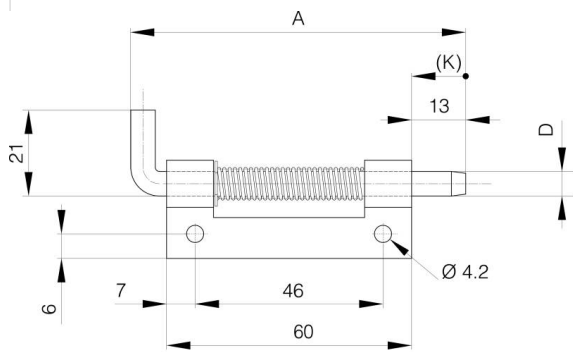

12-1-4313 & 12-1-4311 & 12-1-4315

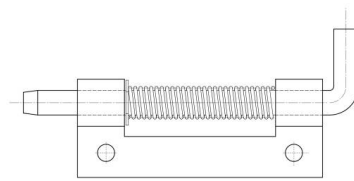

12-1-4312 & 12-1-4310 & 12-1-4314

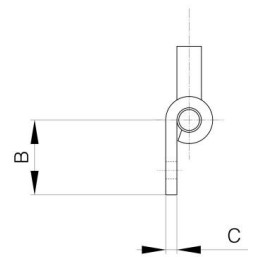

<b>K</b>	12 mm
----------	-------