

“Stay Connected” with



Bushings, Grommets, HEYcaps & Plugs

a PennEngineering® Company



## Heyco® Rubber Grommets

For Panels .063" (1,6 mm) Thick

- **Used to protect through holes.** Help eliminate sharp edges so your wires are protected and add aesthetic value to your application.
- 115 sizes available that will accommodate mounting holes ranging from .250" (6,4 mm) to holes as large as 2.375" (60,3 mm) diameter and panel thicknesses from .063" (1,6 mm) to .188" (4,8 mm).
- Rubber grommets are constructed of SBR (unless otherwise noted) with an operating temperature range of -40°F (-40°C) to 221°F (105°C).
- SBR grommets have good water resistant characteristics and are suitable for most moderate chemicals and wet or dry organic acids.
- Provide vibration dampening.

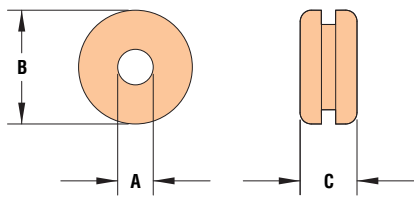

MOUNTING HOLE DIAMETER		PART NO.	DESCRIPTION	MATERIAL	PART DIMENSIONS					
in.	mm.				A Inside Diameter		B Head Diameter		C Overall Height	
		Black								
		For .063" (1,6 mm) Thick Panels								
.250	6,4	G1004	RG 250-4-2	SBR	.13	3,2	.34	8,7	.19	4,8
		G1005	RG 250-5-2	SBR	.16	4,0	.38	9,5		
		G1006	RG 250-5-2A	SBR	.16	4,0	.44	11,1	.38	9,5
.312	7,9	G1017	RG 312-6-2	SBR	.19	4,8	.41	10,3	.22	5,6
		G1018	RG 312-6-2A	Nitrile	.19	4,8	.44	11,1	.19	4,8
		G1019	RG 312-6-2B	SBR	.19	4,8	.50	12,7	.25	6,4
		G1026	RG 312-7-2	SBR	.22	5,6	.44	11,1	.19	4,8
.375	9,5	G1037	RG 375-8-2	EPDM	.25	6,4				
		G1042	RG 375-9-2	SBR	.28	7,1	.56	14,3	.25	6,4
.437	11,1	G1052	RG 437-8-2	SBR	.25	6,4	.63	15,9	.19	4,8
		G1053	RG 437-8-2A	Isoprene	.25	6,4	.63	15,9	.31	8,0
		G1061	RG 437-10-2	SBR	.31	8,0	.63	15,9	.28	7,1
.500	12,7	G1089	RG 500-12-2	SBR	.38	9,5	.63	15,9	.25	6,4
		G1090	RG 500-12-2A	SBR	.38	9,5	.69	17,5	.28	7,1
.562	14,3	G1112	RG 562-10-2	SBR	.31	8,0	.81	20,7	.31	8,0
		G1123	RG 562-14-2	SBR	.44	11,1	.75	19,1	.25	6,4
.625	15,9	G1130	RG 625-12-2	SBR	.38	9,5	.88	22,2	.31	8,0
		G1137	RG 625-16-2	SBR	.50	12,7	.81	20,7	.28	7,1
.687	17,5	G1150	RG 687-14-2	SBR	.44	11,1	.94	23,8	.31	8,0
		G1151	RG 687-14-2A	SBR	.44	11,1	.94	23,8	.35	8,8
		G1155	RG 687-16-2	SBR	.50	12,7	.88	22,2	.25	6,4
.750	19,1	G1174	RG 750-12-2	SBR	.38	9,5	1.00	25,4	.38	9,5
		G1176	RG 750-16-2	SBR	.50	12,7	.88	22,2		
		G1177	RG 750-16-2A	SBR	.50	12,7	1.00	25,4	.25	6,4
.812	20,6	G1192	RG 812-16-2	SBR	.50	12,7	1.06	27,0	.31	8,0
		G1197	RG 812-18-2	SBR	.56	14,3				
.875	22,2	G1208	RG 875-10-2	SBR	.31	8,0	1.38	34,9	.25	6,4
		G1215	RG 875-20-2	SBR	.63	15,9	1.13	28,6	.31	8,0
1.000	25,4	G1242	RG 1000-12-2	SBR	.38	9,5	1.25	31,8	.25	6,4
		G1246	RG 1000-16-2	SBR	.50	12,7				
		G1252	RG 1000-22-2	SBR	.69	17,5	1.31	33,4	.38	9,5
		G1258	RG 1000-24-2	SBR	.75	19,1	1.25	31,8	.30	7,5
1.062	27,0	G1269	RG 1062-24-2	SBR	.75	19,1	1.38	34,9	.38	9,5
1.250	31,8	G1290	RG 1250-16-2	SBR	.50	12,7	1.50	38,1		
		G1294	RG 1250-20-2	SBR	.63	15,9			.25	6,4
		G1298	RG 1250-24-2	SBR	.75	19,1	1.63	41,3		
		G1303	RG 1250-28-2	SBR	.88	22,2	1.63	41,3	.44	11,1
1.375	34,9	G1311	RG 1250-32-2	SBR	1.00	25,4	1.56	39,7	.31	8,0
		G1320	RG 1375-32-2	SBR	1.00	25,4	1.75	44,5	.44	11,1
1.500	38,1	G1347	RG 1500-36-2	SBR	1.13	28,6	1.88	47,6	.38	9,5
		G1349	RG 1500-40-2	Nitrile	1.25	31,8	1.88	47,6	.34	8,7

Standard color black.

Quick Specs

Material  
Temperature Range

SBR, Nitrile, EPDM, or Isoprene  
-40°F (-40°C) to 221°F (105°C)

“Stay Connected” with



Bushings, Grommets, HEYcaps & Plugs

a PennEngineering® Company



## Heyco® Rubber Grommets

For Panels from .063" (1,6 mm) to .125" (3,2 mm) Thick

MOUNTING HOLE DIAMETER		PART NO.	DESCRIPTION	MATERIAL	PART DIMENSIONS					
in.	mm.				A Inside Diameter		B Head Diameter		C Overall Height	
		For .063" (1,6 mm) Thick Panels (continued)								
1.750	44,5	<b>G1369</b>	RG 1750-48-2	SBR	1.50	38,1	2.13	54,0	.44	11,1
2.375	60,3	<b>G1409</b>	RG 2.375-40-2	Nitrile	1.25	31,8	2.75	69,9		
2.500	63,5	<b>G1418</b> <b>G1422</b>	RG 2.5-40-2 RG 2.5-68-2	Nitrile SBR	1.25 2.13	31,8 54,0	2.88	73,0		
		For .078" (2,0 mm) Thick Panels								
1.000	25,4	<b>G1253</b>	RG 1000-22-3	SBR	.69	17,5	1.31	33,4	.38	9,5
		For .094" (2,4 mm) Thick Panels								
.281	7,1	<b>G1010</b>	RG 281-6-3	SBR	.19	4,8	.44	11,1	.22	5,6
.312	7,9	<b>G1014</b>	RG 312-6-3	SBR	.19	4,8	.50	12,7	.28	7,1
.375	9,5	<b>G1033</b>	RG 375-4-3	SBR	.13	3,2	.50	12,7	.31	8,0
		<b>G1038</b>	RG 375-8-3	SBR	.25	6,4	.50	12,7	.25	6,4
		<b>G1039</b>	RG 375-8-3A	SBR	.25	6,4	.56	14,3	.28	7,1
.437	11,1	<b>G1062</b>	RG 437-10-3	SBR	.31	8,0	.63	15,9	.31	8,0
.750	19,1	<b>G1178</b>	RG 750-16-3	SBR	.50	12,7	.88	22,2	.34	8,7
		<b>G1179</b>	RG 750-16-3A	SBR	.50	12,7	.97	24,6	.28	7,1
1.125	28,6	<b>G1281</b>	RG 1125-28-3	SBR	.88	22,2	1.50	38,1	.34	8,7
2.000	50,8	<b>G1387</b>	RG 2000-48-3	SBR	1.50	38,1	2.38	60,3	.38	9,5
		For .110" (2,8 mm) Thick Panels								
.630	16,0	<b>G1140</b>	RG 630-16-3	SBR	.50	12,7	.81	20,6	.30	7,6
		For .125" (3,2 mm) Thick Panels								
.312	7,9	<b>G1020</b>	RG 312-6-4	SBR	.19	4,8	.44	11,8	.25	6,4
.406	10,3	<b>G1047</b>	RG 406-9-4	SBR	.28	7,1	.63	15,9	.38	9,5
.437	11,1	<b>G1056</b>	RG 437-8-4	SBR	.25	6,4	.63	15,9	.25	6,4
.500	12,7	<b>G1092</b>	RG 500-12-4	SBR	.38	9,5	.63	15,9	.31	8,0
		<b>G1093</b>	RG 500-12-4A	SBR	.38	9,5	.63	15,9	.41	10,3
.562	14,3	<b>G1114</b>	RG 562-10-4	SBR	.31	8,0	.81	20,7	.38	9,5
.625	15,9	<b>G1127</b>	RG 625-6-4	Nitrile	.19	4,8	.88	22,2	.25	6,4
		<b>G1132</b>	RG 625-12-4	SBR	.38	9,5	.88	22,2	.38	9,5
.687	17,5	<b>G1152</b>	RG 687-14-4	SBR	.44	11,1	.94	23,8	.38	9,5
.812	20,6	<b>G1188</b>	RG 812-12-4	SBR	.38	9,5	1.06	27,0		
		<b>G1193</b>	RG 812-16-4	SBR	.50	12,7	1.06	27,0		
		<b>G1198</b>	RG 812-18-4	SBR	.56	14,3	1.06	27,0		
.875	22,2	<b>G1218</b>	RG 875-20-4	SBR	.63	15,9	1.13	28,6	.31	8,0
1.000	25,4	<b>G1244</b>	RG 1000-12-4	SBR	.38	9,5	1.25	31,8		
		<b>G1247</b>	RG 1000-16-4	SBR	.50	12,7	1.25	31,8		
		<b>G1255</b>	RG 1000-22-4	SBR	.69	17,5	1.31	33,4		
1.250	31,8	<b>G1259</b>	RG 1000-24-4	EPDM	.75	19,1	1.19	30,2		
		<b>G1260</b>	RG 1000-24-4A	SBR	.75	19,1	1.25	31,8	.38	9,5
1.250	31,8	<b>G1291</b>	RG 1250-16-4	SBR	.50	12,7	1.50	38,1	.31	8,0
		<b>G1299</b>	RG 1250-24-4	SBR	.75	19,1	1.63	41,3	.31	8,0
		<b>G1304</b>	RG 1250-28-4	SBR	.88	22,2	1.63	41,3	.50	12,7

Standard color black.

- **Used to protect through holes.** Help eliminate sharp edges so your wires are protected and add aesthetic value to your application.
- 115 sizes available that will accommodate mounting holes ranging from .250" (6,4 mm) to holes as large as 2.375" (60,3 mm) diameter and panel thicknesses from .063" (1,6 mm) to .188" (4,8 mm).
- Rubber grommets are constructed of SBR (unless otherwise noted) with an operating temperature range of -40°F (-40°C) to 221°F (105°C).
- SBR grommets have good water resistant characteristics and are suitable for most moderate chemicals and wet or dry organic acids.
- Provide vibration dampening.

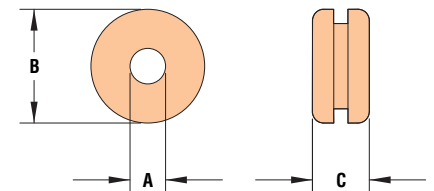

Material	SBR, Nitrile or EPDM
Temperature Range	-40°F (-40°C) to 221°F (105°C)

Quick Specs

“Stay Connected” with



Bushings, Grommets, HEYcaps & Plugs

a PennEngineering® Company



## Heyco® Rubber Grommets

For Panels .125" (3,2 mm) to .188" (4,8 mm) Thick

- **Used to protect through holes.** Help eliminate sharp edges so your wires are protected and add aesthetic value to your application.
- 115 sizes available that will accommodate mounting holes ranging from .250" (6,4 mm) to holes as large as 2.375" (60,3 mm) diameter and panel thicknesses from .063" (1,6 mm) to .188" (4,8 mm).
- Rubber grommets are constructed of SBR (unless otherwise noted) with an operating temperature range of -40°F (-40°C) to 221°F (105°C).
- SBR grommets have good water resistant characteristics and are suitable for most moderate chemicals and wet or dry organic acids.
- Provide vibration dampening.

MOUNTING HOLE DIAMETER		PART NO.	DESCRIPTION	MATERIAL	PART DIMENSIONS					
in.	mm.				A Inside Diameter		B Head Diameter		C Overall Height	

For .125" (3,2 mm) Thick Panels (continued)

1.375	34,9	<b>G1322</b>	RG 1375-32-4	SBR	1.00	25,4	1.75	44,5	.50	12,7
1.500	38,1	<b>G1350</b>	RG 1500-40-4	SBR	1.25	31,8	1.88	47,6	.41	10,3
1.625	41,3	<b>G1363</b>	RG 1625-42-4	SBR	1.31	33,4	2.00	50,8	.44	11,1
		<b>G1364</b>	RG 1625-44-4	SBR	1.38	34,9	1.88	47,6	.41	10,3
1.750	44,5	<b>G1371</b>	RG 1750-48-4	SBR	1.50	38,1	2.13	54,0	.50	12,7
2.000	50,8	<b>G1392</b>	RG 2000-56-4	SBR	1.75	44,5	2.38	60,3	.38	9,5
2.500	63,5	<b>G1423</b>	RG 2.5-68-4	SBR	2.13	54,0	2.88	73,0	.44	11,1

For .156" (4,0 mm) Thick Panels

.500	12,7	<b>G1094</b>	RG 500-12-5	SBR	.38	9,5	.69	17,5	.31	8,0
.750	19,1	<b>G1181</b>	RG 750-16-5	SBR	.50	12,7	.94	23,8	.41	10,3
1.500	38,1	<b>G1348</b>	RG 1500-38-5	SBR	1.19	30,2	1.75	44,5		

For .188" (4,8 mm) Thick Panels

.312	7,9	<b>G1022</b>	RG 312-6-6	SBR	.19	4,8	.44	11,8	.31	8,0
.375	9,5	<b>G1034</b>	RG 375-6-6	SBR	.19	4,8	.63	15,9	.38	9,5
.437	11,1	<b>G1057</b>	RG 437-8-6	SBR	.25	6,4	.63	15,9	.31	8,0
.562	14,3	<b>G1110</b>	RG 562-6-6	Nitrile	.19	4,8	.75	19,1	.31	8,0
		<b>G1115</b>	RG 562-10-6	SBR	.31	8,0	.81	20,7	.38	9,5
		<b>G1116</b>	RG 562-10-6A	SBR	.31	8,0	.81	20,7	.44	11,1
		<b>G1120</b>	RG 562-12-6	SBR	.38	9,5	.81	20,7	.38	9,5
.625	15,9	<b>G1133</b>	RG 625-12-6	SBR	.38	9,5	.88	22,2	.44	11,1
		<b>G1135</b>	RG 625-13-6	Nitrile	.40	10,2	1.10	27,9		
.687	17,5	<b>G1153</b>	RG 687-14-6	SBR	.44	11,1	.94	23,8	.44	11,1
.750	19,1	<b>G1172</b>	RG 750-10-6	SBR	.31	8,0	1.00	25,4		
.812	20,6	<b>G1194</b>	RG 812-16-6	SBR	.50	12,7	1.06	27,0		
		<b>G1199</b>	RG 812-18-6	SBR	.56	14,3	1.06	27,0		
.875	22,2	<b>G1213</b>	RG 875-18-6	SBR	.56	14,3	1.06	27,0	.44	11,1
		<b>G1219</b>	RG 875-20-6	SBR	.63	15,9	1.13	28,6		
1.000	25,4	<b>G1256</b>	RG 1000-22-6	SBR	.69	17,5	1.31	33,4	.50	12,7
		<b>G1261</b>	RG 1000-24-6	SBR	.75	19,1	1.25	31,8	.56	14,3
1.062	27,0	<b>G1272</b>	RG 1062-24-6	SBR	.75	19,1	1.38	34,9	.50	12,7
		<b>G1306</b>	RG 1250-28-6	SBR	.88	22,2	1.63	41,3	.56	14,3
1.250	31,8	<b>G1312</b>	RG 1250-32-6	SBR	1.00	25,4	1.50	38,1	.44	11,1
		<b>G1323</b>	RG 1375-32-6	SBR	1.00	25,4	1.75	44,5	.56	14,3
1.375	34,9	<b>G1329</b>	RG 1375-36-6	SBR	1.13	28,6	1.88	47,6	.50	12,7
		<b>G1351</b>	RG 1500-40-6	EPDM	1.25	31,8	2.00	50,8	.63	15,9
1.750	44,5	<b>G1372</b>	RG 1750-48-6	SBR	1.50	38,1	2.13	54,0	.56	14,3
2.000	50,8	<b>G1390</b>	RG 2000-52-6	SBR	1.63	41,3	2.25	57,2	.75	19,1
2.200	55,9	<b>G1404</b>	RG 2.200-64-6	SBR	2.00	50,8	2.75	69,9	.56	14,2
2.375	60,3	<b>G1414</b>	RG 2.375-64-6	PVC	2.00	50,8	2.75	69,9		

Standard color black.

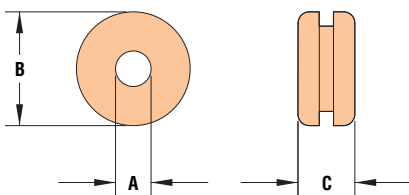

Quick Specs

Material  
Temperature Range

SBR, Nitrile, EPDM, or PVC  
-40°F (-40°C) to 221°F (105°C)

“Stay Connected” with



Bushings, Grommets, HEYcaps & Plugs

a PennEngineering® Company



## Heyco® Thick Panel Rubber Grommets

For Panels .250" (6,4 mm) to .375" (9,5 mm) Thick

MOUNTING HOLE DIAMETER		PART NO.	DESCRIPTION	MATERIAL	PART DIMENSIONS					
in.	mm.				A Inside Diameter		B Head Diameter		C Overall Height	
For .250" (6,4 mm) Thick Panels										
.312	7,9	<b>G1023</b>	RG 312-6-8	SBR	.19	4,8	.44	11,1	.38	9,5
.437	11,1	<b>G1058</b>	RG 437-8-8	Nitrile	.25	6,4	.63	15,9		
.500	12,7	<b>G1086</b>	RG 500-10-8	Nitrile	.31	8,0	.63	15,9	.63	15,9
		<b>G1095</b>	RG 500-12-8	SBR	.38	9,5	.75	19,1		
.562	14,3	<b>G1117</b>	RG 562-10-8	Nitrile	.31	8,0	.81	20,6	.50	12,7
.625	15,9	<b>G1134</b>	RG 625-12-8	SBR	.38	9,5	.88	22,2		
.687	17,5	<b>G1154</b>	RG 687-14-8	SBR	.44	11,1	.94	23,8		
.812	20,6	<b>G1195</b>	RG 812-16-8	SBR	.50	12,7	1.06	27,0		
.875	22,2	<b>G1200</b>	RG 812-18-8	SBR	.56	14,3	1.06	27,0	.56	14,3
		<b>G1220</b>	RG 875-20-8	SBR	.63	15,9				
1.000	25,4	<b>G1257</b>	RG 1000-22-8	SBR	.69	17,5	1.31	33,3	.63	15,9
		<b>G1264</b>	RG 1000-28-8	SBR	.88	22,2	1.25	31,8		
1.062	27,0	<b>G1273</b>	RG 1062-24-8	SBR	.75	19,1	1.38	34,9	.56	14,3
1.125	28,6	<b>G1279*</b>	RG 1125-26-8	SBR	.80	20,4	1.38	34,9		
1.250	31,8	<b>G1301</b>	RG 1250-24-8	SBR	.75	19,1	1.63	41,3	.44	11,1
		<b>G1307</b>	RG 1250-28-8	SBR	.88	22,2	1.63	41,3		
1.375	34,9	<b>G1324</b>	RG 1375-32-8	SBR	1.00	25,4	1.75	44,5	.63	15,9
1.500	38,1	<b>G1353</b>	RG 1500-40-8	SBR	1.25	31,8	1.75	44,5		
		<b>G1354</b>	RG 1500-40-8A	SBR	1.25	31,8	2.00	50,8		
1.750	44,5	<b>G1373</b>	RG 1750-48-8	SBR	1.50	38,1	2.00	50,8	.50	12,7
		<b>G1374</b>	RG 1750-48-8A	SBR	1.50	38,1	2.13	54,0		
2.000	50,8	<b>G1393</b>	RG 2000-56-8	SBR	1.75	44,5	2.50	63,5	.53	13,5
		<b>G1394</b>	RG 2000-56-8A	Nitrile	1.75	44,5	2.50	63,5		
2.500	63,5	<b>G1421</b>	RG 2.5-64-8	SBR	2.00	50,8	3.00	76,2	.56	14,3
		<b>G1425</b>	RG 2.5-72-8	SBR	2.25	57,2	3.00	76,2		

For .375" (9,5 mm) Thick Panels

.375	9,5	<b>G1043</b>	RG 375-10-12	SBR	.31	8,0	.56	14,3	.50	12,7
.500	12,7	<b>G1096</b>	RG 500-12-12	SBR	.38	9,5	.63	15,9		
.562	14,3	<b>G1121</b>	RG 562-12-12	SBR	.38	9,5	.75	19,1	.63	15,9
.625	15,9	<b>G1136</b>	RG 625-13-12	SBR	.41	10,3	.81	20,6		
.750	19,1	<b>G1182</b>	RG 750-16-12	SBR	.50	12,7	1.00	25,4		
.875	22,2	<b>G1214</b>	RG 875-18-12	SBR	.56	14,3	1.06	27,0		
.968	24,6	<b>G1232</b>	RG 968-22-12	SBR	.69	17,4	1.31	33,3	.63	15,9
1.000	25,4	<b>G1249</b>	RG 1000-18-12	SBR	.56	14,3	1.25	31,8		
1.125	28,6	<b>G1278</b>	RG 1125-24-12	SBR	.75	19,1	1.63	41,3	1.13	28,6
1.250	31,8	<b>G1308</b>	RG 1250-28-12	Neoprene	.88	22,2	1.75	44,5		
		<b>G1314</b>	RG 1250-32-12	SBR	1.00	25,4	1.50	38,1		
1.375	34,9	<b>G1326</b>	RG 1375-32-12	SBR	1.00	25,4	1.75	44,5	.75	19,1
1.750	44,5	<b>G1375</b>	RG 1750-48-12	SBR	1.50	38,1	2.13	54,0		
2.000	50,8	<b>G1395</b>	RG 2000-56-12	SBR	1.75	44,5	2.50	63,5	.63	15,9
2.500	63,5	<b>G1427</b>	RG 2.5-72-12	SBR	2.25	57,2	3.00	76,2		

Standard color black. \*G1279 Panel Thickness is .257" (6,5 mm)

- **Used to protect through holes.** Help eliminate sharp edges so your wires are protected and add aesthetic value to your application.
- 40 sizes available that accommodate mounting holes ranging from .312" (7,9 mm) to holes as large as 2.50" (63,5 mm) in diameter and panel thicknesses of .250" (6,4 mm) and .375" (9,5 mm).
- Rubber grommets are constructed of SBR (unless otherwise noted) with an operating temperature range of -40°F (-40°C) to 221°F (105°C).
- SBR grommets have good water resistant characteristics and are suitable for most moderate chemicals and wet or dry organic acids.
- Provide vibration dampening.

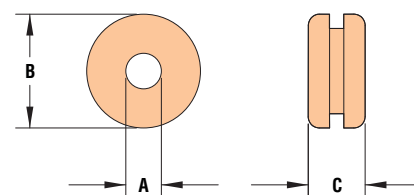

Material: SBR, Nitrile or Neoprene  
 Temperature Range: -40°F (-40°C) to 221°F (105°C)

Quick Specs