

## Hook clamps

Steel or stainless steel

### STANDARD EXECUTIONS

- **TLG.Z:** zinc-plated steel.
- **TLG.SST:** AISI 304 stainless steel.

### SPECIAL EXECUTIONS ON REQUEST

- Hook clamps in unplated steel or nickel-plated steel.
- Catch brackets in different shapes and finishes.

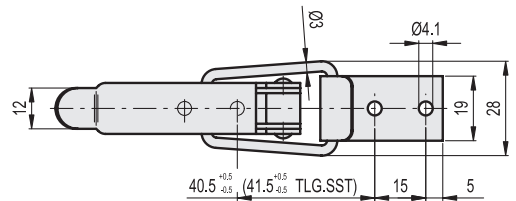
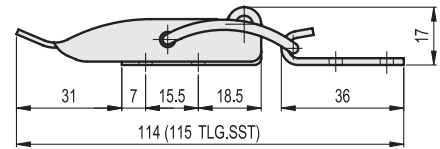

### TLG.Z

Code	Description	Max. working load [N]	Load at breakage [N]	59
420111	TLG.Z-12/114+R	1000	2500	59

### TLG.SST

**STAINLESS STEEL**

Code	Description	Max. working load [N]	Load at breakage [N]	59
420112	TLG.SST-12/114+R	1000	2500	59