

Hook clamps

Steel or stainless steel

STANDARD EXECUTIONS

- **TLA.Z**: lever body and bracket in zinc-plated steel.
- **TLA.SST**: lever body and bracket in AISI 304 stainless steel.

SPECIAL EXECUTIONS ON REQUEST

- Hook clamps in unplated steel.
- Catch brackets in different shapes and finishes.

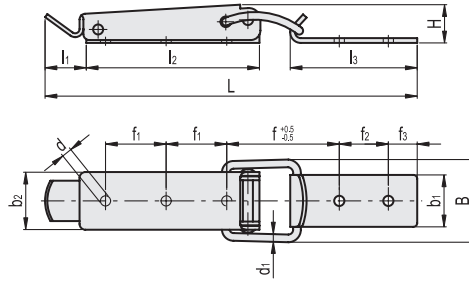

TLA.Z

Code	Description	b ₂	L	B	H	d	d ₁	b ₁	l ₁	l ₂	l ₃	f	f ₁	f ₂	f ₃	Max. working load [N]	Load at breakage [N]	⚖️
420081	TLA.Z-16.4/102+R	16.4	102	23	11	3.2	2	13	16	44	30	34.5	12.5	12	5	550	1200	31
420061	TLA.Z-23/140.5+R	23	140.5	34	12.5	4.1	3	19	16	70	43	38	22.5	20	8	1500	3000	78
420051	TLA.Z-30/193.5+R	30	193.5	43	19	5.3	4	27	21.5	90	66	58.5	31.5	25.5	15	2000	4000	188

TLA.SST

STAINLESS STEEL

Code	Description	b ₂	L	B	H	d	d ₁	b ₁	l ₁	l ₂	l ₃	f	f ₁	f ₂	f ₃	Max. working load [N]	Load at breakage [N]	⚖️
420082	TLA.SST-16.4/102+R	16.4	102	23	11	3.2	2	13	16	44	30	34.5	12.5	12	5	550	1200	31
420062	TLA.SST-23/140.5+R	23	140.5	34	12.5	4.1	3	19	16	70	43	38	22.5	20	8	1500	3000	78
420052	TLA.SST-30/193.5+R	30	193.5	43	19	5.3	4	27	21.5	90	66	58.5	31.5	25.5	15	2000	4000	188