

MSR.

Connecting clamps



FM Design



Code	Description	caps for
440011-*	CC-MSR.60-*	MSR.60-B

* Complete with colour index (C9, C2,.....,C6).

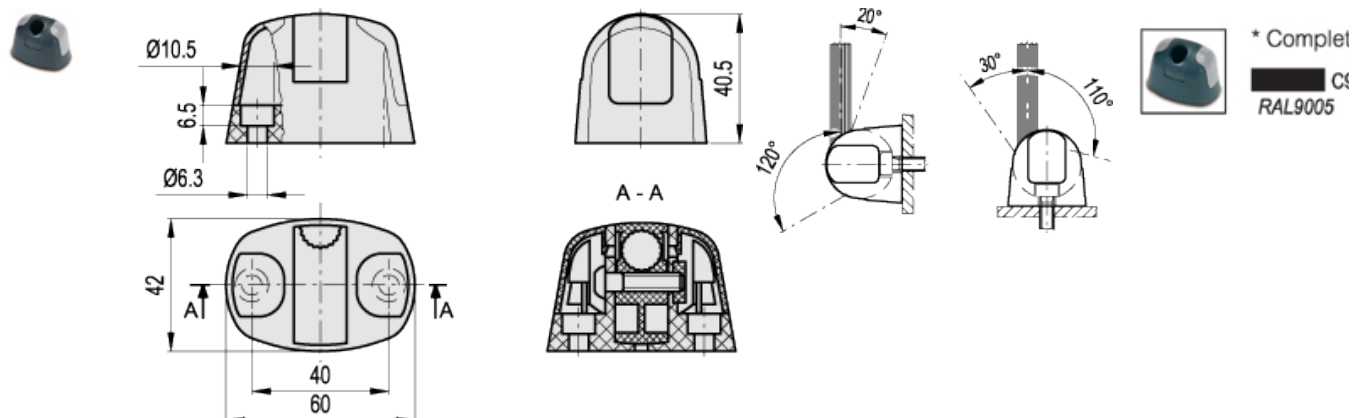

Elesa Standards		Pull out resistance	Weight
Code	Description	[N]	g
440001-*	MSR.60-B-*	300	50

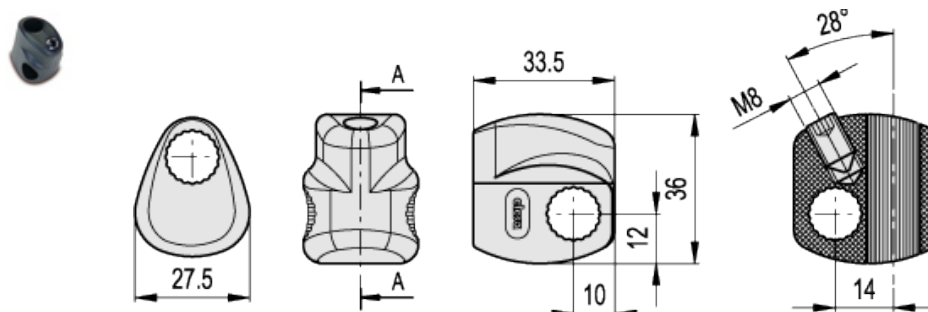

Elesa Standards		Pull out resistance	Weight
Code	Description	[N]	g
440021	MSR.60-C	300	19

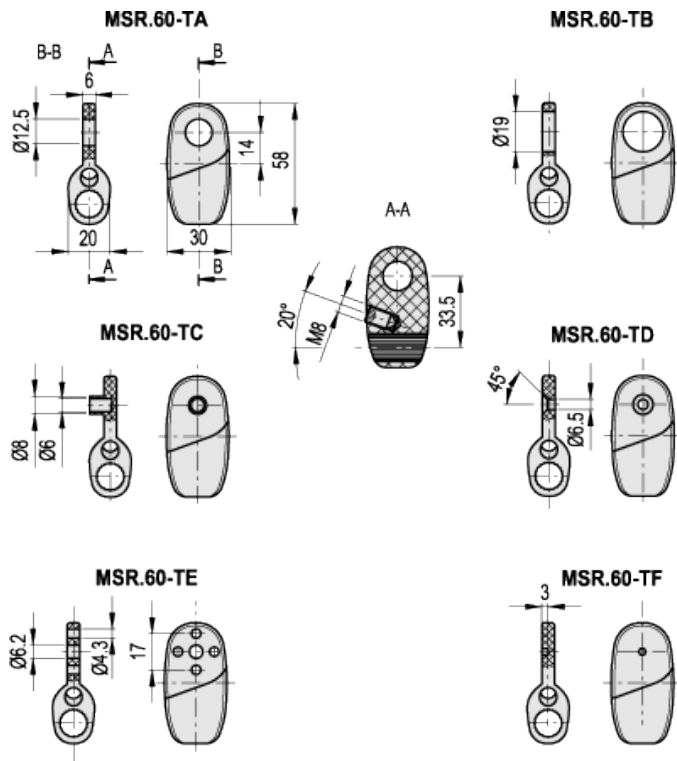

MSR.60-TA÷TF

Elesa Standards		Pull out resistance	Weight
Code	Description	[N]	g
440031	MSR.60-TA	300	18
440032	MSR.60-TB	300	17
440033	MSR.60-TC	300	19
440034	MSR.60-TD	300	18
440035	MSR.60-TE	300	18
440036	MSR.60-TF	300	20

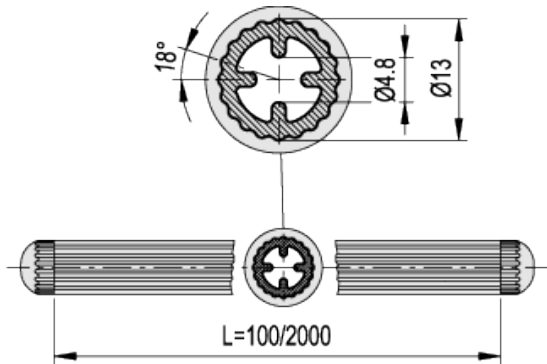

MSR.60-T13

Elesa Standards		Weight
Code	Description	g
440050	MSR.60-T13-100	20
440055	MSR.60-T13-150	28
440060	MSR.60-T13-200	36
440065	MSR.60-T13-250	44
440070	MSR.60-T13-300	52
440200*	MSR.60-T13-2000*	320

* Supplied without closing caps.

glass-fibre reinforced polyamide based (PA) technopolymer, black colour, matte finish.

- CC-MSR.60 screw covers:

technopolymer in six colours, glossy finish.

Supplied, push-fit assembly, removable by a screwdriver.

Available also as accessories sold separately (see table).

- MSR.60-C T-shaped clamp:

glass-fibre reinforced technopolymer, black colour, matte finish.

- MSR.60-TA-TB-TC-TD-TE-TF device clamps:

glass-fibre reinforced technopolymer, black colour, matte finish.

- MSR.60-T13 connecting tubes:

aluminium profile available with standard lengths from 100 to 2000 mm. On request and for sufficient quantities other lengths are available.

- Connecting tube closing caps:

glass-fibre reinforced technopolymer, black colour, matte finish.

Supplied, push-fit assembly.

To be ordered also separately (code 440016 description TC13-MSR.60).



Features and applications

MSR. connecting clamps, designed according to ELESA patent, allow an easy and efficient connection between the components, preventing the risk of rotating freely.

The system allows the axial, perpendicular or angled positioning of the connecting tube to the base.

Advantages

- The slot-shaped connecting tube preventing free rotation.
- Tube and components clamped by the aid of only one screw.
- Easy adjustments by five degrees of freedom of the clamped devices (see drawing).
- Lack of cavities to avoid the deposit of dirt and undesired substances.
- Easy identification of the clamped device using different coloured caps on the base.

5 degrees of freedom

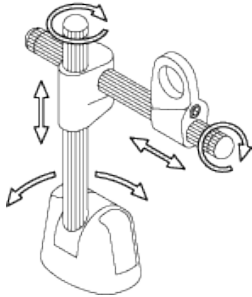

Assembly instructions

1 - Assemble the base by means of 2 M6 cylindrical head screws with hexagon socket (not supplied).

2 - Fit one of the closing caps to the end of the connecting tube by tapping gently with a plastic mallet until firmly in place. Be careful not to assemble the cap to the end fitted to the base.

3 - Insert the connecting tube in the shaped hole of the base and clamp it by screwing the set screw. Suggested tightening torque 5 Nm.

4 - Insert the t-shaped clamp which allows the assembly of another connecting tube.

5 - Fit the closing caps to the connecting tube.

6 - Insert the connecting tube in the shaped hole of the t-shaped clamp.

7 - Fit on the connecting tube the proper device clamp, chosen within the six available. After the positioning of the components, clamp them by screwing the set screws. Suggested tightening torque 3 Nm. We recommend not to exceed this value

8 - Once the adjustment has been set, fit the screw covers on the base.

Assembly instructions

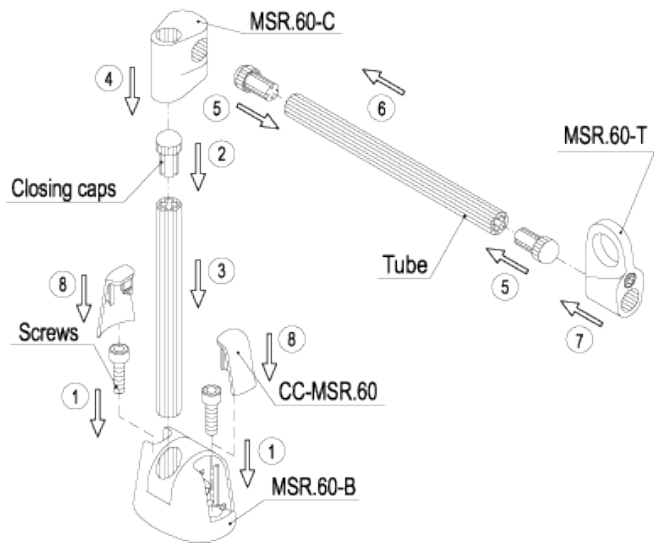

STANDARD MACHINE ELEMENTS WORLDWIDE

ELESA models all rights reserved in accordance with the law. Always mention the source when reproducing our drawings.