

S.N

Spherical knobs

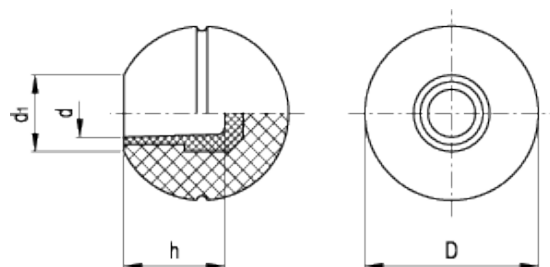

technical informations

Material

Phenolic based (PF) Duroplast. Resistant to solvents, oils, greases and other chemical agents.

Colour

Black, glossy finish with equatorial groove.

Assembly

Glass-fibre reinforced polyamide based (PA) technopolymer self-locking boss, plain blind hole.

The elastic coupling by press-fit assembly on h9 tolerance drawn stock bars, is not affected by vibrations and prevents the handle from slipping off (see [Technical Data](#)).

Assembly instructions

Fit the handle onto slight chamfered shaft end and push as far as possible by hand or by means of a small press. Alternatively it is possible to tap the handle with a plastic or wooden mallet until firmly in place. In this case we strongly recommend to use a cloth or other suitable soft material over the product to avoid any surface damage.

Standard Elements		Main dimensions		Mounting hole		Weight
Code	Description	D	d ₁	d	h	g
52001	S.20 N-6	20	7	6	13	5
52101	S.25 N-6	25	10	6	13	12
52111	S.25 N-8	25	10	8	14	10
52201	S.30 N-8	30	15	8	14	17
52211	S.30 N-10	30	15	10	18	16
52301	S.35 N-8	35	15	8	14	29
52311	S.35 N-10	35	15	10	18	26
52401	S.40 N-10	40	15	10	18	40
52411	S.40 N-12	40	15	12	21	40
52501	S.45 N-12	45	21	12	21	57
52511	S.45 N-14	45	21	14	24	56
52601	S.50 N-12	50	21	12	21	80
52611	S.50 N-14	50	21	14	24	76
52621	S.50 N-16	50	21	16	28	74



ELESA and GANTER models all rights reserved in accordance with the law. Always mention the source when reproducing our drawings.

STANDARD MACHINE ELEMENTS WORLDWIDE